

Project Title : PROPOSED LAYOUT IN SY. NOS.3/27P,29P, 5/P,7P,8P,12P, 15/P,3P,4P,6,7,8,9,10P,11P,12P, 7/1P,2,3P,4,5,6,7,8P,9,10,11P,12,13,14,15,16,17,18,19, 20,21P,2,3,4,5,25,26,27 & 9/6P OF MAJUVILASA VILLAGE, BHEEMUNIPATNAM MANDAL, VISAKHAPATNAM DISTRICT, Bhattarangi M.V. SUBHAGRHA INFRASTRUCTURES PVT. LTD.

PROPOSED LAYOUT IN SY. NOS.3/27P,29P, 5/P,7P,8P,12P, 15/P,3P,4P,6,7,8,9,10P,11P,12P, 7/1P,2,3P,4,5,6,7,8P,9,10,11P,12,13,14,15,16,17,18,19, 20,21P,2,3,4,5,25,26,27 & 9/6P OF MAJUVILASA VILLAGE, BHEEMUNIPATNAM MANDAL, VISAKHAPATNAM DISTRICT, Bhattarangi M.V. SUBHAGRHA INFRASTRUCTURES PVT. LTD.

PROPOSED LAYOUT IN SY. NOS.3/27P,29P, 5/P,7P,8P,12P, 15/P,3P,4P,6,7,8,9,10P,11P,12P, 7/1P,2,3P,4,5,6,7,8P,9,10,11P,12,13,14,15,16,17,18,19, 20,21P,2,3,4,5,25,26,27 & 9/6P OF MAJUVILASA VILLAGE, BHEEMUNIPATNAM MANDAL, VISAKHAPATNAM DISTRICT, Bhattarangi M.V. SUBHAGRHA INFRASTRUCTURES PVT. LTD.



LAYOUT PLAN  
(Scale - 1:800)

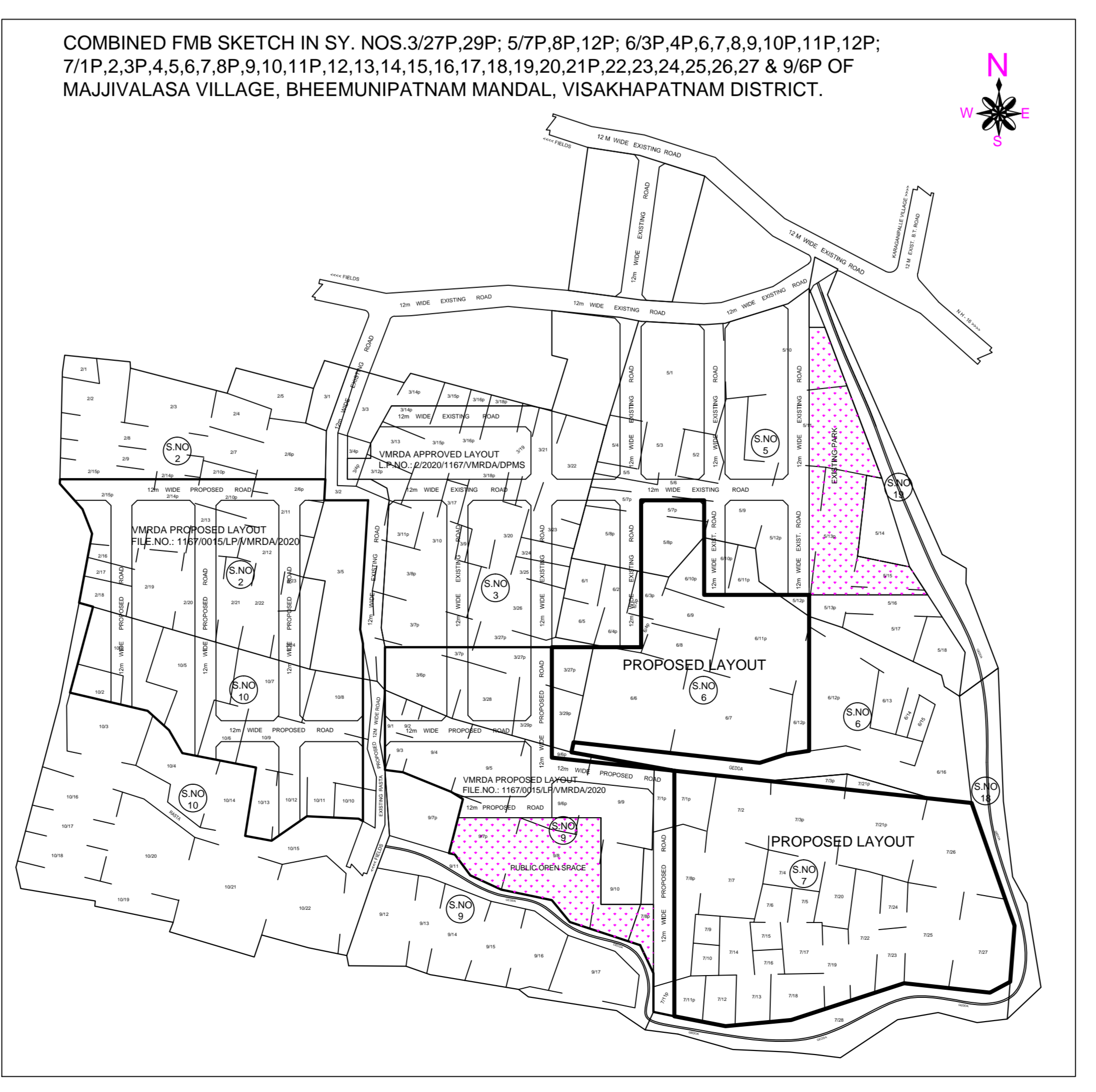
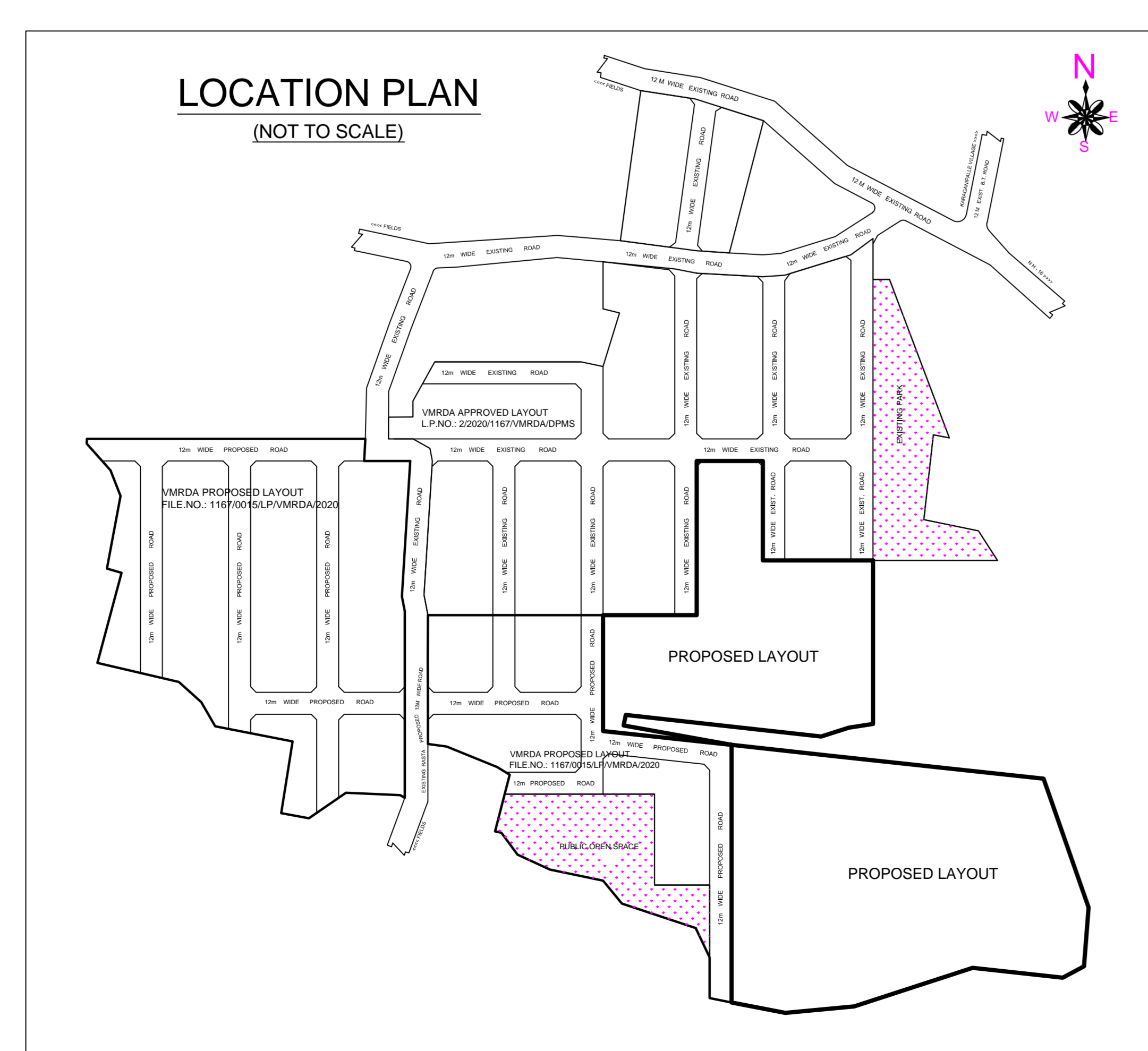

Sl. No.	Plot No.	Area (Sq. Mts)	Proposed Area (Sq. Mts)	Area (Sq. Mts)	Area (Sq. Mts)	Area (Sq. Mts)	
1	1	1800	1800	8.00	9.14	-	18.14
2	2	1800	1800	8.00	9.14	-	18.14
3	3	1800	1800	8.00	9.14	-	18.14
4	4	1800	1800	8.00	9.14	-	18.14
5	5	1800	1800	8.00	9.14	-	18.14
6	6	1800	1800	8.00	9.14	-	18.14
7	7	1800	1800	8.00	9.14	-	18.14
8	8	1800	1800	8.00	9.14	-	18.14
9	9	1800	1800	8.00	9.14	-	18.14
10	10	1800	1800	8.00	9.14	-	18.14
11	11	1800	1800	8.00	9.14	-	18.14
12	12	1800	1800	8.00	9.14	-	18.14
13	13	1800	1800	8.00	9.14	-	18.14
14	14	1800	1800	8.00	9.14	-	18.14
15	15	1800	1800	8.00	9.14	-	18.14
16	16	1800	1800	8.00	9.14	-	18.14
17	17	1800	1800	8.00	9.14	-	18.14
18	18	1800	1800	8.00	9.14	-	18.14
19	19	1800	1800	8.00	9.14	-	18.14
20	20	1800	1800	8.00	9.14	-	18.14
21	21	1800	1800	8.00	9.14	-	18.14
22	22	1800	1800	8.00	9.14	-	18.14
23	23	1800	1800	8.00	9.14	-	18.14
24	24	1800	1800	8.00	9.14	-	18.14
25	25	1800	1800	8.00	9.14	-	18.14
26	26	1800	1800	8.00	9.14	-	18.14
27	27	1800	1800	8.00	9.14	-	18.14
28	28	1800	1800	8.00	9.14	-	18.14
29	29	1800	1800	8.00	9.14	-	18.14
30	30	1800	1800	8.00	9.14	-	18.14
31	31	1800	1800	8.00	9.14	-	18.14
32	32	1800	1800	8.00	9.14	-	18.14
33	33	1800	1800	8.00	9.14	-	18.14
34	34	1800	1800	8.00	9.14	-	18.14
35	35	1800	1800	8.00	9.14	-	18.14
36	36	1800	1800	8.00	9.14	-	18.14
37	37	1800	1800	8.00	9.14	-	18.14
38	38	1800	1800	8.00	9.14	-	18.14
39	39	1800	1800	8.00	9.14	-	18.14
40	40	1800	1800	8.00	9.14	-	18.14
41	41	1800	1800	8.00	9.14	-	18.14
42	42	1800	1800	8.00	9.14	-	18.14
43	43	1800	1800	8.00	9.14	-	18.14
44	44	1800	1800	8.00	9.14	-	18.14
45	45	1800	1800	8.00	9.14	-	18.14
46	46	1800	1800	8.00	9.14	-	18.14
47	47	1800	1800	8.00	9.14	-	18.14
48	48	1800	1800	8.00	9.14	-	18.14
49	49	1800	1800	8.00	9.14	-	18.14
50	50	1800	1800	8.00	9.14	-	18.14
51	51	1800	1800	8.00	9.14	-	18.14
52	52	1800	1800	8.00	9.14	-	18.14
53	53	1800	1800	8.00	9.14	-	18.14
54	54	1800	1800	8.00	9.14	-	18.14
55	55	1800	1800	8.00	9.14	-	18.14
56	56	1800	1800	8.00	9.14	-	18.14
57	57	1800	1800	8.00	9.14	-	18.14
58	58	1800	1800	8.00	9.14	-	18.14
59	59	1800	1800	8.00	9.14	-	18.14
60	60	1800	1800	8.00	9.14	-	18.14
61	61	1800	1800	8.00	9.14	-	18.14
62	62	1800	1800	8.00	9.14	-	18.14
63	63	1800	1800	8.00	9.14	-	18.14
64	64	1800	1800	8.00	9.14	-	18.14
65	65	1800	1800	8.00	9.14	-	18.14
66	66	1800	1800	8.00	9.14	-	18.14
67	67	1800	1800	8.00	9.14	-	18.14
68	68	1800	1800	8.00	9.14	-	18.14
69	69	1800	1800	8.00	9.14	-	18.14
70	70	1800	1800	8.00	9.14	-	18.14
71	71	1800	1800	8.00	9.14	-	18.14
72	72	1800	1800	8.00	9.14	-	18.14
73	73	1800	1800	8.00	9.14	-	18.14
74	74	1800	1800	8.00	9.14	-	18.14
75	75	1800	1800	8.00	9.14	-	18.14
76	76	1800	1800	8.00	9.14	-	18.14
77	77	1800	1800	8.00	9.14	-	18.14
78	78	1800	1800	8.00	9.14	-	18.14
79	79	1800	1800	8.00	9.14	-	18.14
80	80	1800	1800	8.00	9.14	-	18.14
81	81	1800	1800	8.00	9.14	-	18.14
82	82	1800	1800	8.00	9.14	-	18.14
83	83	1800	1800	8.00	9.14	-	18.14
84	84	1800	1800	8.00	9.14	-	18.14
85	85	1800	1800	8.00	9.14	-	18.14
86	86	1800	1800	8.00	9.14	-	18.14
87	87	1800	1800	8.00	9.14	-	18.14
88	88	1800	1800	8.00	9.14	-	18.14
89	89	1800	1800	8.00	9.14	-	18.14
90	90	1800	1800	8.00	9.14	-	18.14
91	91	1800	1800	8.00	9.14	-	18.14
92	92	1800	1800	8.00	9.14	-	18.14
93	93	1800	1800	8.00	9.14	-	18.14
94	94	1800	1800	8.00	9.14	-	18.14
95	95	1800	1800	8.00	9.14	-	18.14
96	96	1800	1800	8.00	9.14	-	18.14
97	97	1800	1800	8.00	9.14	-	18.14
98	98	1800	1800	8.00	9.14	-	18.14
99	99	1800	1800	8.00	9.14	-	18.14
100	100	1800	1800	8.00	9.14	-	18.14
101	101	1800	1800	8.00	9.14	-	18.14
102	102	1800	1800	8.00	9.14	-	18.14
103	103	1800	1800	8.00	9.14	-	18.14
104	104	1800	1800	8.00	9.14	-	18.14
105	105	1800	1800	8.00	9.14	-	18.14
106	106	1800	1800	8.00	9.14	-	18.14
107	107	1800	1800	8.00	9.14	-	18.14
108	108	1800	1800	8.00	9.14	-	18.14
109	109	1800	1800	8.00	9.14	-	18.14
110	110	1800	1800	8.00	9.14	-	18.14
111	111	1800	1800	8.00	9.14	-	18.14
112	112	1800	1800	8.00	9.14	-	18.14
113	113	1800	1800	8.00	9.14	-	18.14
114	114	1800	1800	8.00	9.14	-	18.14
115	115	1800	1800	8.00	9.14	-	18.14

Land use analysis/area distribution (Table 2c)

Area covered under	Proposed Area (Sq. Mts)	Proposed Area (%)	Percentage (%)
Residential	3806.93	100.00	100.00
Public Open Space	0.00	0.00	0.00
Other	0.00	0.00	0.00
Total	3806.93	100.00	100.00

Mortgage Area Details

Name	Area (Sq. Mts)	Prop. (%)
Land Area to Mortgage	3806.93	100.00

Land Area to Mortgage Details

Name	Ind. Plot Name	Ind. Plot Area
MORTGAGE PLOTS	101	18.14
MORTGAGE PLOTS	102	18.14
MORTGAGE PLOTS	103	18.14
MORTGAGE PLOTS	104	18.14
MORTGAGE PLOTS	105	18.14
MORTGAGE PLOTS	106	18.14
MORTGAGE PLOTS	107	18.14
MORTGAGE PLOTS	108	18.14
MORTGAGE PLOTS	109	18.14
MORTGAGE PLOTS	110	18.14
MORTGAGE PLOTS	111	18.14
MORTGAGE PLOTS	112	18.14
MORTGAGE PLOTS	113	18.14
MORTGAGE PLOTS	114	18.14
MORTGAGE PLOTS	115	18.14
Total		3806.93

General Conditions

1. The FMB is responsible for any transgression or other conditions.

2. The FMB is responsible for any transgression or other conditions.

Sy No.	Applied Extent Sq - Mts
3-27P	728.46
3-29P	526.11
5-7P	445.17
5-8P	1558.10
5-12P	607.71
6-3P	263.06
6-4P	80.94
6-6	2994.78
6-7	3035.25
6-8	728.46
6-9	728.46
6-10P	647.52
6-11P	2711.49
6-12P	593.89
7-1P	728.46
7-2	1214.10
7-3P	1659.27
7-4	728.46
7-5	323.76
7-6	404.70
7-7	1618.80
7-8P	445.17
7-9	242.82
7-10	323.76
7-11P	404.70
7-12	566.58
7-13	566.58
7-14	607.05
7-15	242.82
7-16	283.29
7-17	647.52
7-18	728.46
7-19	607.05
7-20	728.46
7-21P	2124.61
7-22	1052.22
7-23	607.05
7-24	485.64
7-25	1699.74
7-26	1983.03
7-27	1821.15
9-6P	121.41
<b>TOTAL</b>	<b>38069.13</b>

COLOR INDEX

Plot Area	Green
Proposed work including services	Yellow
Existing structure to be demolished	Red
Existing structure to be retained	Blue
Plot to progress in development	Pink
Open Space	White
Demolish and Reconstruct work	Orange
Road Supply work	Grey
Demolish	Black
Retention ground	Light Green