

← TO ANANDAPURAM.

200'-0" WIDE ROAD

→ TO PENDURTI

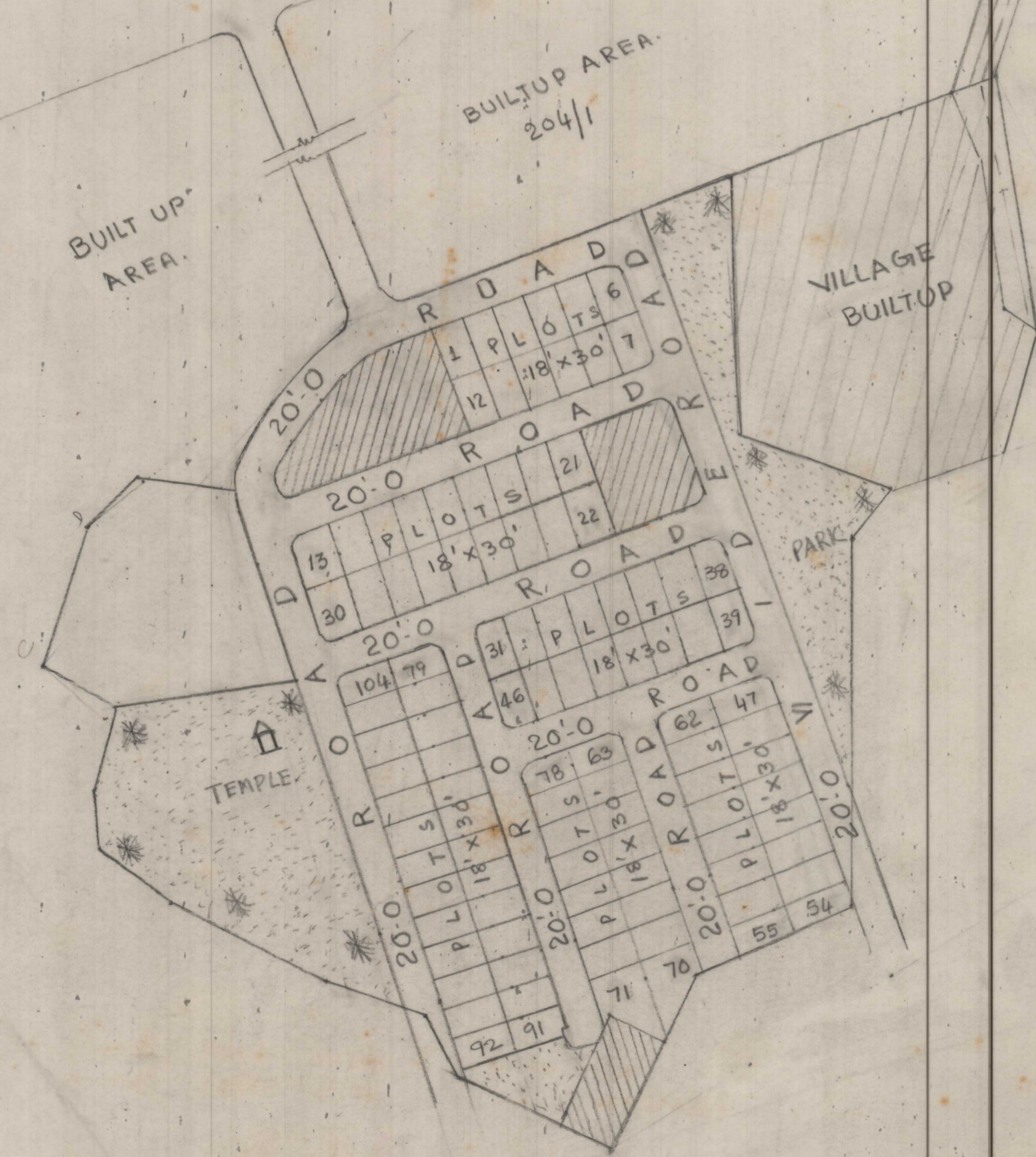

PROPOSED E.V.S. LAY-OUT IN S.NO 202/2 OF GANDI GUNDAM (V) ANANDAPURAM MANDAL VISAKHAPATNAM

LAND USE ANALYSIS :-

SNO	DESCRIPTION	EXTENT IN ACS	PERCENTAGE
1	PLOT AREA	1.29	35.8%
2	ROADS AREA	0.92	25.5%
3	OPEN SPACE AREA	0.39	10.8%
4	BUILT UP AREA	1.00	27.7%
TOTAL ACS.		3.60	100.0%

□ LAY-OUT BOUNDARY

SNO	SIZE OF PLOT	NO. OF PLOTS
1	18'-0" x 30'-0"	104

NOTE: FOR ALL ROADS 5'0" B.L

DRAWN BY: *[Signature]* T.P.S. 2.11.90
 SCALE: 1 INCH = 66 FEET
 FILE PC NO. 1968/909
 LP NO. 85/90

[Signature] 02.11.90
 JUNIOR PLANNING OFFICER
 CHIEF PLANNING OFFICER
[Signature] 2/11/90
 ASST. PLANNING OFFICER
 VICE-CHAIRMAN

VISAKHAPATNAM URBAN DEVELOPMENT AUTHORITY