

AREA STATEMENT

Survey NO./ Sub Division	Applied extent for layout (Ac.Cts)
21/3/p	0-09
21/4/p	0-31
21/5/p	0-20
21/3/p	0-11
21/4/p	0-13
21/5/p	0-17
21/1/p	0-48
21/2/p	0-14½
21/5/p	0-54½
16/1/p	0-73
21/2/p	0-29½
21/3/p	0-16
21/5/p	0-33½
18/7/p	0-43
18/7/p	0-47
16/1/p	0-73
45/p	0-28
TOTAL Ac 5.61 Ct	

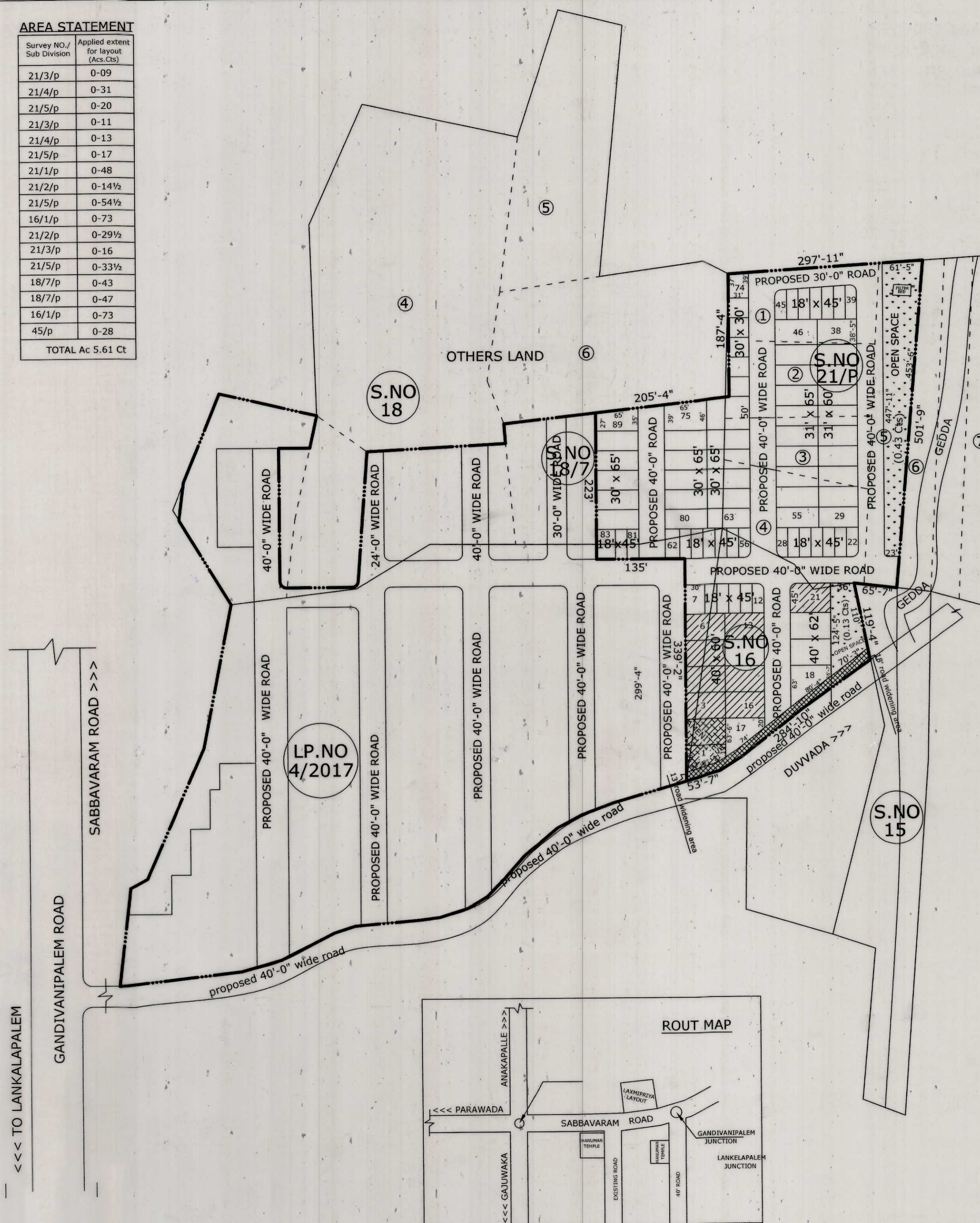

PROPOSED LAYOUT PLAN FOR RESIDENTIAL PLOTS S.Nos: 16/p,18/7p, 21/p & 45/p OF PEDDAMUSIDIWADA VILLAGE,PARAVADA MANDAL, VISAKHAPATNAM-DIST.

LAND BELONGS TO
 1.P.UDAY BHASKAR REDDY
 2.P.RAMADEVI

LAND USE ANALYSIS :-

S.NO.	DESCRIPTION	EXTENT (Ac.-cts.)	PERCENTAGE
1.	PLOTTED AREA (INCLUDING 3% AMENITIES)	3.20 } 0.10 }	58.81 %
2.	ROADS AREA	1.75	31.19 %
3.	OPEN SPACE	0.56	10.00 %
TOTAL AREA		5.61	100.00 %

SL.NO.	PLOT SIZE	PLOT AREA IN Sq Yds	NO OF PLOTS
1	30' X 55'	183.33	06
2	45' X 62'	310.00	01
3	40' X 62'	275.55	02
4	40' X 60'	266.66	09
5	39' X 30'	130.00	01
6	31' X 65'	223.89	10
7	31' X 60'	206.66	10
8	30' X 65'	216.66	12
9	30' X 45'	150.00	01
10	30' X 30'	100.00	05
11	18' X 45'	90.00	29
12	ODD PLOTS		03
TOTAL NO. OF PLOTS			89

— PROPOSED LAYOUT BOUNDARY.

FILE RC NO:- 6026/2014 SCALE : 1" = 132'-0"
 LP NO: 81/2018

PLOTS MORTGAGED TO VUDA PLOT NOS:
 3 TO 6,13 TO 16 & 21
 TOTAL PLOTS MORTGAGED = 09
 EXTENT : AC 0-50 CTS
 AMENITIES : 1 & 2 PLOTS

1) P. Uday Bhaskar Reddy
 2) P. Rama Devi

S. Gopala Rao
 LICENCED CIVIL ENGINEER/SURVEYOR
 Regd.No: 394/2018
 Visakhapatnam Urban Development Authority
 VISAKHAPATNAM

OWNERS SIGN. LICENCED SURVEYOR

K.V. J. Rawar
 S/D'Man 11/7/18

Deba
 11/7/18

CHEIF URBAN PLANNER

A.P.O
 11/7/18

Baran
 11/7/18

VICE CHAIRMAN

VISAKHAPATNAM URBAN DEVELOPMENT AUTHORITY