

PROPOSED LAY OUT OF
 G. MALLAYA & OTHERS IN
 S.NOS 101/P, 102/P OF PENDURTHI (W)
 VISAKHAPATNAM (DT)

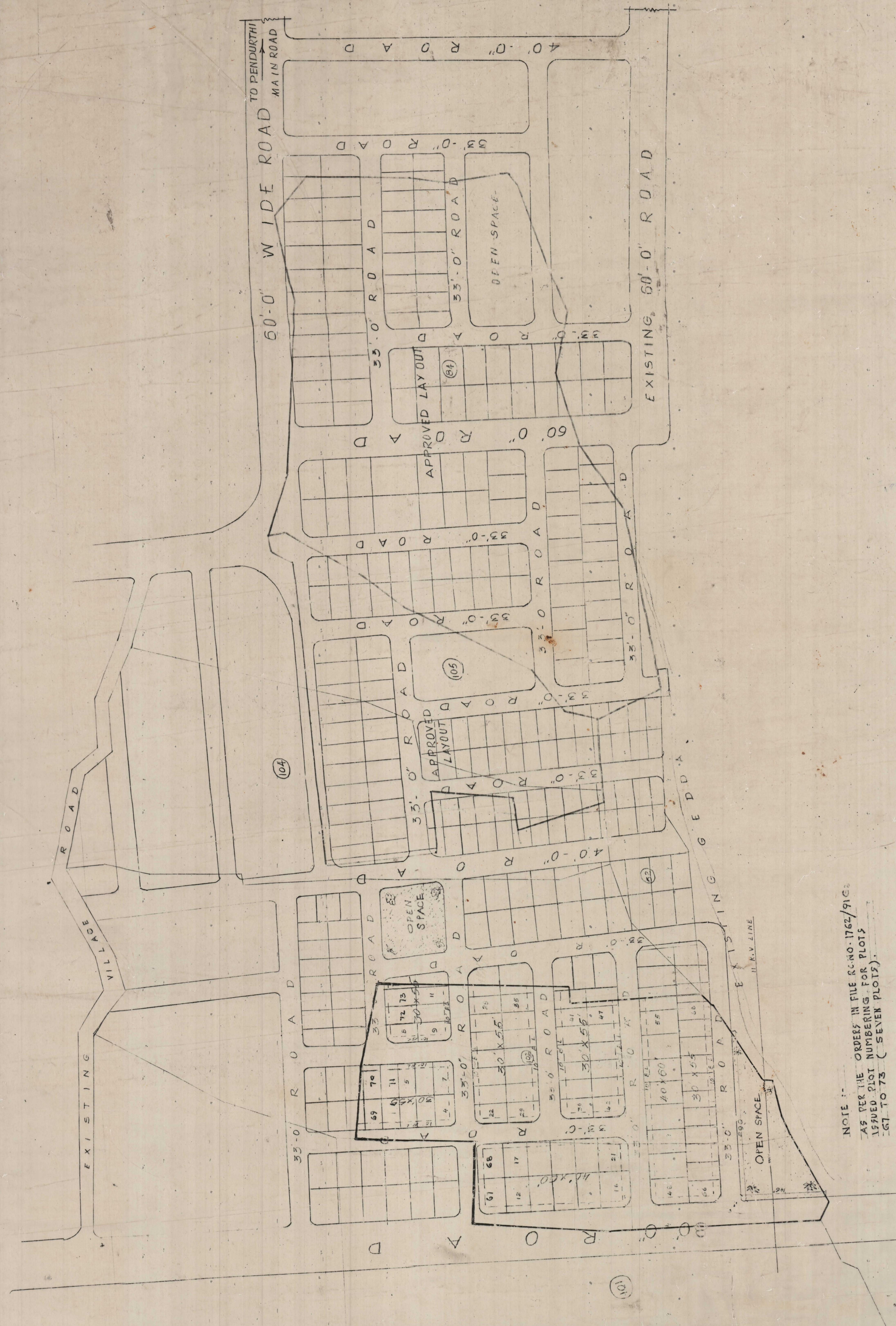

LAND USE ANALYSIS

S.L.NO	DESCRIPTION	EXTENT	PERCENTAGE
1	FLOTTED AREA	2.94	57.65
2	ROADS AREA	1.65	32.35
3	OPEN SPACE AREA	0.51	10.00
TOTAL		5.10	100.00

LAY OUT BOUNDARY

SIZE OF PLOTS	NO. OF PLOTS
40'-0" X 60'-0"	13
30'-0" X 55'-0"	48
TOTAL	65

SCALE 1" = 66' 0"
 FILE RC NO. 1804/82
 L.P. NO. 78/88
 (B.P. NO. 17/88)

Ch. Sankararaman
 A.D.M. 2.6.88

L. S. Sankararaman
 JUNIOR PLANNING OFFICER

CHIEF TOWN PLANNER
 PROVER. DIRECTOR U.A.

L. S. Sankararaman
 ASST. TOWN PLANNER

VICE CHAIRMAN

VISAKHAPATNAM URBAN
 DEVELOPMENT AUTHORITY

NOTE :-
 AS PER THE ORDERS IN FILE RC NO. 1762/91C
 ISSUED PLOT NUMBERING FOR PLOTS
 67 TO 73 (SEVEN PLOTS).

ADN. 1/10/81
 J.P.O.
 CHIEF PLANNING OFFICER

RAILWAY STATION & RAILWAY LINE