

GATEWAY

GATEWAY

GATEWAY

TOPINA GADI

TO VEPA GUNTA

100'-0"

W I D E R O A D

PROPOSED E.V.S. LAY-OUT
S.NO 224/3, 239/1, & 244.0
PINA GADI VILLAGE O
PENDURTHI MANDAL -
VISAKHAPATNAM-D

LAND USE ANALYSIS :-

SNO	DESCRIPTION	AREA IN ACS.	PERCENT
1	PLOTTED AREA	3.21	61.02
2	ROADS AREA	1.44	27.38
3	OPEN SPACE AREA	0.61	11.60
TOTAL EXTENT IN ACS.		5.26	100-

LAY-OUT BODNDARY

SIZE OF PLOTS - 30'-0" x 40'-0"
TOTAL NO. OF PLOTS - 114 NOS

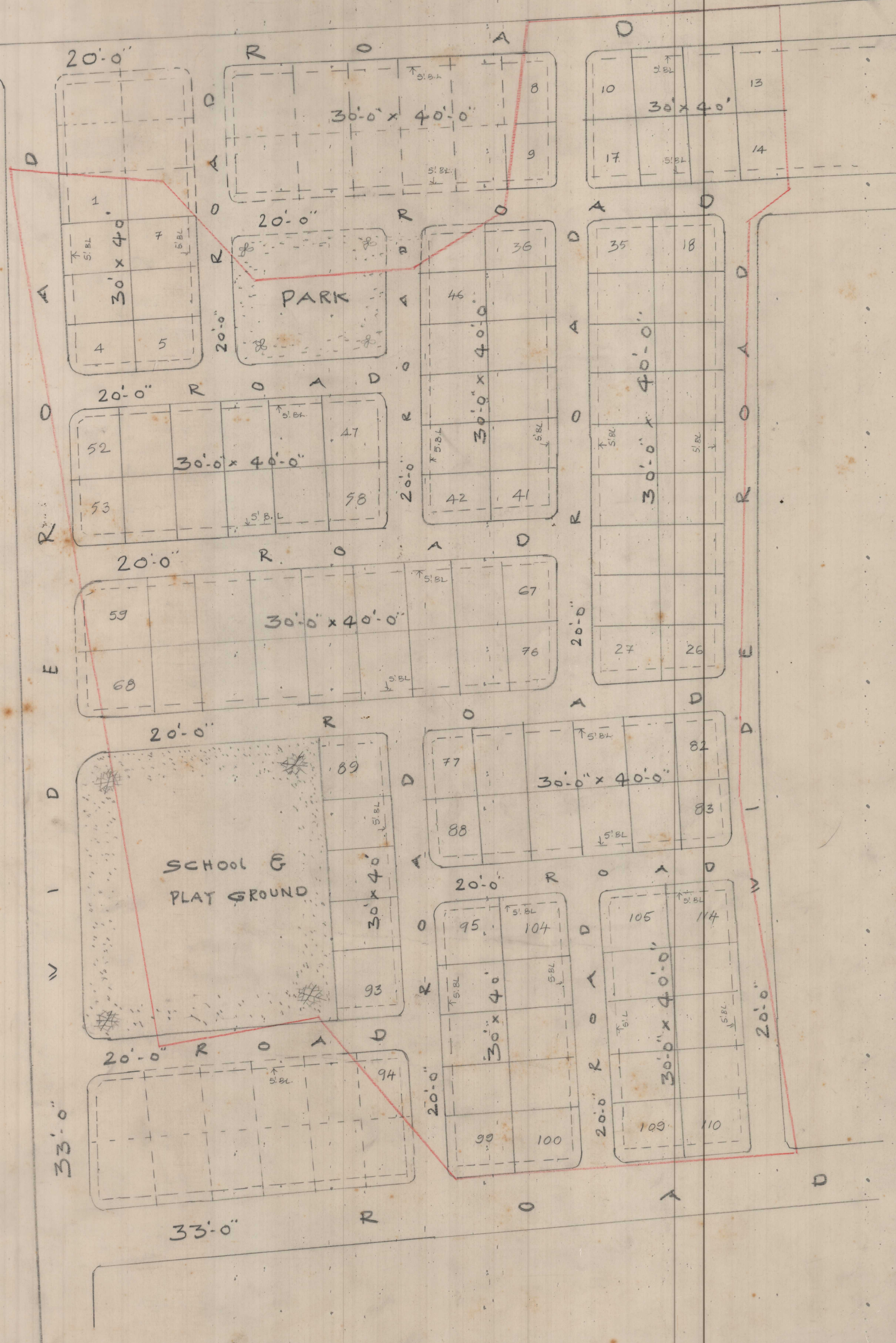

22/1/90
22/1/90

SCALE : 1 INCH = 33 FEET

FILE RC. NO: 73/90 G4

L.P. NO: 7/90

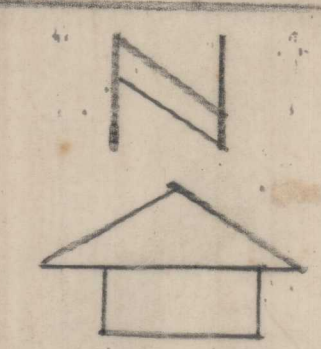

[Signature]
T.P.S.

[Signature]
CHIEF PLANNING OFFICER

[Signature]
22.01.90
JUNIOR PLANNING OFFICER

[Signature]
22.1.90
ASST. PLANNING OFFICER

[Signature]
VICE-CHAIRMAN

VISAKHAPATNAM URBAN
DEVELOPMENT AUTHORITY

22/1/90