

PROJECT DETAILS		VERSION NO. : 1.01.004	VERSION DATE: 15/06/2021
Region	VISAKHAPATNAM REGION	Plot Use	Residential
Authority	VISAKHAPATNAM METROPOLITAN REGION DEVELOPMENT AUTHORITY	Land Use Zone	NA
TLP No.	1167/0112/LP/DMRDA/2021	Main Abutting Road Width	12
Application Type	General/Proposal	If Plot is abutting to Highway	No
Project Type	Open Layout	Plot No. NA	
Nature of Development	New	Survey No.	15/18part/17/1
SubLocation	NA	North	-
Village Name	Golagam - vizianagaram	South	-
Mandal	DN	East	-
Ward	Golagam - vizianagaram	West	-
AREA DETAILS		sq.MT.	
AREA OF PLOT (Minimum)	(A)		19038.99
Deduction for NetPlot Area			
Lot/OverOwnerLand Area			180.64
Total			19038.99
NET AREA OF PLOT (A-Deductions)			18857.45
Deduction for Balance Plot Area			
Amenity Area			529.16
Lot/OverOwnerLand Area			180.64
Total			689.81
BALANCE AREA OF PLOT (A-Deductions)			18348.27
TLP NAME AND SIGNATURE	STRUCTURAL ENGINEER AND SIGNATURE	BUILDER NAME AND SIGNATURE	
S. Viswanatha Rao		M/s. Aditya Real Estates	
15/05/2019-22			

Land use analysis/Area distribution (Table 2c)

Area covered under PLOTS Area	Proposed Area in sq. mt.	Proposed Area in sq. ft.	Percentage(%)
Leftover Owners Land Area	19066.41	12786.88	56.13
Road Area	5634.24	6738.49	29.59
Amenity-1	148.83	175.61	0.77
Amenity-10	178.34	213.30	0.94
Amenity-11	184.00	220.06	0.97
Public Open Space	1907.96	2305.61	10.13
Utility Area	99.64	119.17	0.52
Total net layout	19038.99	22769.37	100.00

Land Area to Mortgage Details

Name	Ind Plot Name	Ind Plot Area
Land Area to Mortgage-1	1	295.33
	2	310.04
	3	289.55
Land Area to Mortgage-2	57	214.94
	58	229.21
	59	241.48
	60	267.50
Total	-	1847.07

Mortgage Area Details

Name	Road	Prop
Land Area to Mortgage	1622.97	1847.07

General Conditions

No.	General Conditions
1	LTP is responsible for any misrepresentation in above aspects.
2	Splay shall be maintained as per G.O.Ms.No.275, MA & UD dt. 18-07-2017 in all the road corners.

Individual Plot Area	Plot No.	Abutting Road	Plot Area	Plot Width	Plot Depth	Frontage
1	15/18	12M WIDE Internal Road-3	100.00	295.33	8.00	13.60
2	15/18	12M WIDE Internal Road-3	100.00	310.04	8.00	13.22
3	15/18	12M WIDE Internal Road-1	100.00	289.55	8.00	17.29
4	15/18	12M WIDE Internal Road-1	100.00	153.31	8.00	10.06
5	15/18	12M WIDE Internal Road-1	100.00	153.31	8.00	10.06
6	15/18	12M WIDE Internal Road-1	100.00	153.31	8.00	10.06
7	15/18	12M WIDE Internal Road-1	100.00	153.31	8.00	10.06
12	17/1	12M WIDE Internal Road-1	100.00	184.00	8.00	10.06
13	17/1	12M WIDE Internal Road-1	100.00	184.00	8.00	10.06
14	17/1	12M WIDE Internal Road-1	100.00	184.00	8.00	10.06
15	17/1	12M WIDE Internal Road-1	100.00	184.00	8.00	10.06
16	17/1	12M WIDE Internal Road-1	100.00	184.00	8.00	10.06
17	17/1	12M WIDE Internal Road-1	100.00	184.00	8.00	10.06
18	17/1	12M WIDE Internal Road-1	100.00	184.00	8.00	10.06
19	17/1	12M WIDE Internal Road-1	100.00	184.00	8.00	10.06
20	17/1	12M WIDE Internal Road-1	100.00	184.00	8.00	10.06
21	17/1	12M WIDE Internal Road-1	100.00	260.58	8.00	15.29
22	17/1	12M WIDE Internal Road-1	100.00	280.74	8.00	15.29
23	17/1	12M WIDE Internal Road-2	100.00	184.00	8.00	10.06
24	17/1	12M WIDE Internal Road-2	100.00	184.00	8.00	10.06
25	17/1	12M WIDE Internal Road-2	100.00	184.00	8.00	10.06
26	17/1	12M WIDE Internal Road-2	100.00	184.00	8.00	10.06
27	17/1	12M WIDE Internal Road-2	100.00	184.00	8.00	10.06
28	17/1	12M WIDE Internal Road-2	100.00	184.00	8.00	10.06
29	17/1	12M WIDE Internal Road-2	100.00	184.00	8.00	10.06
30	17/1	12M WIDE Internal Road-2	100.00	184.00	8.00	10.06
31	17/1	12M WIDE Internal Road-2	100.00	184.00	8.00	10.06
32	17/1	12M WIDE Internal Road-2	100.00	184.00	8.00	10.06
33	17/1	12M WIDE Internal Road-2	100.00	184.00	8.00	10.06
34	17/1	12M WIDE Internal Road-2	100.00	235.32	8.00	12.89
35	17/1	12M WIDE Internal Road-2	100.00	201.98	8.00	11.59
36	17/1	12M WIDE Internal Road-2	100.00	184.00	8.00	10.06
37	17/1	12M WIDE Internal Road-2	100.00	184.00	8.00	10.06
38	17/1	12M WIDE Internal Road-2	100.00	184.00	8.00	10.06
39	17/1	12M WIDE Internal Road-2	100.00	184.00	8.00	10.06
40	17/1	12M WIDE Internal Road-2	100.00	184.00	8.00	10.06
41	17/1	12M WIDE Internal Road-2	100.00	184.00	8.00	10.06
42	17/1	12M WIDE Internal Road-2	100.00	184.00	8.00	10.06
43	17/1	12M WIDE Internal Road-2	100.00	184.00	8.00	10.06
44	17/1	12M WIDE Internal Road-2	100.00	184.00	8.00	10.06
45	17/1	12M WIDE Internal Road-2	100.00	184.00	8.00	10.06
46	17/1	12M WIDE Internal Road-2	100.00	184.00	8.00	10.06
47	17/1	12M WIDE Internal Road-2	100.00	280.74	8.00	15.29
48	17/1	12M WIDE Internal Road-3	100.00	150.65	8.00	10.55
49	17/1	12M WIDE Internal Road-3	100.00	124.26	8.00	12.20
50	17/1	12M WIDE Internal Road-3	100.00	120.17	8.00	12.20
51	17/1	12M WIDE Internal Road-3	100.00	116.08	8.00	12.20
52	17/1	12M WIDE Internal Road-3	100.00	111.99	8.00	12.20
53	17/1	12M WIDE Internal Road-3	100.00	107.90	8.00	12.20
54	17/1	12M WIDE Internal Road-3	100.00	115.33	8.00	13.47
55	17/1	12M WIDE Internal Road-3	100.00	199.25	8.00	23.19
56	17/1	12M WIDE Internal Road-3	100.00	197.20	8.00	22.21
57	17/1	12M WIDE Internal Road-3	100.00	214.94	8.00	22.20
58	17/1	12M WIDE Internal Road-3	100.00	229.21	8.00	22.20
59	17/1	12M WIDE Internal Road-3	100.00	241.48	8.00	22.20
60	17/1	12M WIDE Internal Road-3	100.00	267.50	8.00	20.92

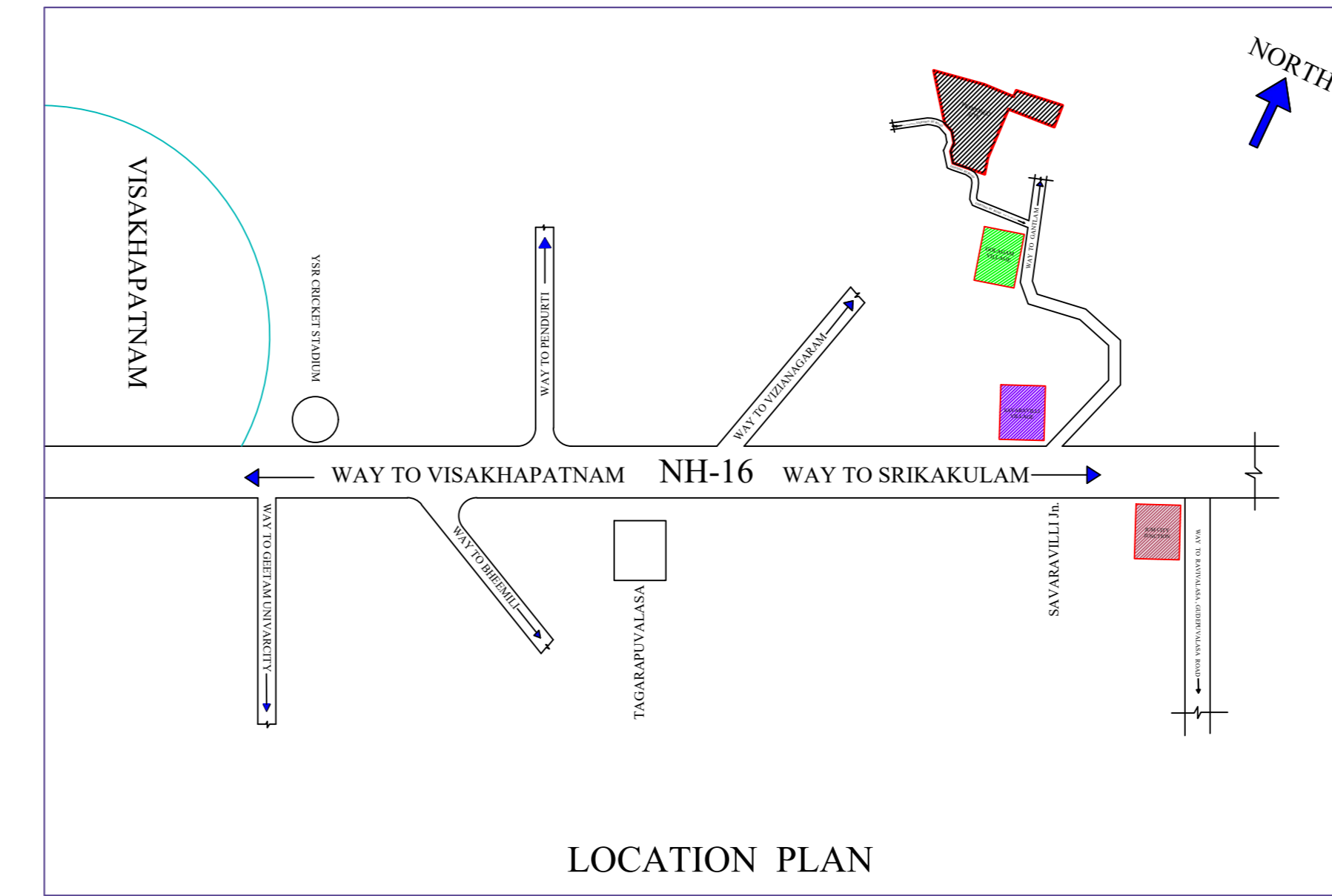

Survey No. & Sub div.	Full/Part	Document Proposed Extent In Sq/mts
15/18	Part	1942.491
15/18	Part	1982.960
15/18	Part	3965.919
15/18	Part	3965.919
17/1	Part	3237.485
<b>Total</b>		<b>19060.69</b>

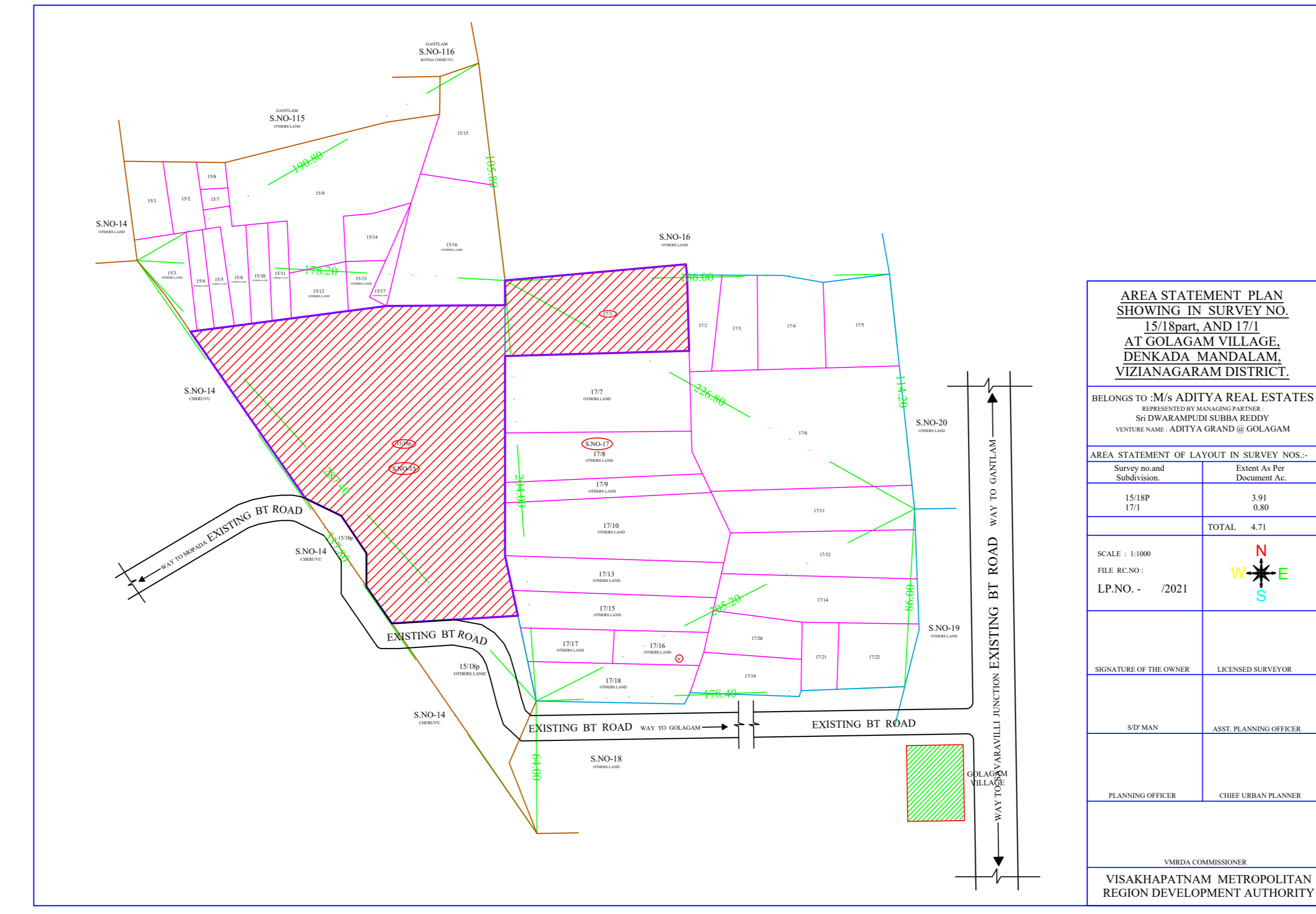
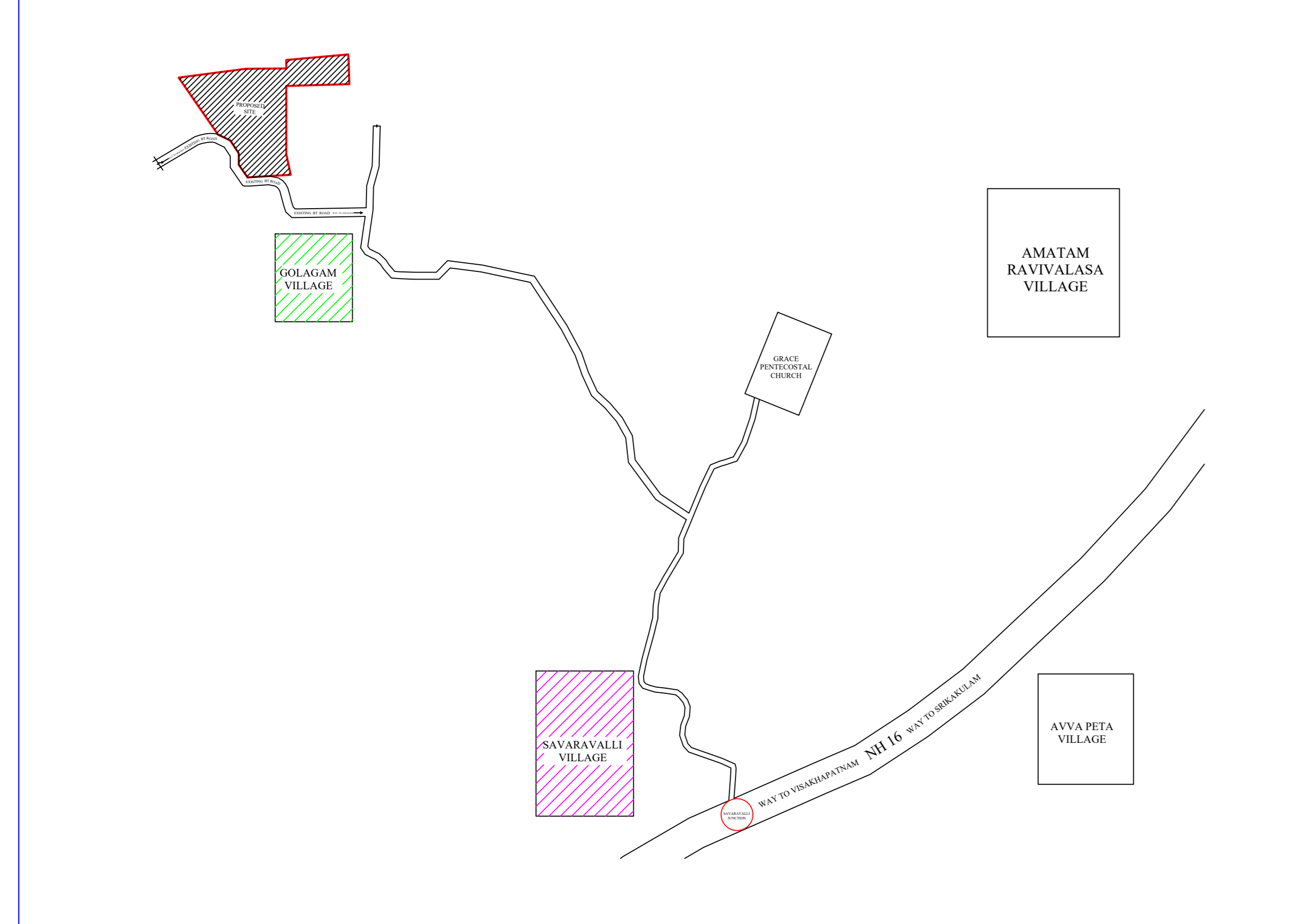
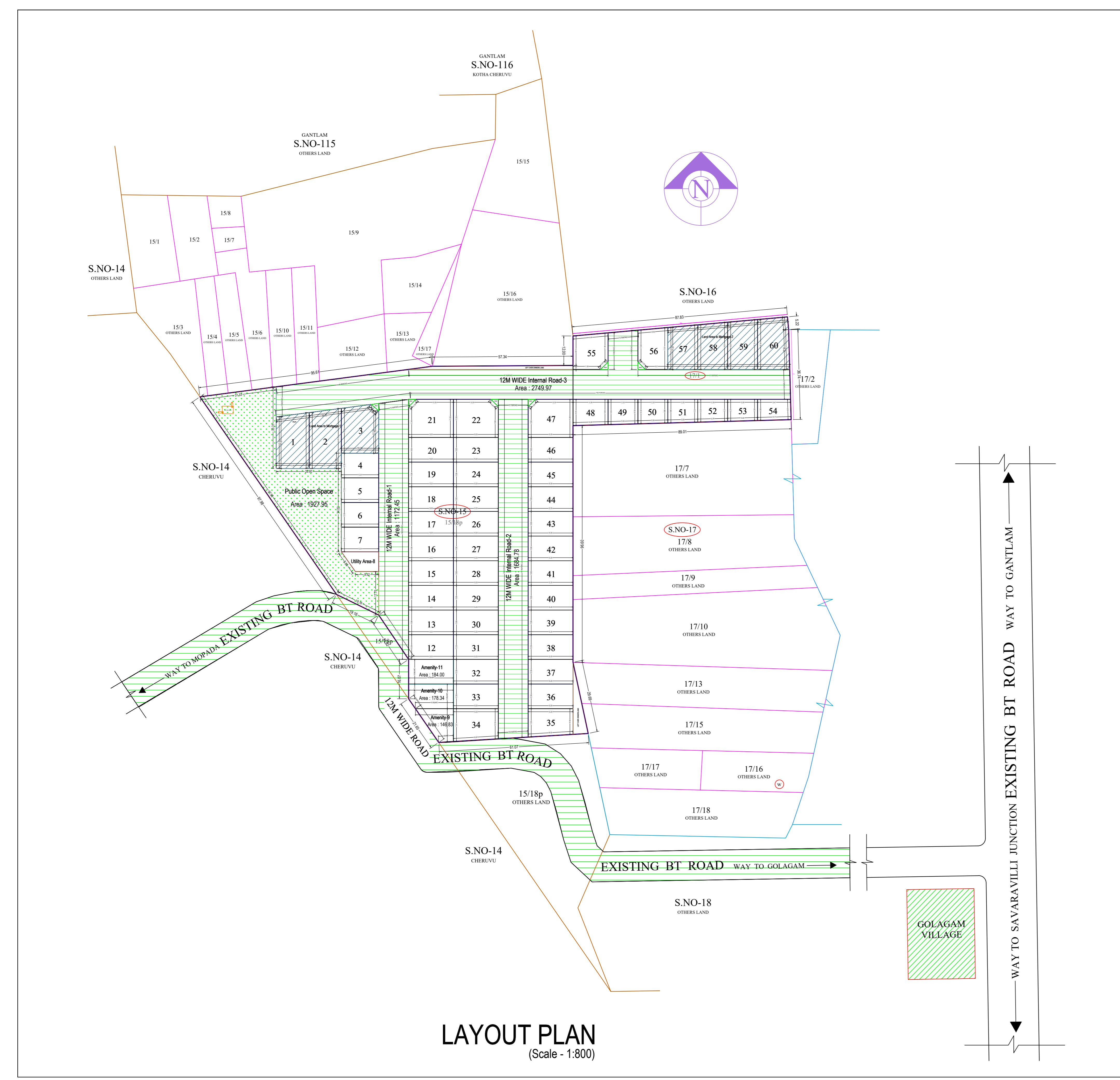

AREA STATEMENT PLAN SHOWING IN SURVEY NO. 15/18part AND 17/1 AT GOLAGAM VILLAGE, DENKADA MANDALAM, VIZIANAGARAM DISTRICT.

BELONGS TO : M/s ADITYA REAL ESTATES  
 REPRESENTED BY : Sri DWARAMPUDI SUBBA REDDY  
 VENTURE NAME : ADITYA GRAND @ GOLAGAM

AREA STATEMENT OF LAYOUT IN SURVEY NO. 15/18part AND 17/1

Serial Number	Area in Sq. Mts	Area in Sq. Ft.
15/18part	3965.919	45686.88
17/1	3237.485	37586.88
<b>TOTAL</b>	<b>7203.404</b>	<b>83273.76</b>

SCALE : 1:800  
 P.P.R. REF. NO. : (2021)  
 SIGNATURE OF THE OWNER : EXTENDED SUBBARAO  
 DATE : 08/07/2021  
 PLANNING OFFICER : CHIEF ENGINEER

VISAKHAPATNAM METROPOLITAN REGION DEVELOPMENT AUTHORITY

COLOR INDEX

Plot / Site lines	Blue
Existing street / road	Red
Proposed work including services	Green
Existing construction proposed to be demolished	Yellow
Existing structure to be retained	Grey
Work in progress duty sanctioned	Light Green
Open Space	White
Drainage and Sewerage work	Light Blue
Water Supply work	Light Purple
Deviations	Light Orange
Restriction ground	Light Yellow