

LAYOUT PLAN
 (Scale: 1:800)

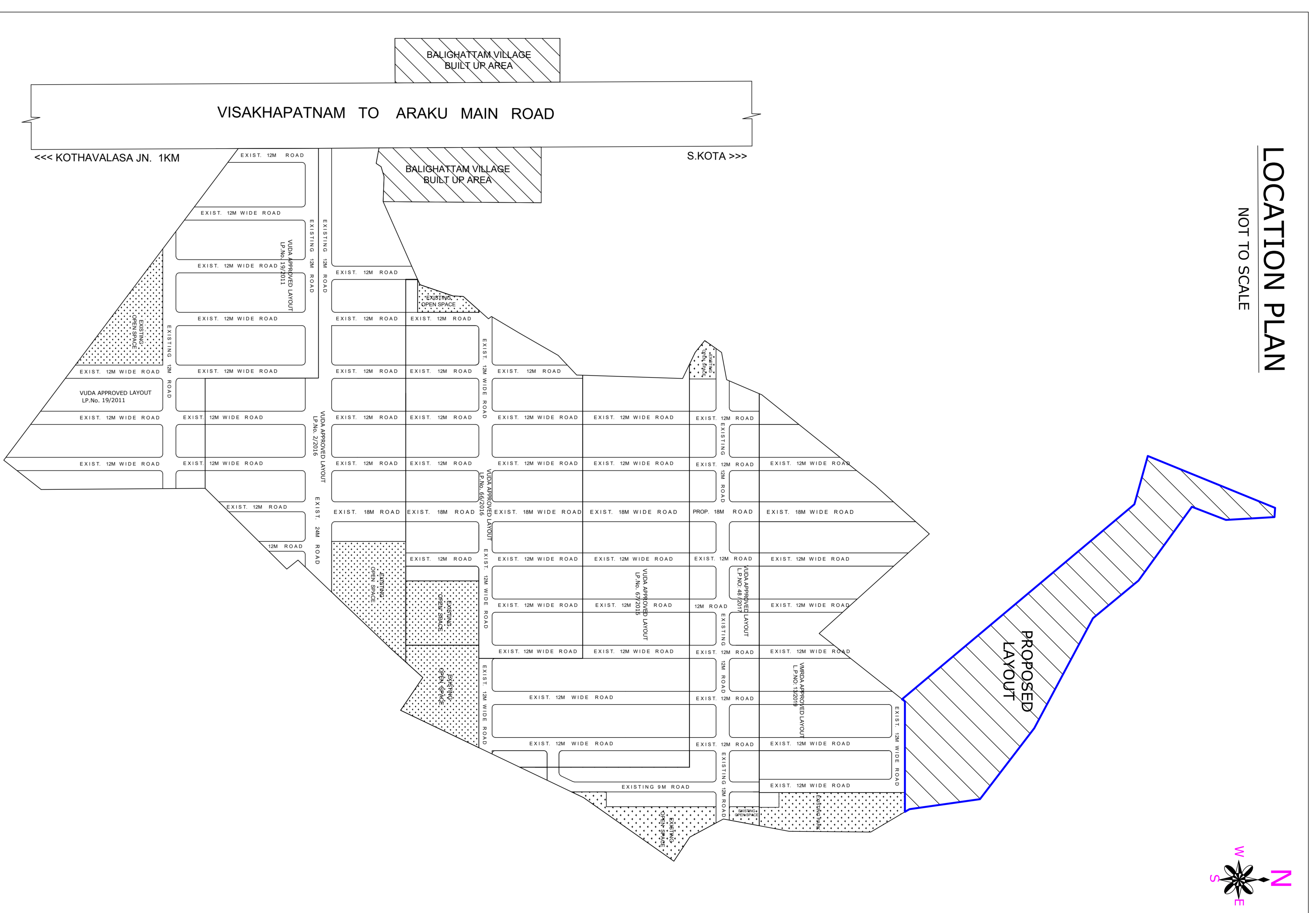

LOCATION PLAN
 NOT TO SCALE

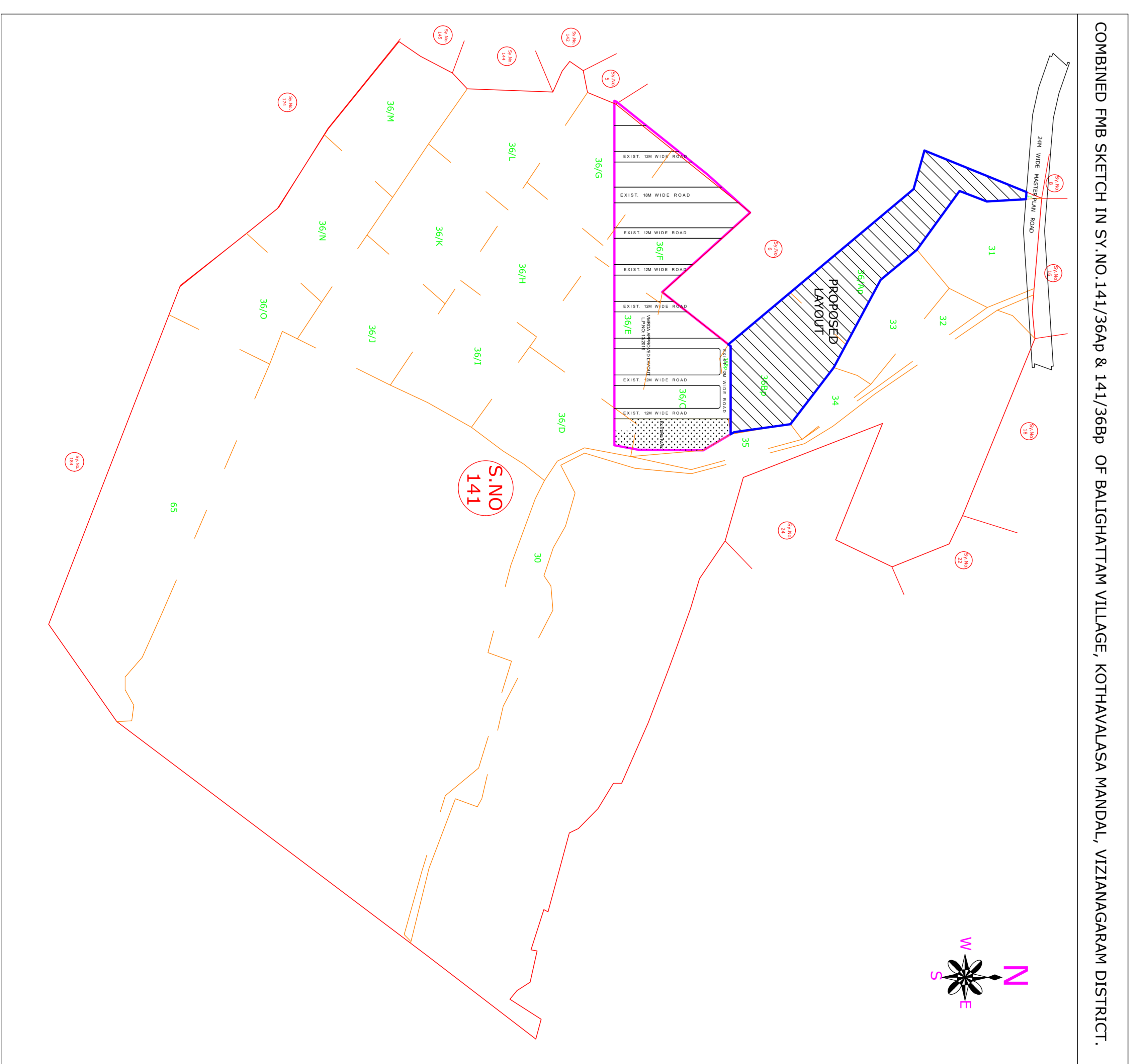

COMBINED FMB SKETCH IN SY.NO.141/36AP & 141/36BP OF BALIGHATTAM VILLAGE, KOTHAVALLASA MANDAL, VIJAYANAGARAM DISTRICT.

Sl. No.	Area (sq. m)	Area (sq. ft)	Area (sq. yd)	Area (sq. m)	Area (sq. ft)	Area (sq. yd)
1	1000	10764	1161	1000	10764	1161
2	1000	10764	1161	1000	10764	1161
3	1000	10764	1161	1000	10764	1161
4	1000	10764	1161	1000	10764	1161
5	1000	10764	1161	1000	10764	1161
6	1000	10764	1161	1000	10764	1161
7	1000	10764	1161	1000	10764	1161
8	1000	10764	1161	1000	10764	1161
9	1000	10764	1161	1000	10764	1161
10	1000	10764	1161	1000	10764	1161
11	1000	10764	1161	1000	10764	1161
12	1000	10764	1161	1000	10764	1161
13	1000	10764	1161	1000	10764	1161
14	1000	10764	1161	1000	10764	1161
15	1000	10764	1161	1000	10764	1161
16	1000	10764	1161	1000	10764	1161
17	1000	10764	1161	1000	10764	1161
18	1000	10764	1161	1000	10764	1161
19	1000	10764	1161	1000	10764	1161
20	1000	10764	1161	1000	10764	1161
21	1000	10764	1161	1000	10764	1161
22	1000	10764	1161	1000	10764	1161
23	1000	10764	1161	1000	10764	1161
24	1000	10764	1161	1000	10764	1161
25	1000	10764	1161	1000	10764	1161
26	1000	10764	1161	1000	10764	1161
27	1000	10764	1161	1000	10764	1161
28	1000	10764	1161	1000	10764	1161
29	1000	10764	1161	1000	10764	1161
30	1000	10764	1161	1000	10764	1161
31	1000	10764	1161	1000	10764	1161
32	1000	10764	1161	1000	10764	1161
33	1000	10764	1161	1000	10764	1161
34	1000	10764	1161	1000	10764	1161
35	1000	10764	1161	1000	10764	1161
36	1000	10764	1161	1000	10764	1161
37	1000	10764	1161	1000	10764	1161
38	1000	10764	1161	1000	10764	1161
39	1000	10764	1161	1000	10764	1161
40	1000	10764	1161	1000	10764	1161
41	1000	10764	1161	1000	10764	1161
42	1000	10764	1161	1000	10764	1161
43	1000	10764	1161	1000	10764	1161
44	1000	10764	1161	1000	10764	1161
45	1000	10764	1161	1000	10764	1161
46	1000	10764	1161	1000	10764	1161
47	1000	10764	1161	1000	10764	1161
48	1000	10764	1161	1000	10764	1161
49	1000	10764	1161	1000	10764	1161
50	1000	10764	1161	1000	10764	1161
51	1000	10764	1161	1000	10764	1161
52	1000	10764	1161	1000	10764	1161
53	1000	10764	1161	1000	10764	1161
54	1000	10764	1161	1000	10764	1161
55	1000	10764	1161	1000	10764	1161
56	1000	10764	1161	1000	10764	1161
57	1000	10764	1161	1000	10764	1161
58	1000	10764	1161	1000	10764	1161
59	1000	10764	1161	1000	10764	1161
60	1000	10764	1161	1000	10764	1161
61	1000	10764	1161	1000	10764	1161
62	1000	10764	1161	1000	10764	1161
63	1000	10764	1161	1000	10764	1161
64	1000	10764	1161	1000	10764	1161
65	1000	10764	1161	1000	10764	1161
66	1000	10764	1161	1000	10764	1161
67	1000	10764	1161	1000	10764	1161
68	1000	10764	1161	1000	10764	1161
69	1000	10764	1161	1000	10764	1161
70	1000	10764	1161	1000	10764	1161
71	1000	10764	1161	1000	10764	1161
72	1000	10764	1161	1000	10764	1161
73	1000	10764	1161	1000	10764	1161
74	1000	10764	1161	1000	10764	1161
75	1000	10764	1161	1000	10764	1161
76	1000	10764	1161	1000	10764	1161
77	1000	10764	1161	1000	10764	1161
78	1000	10764	1161	1000	10764	1161
79	1000	10764	1161	1000	10764	1161
80	1000	10764	1161	1000	10764	1161
81	1000	10764	1161	1000	10764	1161
82	1000	10764	1161	1000	10764	1161
83	1000	10764	1161	1000	10764	1161
84	1000	10764	1161	1000	10764	1161
85	1000	10764	1161	1000	10764	1161
86	1000	10764	1161	1000	10764	1161
87	1000	10764	1161	1000	10764	1161
88	1000	10764	1161	1000	10764	1161
89	1000	10764	1161	1000	10764	1161
90	1000	10764	1161	1000	10764	1161
91	1000	10764	1161	1000	10764	1161
92	1000	10764	1161	1000	10764	1161
93	1000	10764	1161	1000	10764	1161
94	1000	10764	1161	1000	10764	1161
95	1000	10764	1161	1000	10764	1161
96	1000	10764	1161	1000	10764	1161
97	1000	10764	1161	1000	10764	1161
98	1000	10764	1161	1000	10764	1161
99	1000	10764	1161	1000	10764	1161
100	1000	10764	1161	1000	10764	1161
101	1000	10764	1161	1000	10764	1161
102	1000	10764	1161	1000	10764	1161
103	1000	10764	1161	1000	10764	1161
104	1000	10764	1161	1000	10764	1161
105	1000	10764	1161	1000	10764	1161
106	1000	10764	1161	1000	10764	1161
107	1000	10764	1161	1000	10764	1161
108	1000	10764	1161	1000	10764	1161
109	1000	10764	1161	1000	10764	1161
110	1000	10764	1161	1000	10764	1161
111	1000	10764	1161	1000	10764	1161
112	1000	10764	1161	1000	10764	1161
113	1000	10764	1161	1000	10764	1161
114	1000	10764	1161	1000	10764	1161
115	1000	10764	1161	1000	10764	1161
116	1000	10764	1161	1000	10764	1161
117	1000	10764	1161	1000	10764	1161
118	1000	10764	1161	1000	10764	1161
119	1000	10764	1161	1000	10764	1161
120	1000	10764	1161	1000	10764	1161
121	1000	10764	1161	1000	10764	1161
122	1000	10764	1161	1000	10764	1161
123	1000	10764	1161	1000	10764	1161
124	1000	10764	1161	1000	10764	1161
125	1000	10764	1161	1000	10764	1161
126	1000	10764	1161	1000	10764	1161
127	1000	10764	1161	1000	10764	1161
128	1000	10764	1161	1000	10764	1161
129	1000	10764	1161	1000	10764	1161
130	1000	10764	1161	1000	10764	1161
131	1000	10764	1161	1000	10764	1161
132	1000	10764	1161	1000	10764	1161
133	1000	10764	1161	1000	10764	1161
134	1000	10764	1161	1000	10764	1161
135	1000	10764	1161	1000	10764	1161
136	1000	10764	1161	1000	10764	1161
137	1000	10764	1161	1000	10764	1161
138	1000	10764	1161	1000	10764	1161
139	1000	10764	1161	1000	10764	1161
140	1000	10764	1161	1000	10764	1161
141	1000	10764	1161	1000	10764	1161

Legend
 1. Proposed Road
 2. Existing Road
 3. Proposed Plot
 4. Existing Plot
 5. Open Space
 6. Water Body
 7. Boundary
 8. Survey Markers
 9. North Arrow
 10. Scale

Scale
 1:800
 1:1000
 1:2000
 1:5000
 1:10000

Notes
 1. The layout plan is prepared in accordance with the provisions of the Andhra Pradesh Urban Planning and Construction Act, 1973.
 2. The layout plan is subject to the approval of the competent authority.
 3. The layout plan is valid for a period of five years from the date of approval.
 4. The layout plan is subject to the availability of funds.
 5. The layout plan is subject to the availability of land.
 6. The layout plan is subject to the availability of water.
 7. The layout plan is subject to the availability of electricity.
 8. The layout plan is subject to the availability of other services.
 9. The layout plan is subject to the availability of other facilities.
 10. The layout plan is subject to the availability of other amenities.

Prepared by
 M/s. [Name]
 [Address]
 [City]
 [State]
 [Pin Code]

Checked by
 [Name]
 [Designation]
 [Date]

Approved by
 [Name]
 [Designation]
 [Date]

Stamp
 [Name]
 [Address]
 [City]
 [State]
 [Pin Code]

Scale
 1:800
 1:1000
 1:2000
 1:5000
 1:10000

Notes
 1. The layout plan is prepared in accordance with the provisions of the Andhra Pradesh Urban Planning and Construction Act, 1973.
 2. The layout plan is subject to the approval of the competent authority.
 3. The layout plan is valid for a period of five years from the date of approval.
 4. The layout plan is subject to the availability of funds.
 5. The layout plan is subject to the availability of land.
 6. The layout plan is subject to the availability of water.
 7. The layout plan is subject to the availability of electricity.
 8. The layout plan is subject to the availability of other services.
 9. The layout plan is subject to the availability of other facilities.
 10. The layout plan is subject to the availability of other amenities.