

TOPO PLAN
NOT TO SCALE

AREA STATEMENT (OWNERSHIP)

SL NO	DOCUMENT NUMBER	SURVEY NO./ SUBDIVISION	APPLIED EXTENT
1	2828/2017	324/5 P	Ac 2.68 Cts
2	2828/2017	324/6	Ac 0.315 Cts
3	2828/2017	324/7	Ac 0.71 Cts
4	2828/2017	324/8	Ac 1.40 Cts
TOTAL EXTENT APPLIED FOR LAYOUT			Ac 5.105 Cts

NOTE:
AS PER THE ORDERS OF THE METROPOLITAN COMMISSIONER, VUDA AT NOTE # 144, DT. 24-03-2024, IN FILE NO: 8037/2017/L1 [E-273437] TO RELEASE OF MORTGAGE PART NOS: 45 TO 49 & 51 TO 57, [TOTAL 12 PLOTS] IN LP NO G/2018, WHICH ARE UNDER MORTGAGED TO VUDA THROUGH REGISTERED MORTGAGE DEED BY RELEASED THROUGH A REGISTERED DEED OF RE-CONVEYANCE OF MORTGAGED VIDE DOC-NO: 4437/2014, DT. 28-03-2014.

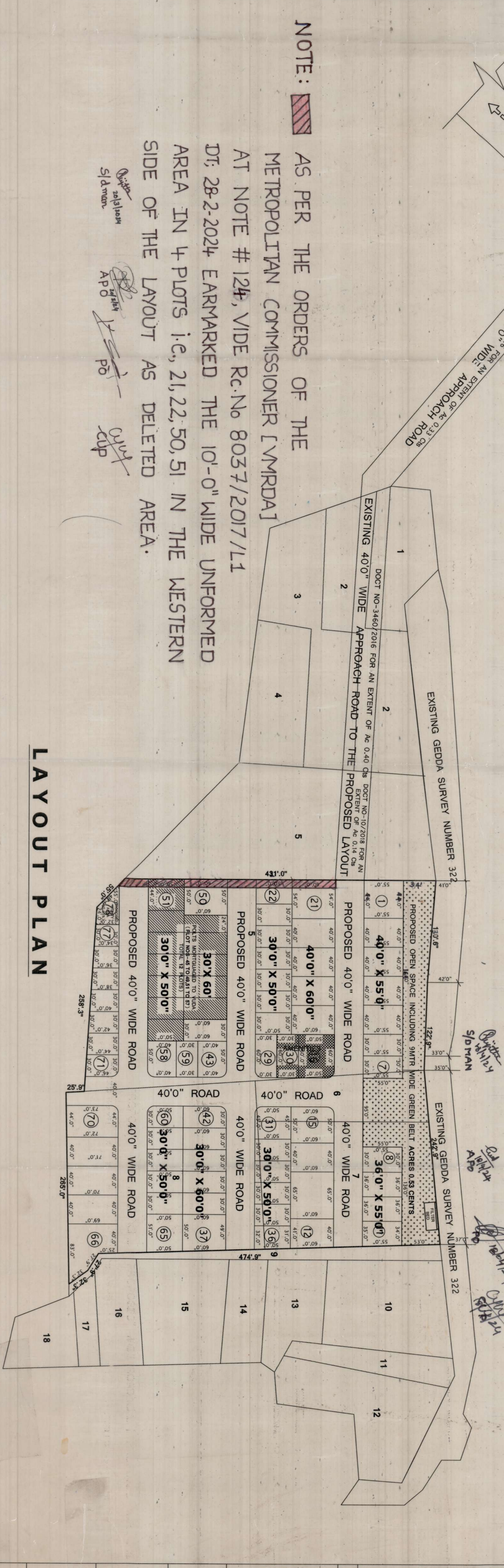

NOTE:
AS PER THE ORDERS OF THE METROPOLITAN COMMISSIONER [VMPRD] AT NOTE # 124, VIDE RC.No 8037/2017/L1 DT: 28-2-2024 EARMARKED THE 10'-0" WIDE UNFORMED AREA IN 4 PLOTS i.e., 21, 22, 50, 51 IN THE WESTERN SIDE OF THE LAYOUT AS DELETED AREA.

LAYOUT PLAN

PROPOSED RESIDENTIAL LAY OUT IN SURVEY NUMBER 324/5p, 6, 7, 8 OF KODURU VILLAGE ANAKAPALLE MANDALAM, VISAKHAPATNAM DISTRICT.

BELONGS TO:
M/S : SAMRIDDIHI VENTURES (PVT) LTD.
REPRESENTED BY ITS MANAGING DIRECTOR SMT. K.KALPANA

S.NO	LAND USE	AC - CTS	PERCENTAGE
01	PLTTED AREA	Ac 2.824 Cts	55.32%
02	AMENITIES	Ac 0.110 Cts	02.15%
03	UTILITIES	Ac 0.026 Cts	00.51%
04	OPEN SPACE	Ac 0.532 Cts	10.42%
05	ROADS AREA	Ac 1.613 Cts	31.60%
TOTAL		Ac 5.105 Cts	100.00%

PLOTTING DETAILS

S.NO	SIZE OF PLOT	EXTENT	NO OF PLOTS
01	30'0" X 45'0"	150.00 Syds	08 NOS
02	30'0" X 50'0"	166.67 Syds	25 NOS
03	30'0" X 55'0"	183.33 Syds	03 NOS
04	36'0" X 55'0"	220.00 Syds	03 NOS
05	65'0" X 60'0"	433.33 Syds	01 NOS
06	40'0" X 55'0"	244.44 Syds	04 NOS
07	40'0" X 60'0"	266.66 Syds	08 NOS
08	30'0" X 60'0"	200.00 Syds	15 NOS
09	50'0" X 60'0"	333.33 Syds	06 NOS
10	40'0" X 70'0"	311.11 Syds	05 NOS
TOTAL PLOTS			78 NOS

REFERENCE:
AMENITIES
UTILITIES
OPEN SPACE
MORTGAGED PLOTS MORTGAGED TO VUDA PLOT NOS 45 TO 49 & 51 TO 57 TOTAL (12) PLOTS TO AN EXTENT OF AC 0.485 CTS (282.20 Sq Yds), IS EQUAL TO 15% OF PLOTTED AREA.

OWNER
S/D.MAN

LICENSED SURVEYOR
S.D.MAN

ASSISTANT PLANNING OFFICER
VISA KHAPATNAM URBAN DEVELOPMENT AUTHORITY

VICE CHAIRMAN
VISA KHAPATNAM URBAN DEVELOPMENT AUTHORITY