

AREA STATEMENT	VERSION NO: 1.101.130	VERSION DATE: 15/05/2024
PROJECT DETAIL:		
Region: VISAKHAPATNAM REGION	Plot Use: Residential	
Authority: VISAKHAPATNAM METROPOLITAN REGION DEVELOPMENT AUTHORITY	Land Use Zone: Mixed Residential Use Zone	
T.P. No: 1167/0028/1/P/MRDA/2024	Main Abutting Road Width: 50	
Application Type: General/Proposal	If Plot is abutting to Highway: No	
Project Type: Open Layout	Plot No: NA	
Nature of Development: New	Survey No: 347/17p & 348/3p	
*Situation No:	North:	
Village Name: Polipalli	South:	
Mandal: BHD	East:	
Town: Polipalli	West:	
AREA DETAILS:		
Area of Plot (Minimum)	(A)	7223.87
NET AREA OF PLOT	(A-Deductions)	7223.87
Deduction for Balance Plot Area		
Road Widening Area		160.90
Amenity Area		249.44
Total		410.25
BALANCE AREA OF PLOT	(A-Deductions)	6813.53
LTP NAME AND SIGNATURE	STRUCTURAL ENG NAME AND SIGNATURE	BUILDER NAME AND SIGNATURE
Hanumanthu Lakshmi Narayana		Ravi Prasad Talluru
104		REG/1167/DEV/0040/2024

Land use analysis/Area distribution (Table 2c)			
Area covered under	Proposed Area in sq. mt.	Proposed Area in sq. yd.	Percentage(%)
Plotted Area	3773.45	4513.02	52.24
Road Area	2407.82	2879.73	33.33
Amenity - 3	249.44	296.33	3.45
PUBLIC OPEN SPACE	731.79	875.21	10.13
Utility Area	61.36	73.39	0.85
Total net layout	7223.87	8639.68	100.00

Land Area to Mortgage Details		
Name	Ind Plot Name	Ind Plot Area
Mortgage Plots	9	258.47
	10	241.65
	11	241.80
Total	-	741.92

Mortgage Area Details		
Name	Reel	Prop
Land Area to Mortgage	566.02	741.92

General Conditions	
No.	General Conditions
1	LTP is responsible for any misrepresentation in above aspects.
2	Display shall be maintained as per G.O.M.S.No.275, MA & UD dt. 18-07-2017 in all the road corners.

Plot No.	Abutting Road	Plot Area	Plot Width	Plot Depth	Frontage
1	12M PROP. ROAD - 3	100.00	278.82	8.00	15.25
2	12M PROP. ROAD - 3	100.00	185.90	8.00	12.19
4	12M WIDE PROPOSED ROAD - 1	100.00	241.55	8.00	12.19
5	12M WIDE PROPOSED ROAD - 1	100.00	199.28	8.00	10.06
6	12M WIDE PROPOSED ROAD - 1	100.00	199.28	8.00	10.06
7	12M WIDE PROPOSED ROAD - 1	100.00	199.28	8.00	10.06
8	12M WIDE PROPOSED ROAD - 1	100.00	199.28	8.00	10.06
9	12M WIDE PROPOSED ROAD - 1	100.00	258.53	8.00	10.06
10	12M WIDE PROPOSED ROAD - 1	100.00	242.70	8.00	10.06
11	12M WIDE PROPOSED ROAD - 1	100.00	242.23	8.00	10.88
12	12M WIDE PROPOSED ROAD - 1	100.00	200.01	8.00	10.97
13	12M WIDE PROPOSED ROAD - 1	100.00	183.83	8.00	10.06
14	12M WIDE PROPOSED ROAD - 1	100.00	183.85	8.00	10.06
15	12M WIDE PROPOSED ROAD - 1	100.00	183.87	8.00	10.06
16	12M WIDE PROPOSED ROAD - 1	100.00	183.89	8.00	10.06
17	12M WIDE PROPOSED ROAD - 1	100.00	183.90	8.00	10.06
18	12M WIDE PROPOSED ROAD - 1	100.00	183.92	8.00	0.00
19	12M WIDE PROPOSED ROAD - 1	100.00	222.95	8.00	12.19

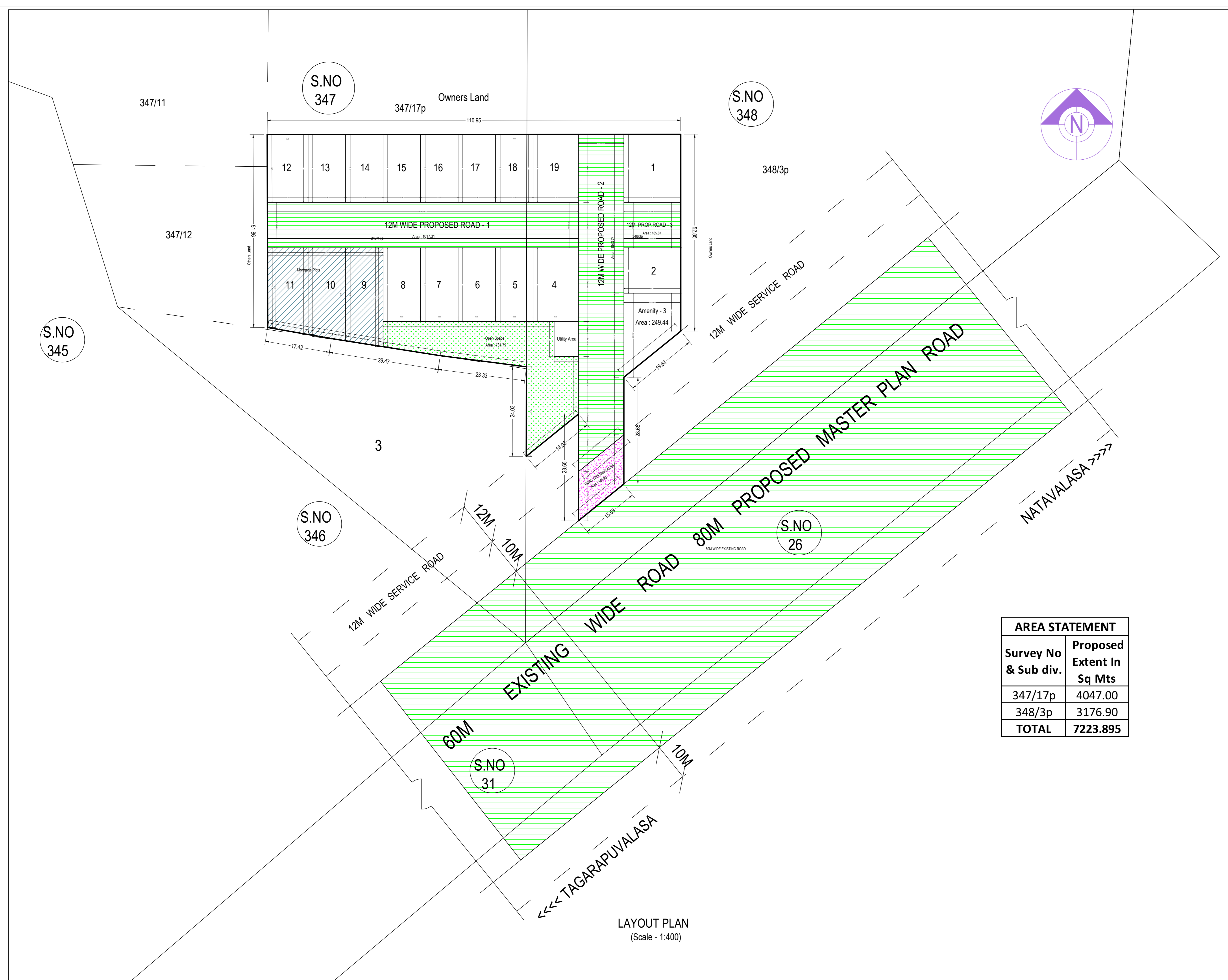

AREA STATEMENT	
Survey No & Sub div.	Proposed Extent In Sq Mts
347/17p	4047.00
348/3p	3176.90
<b>TOTAL</b>	<b>7223.895</b>

LAYOUT PLAN (Scale - 1:400)

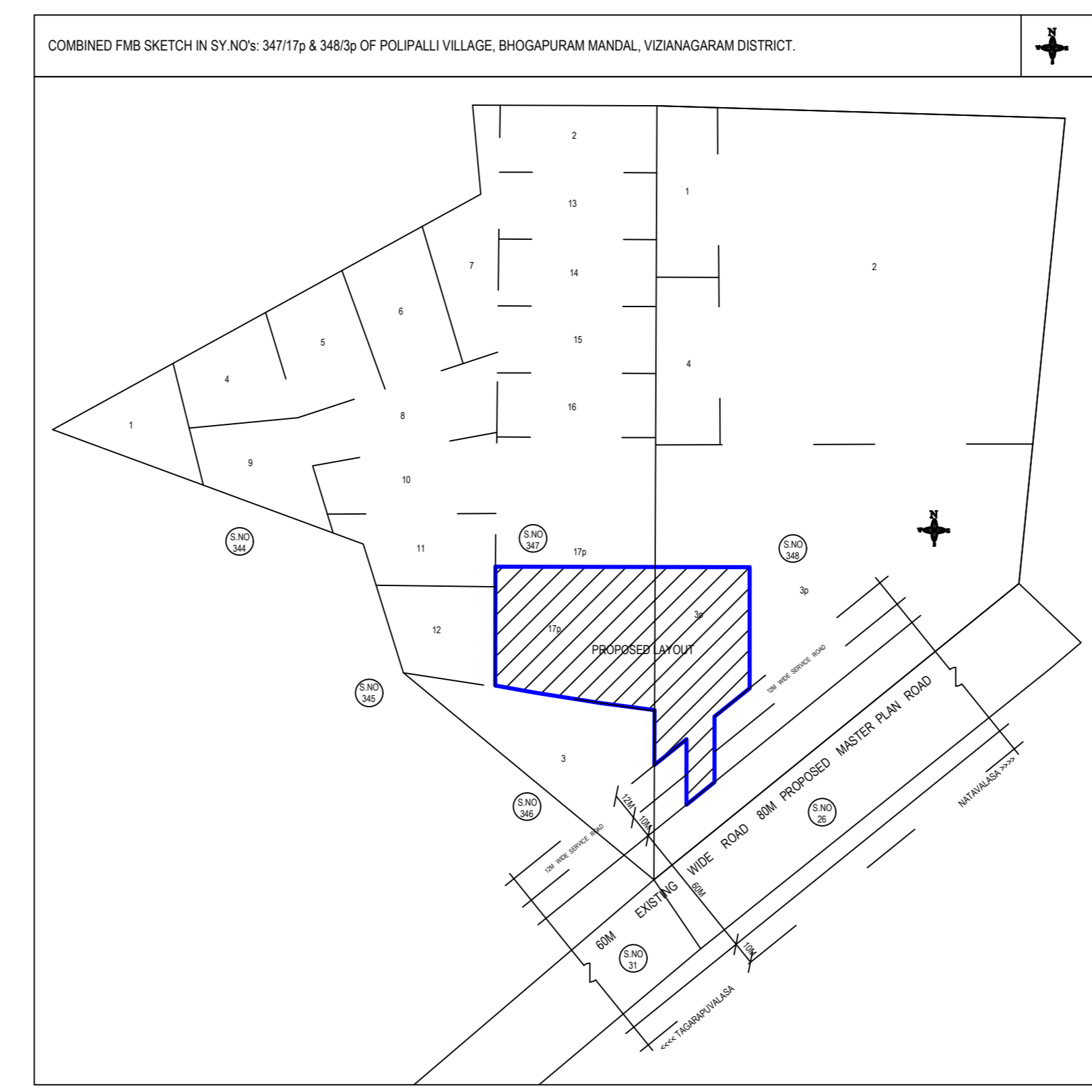
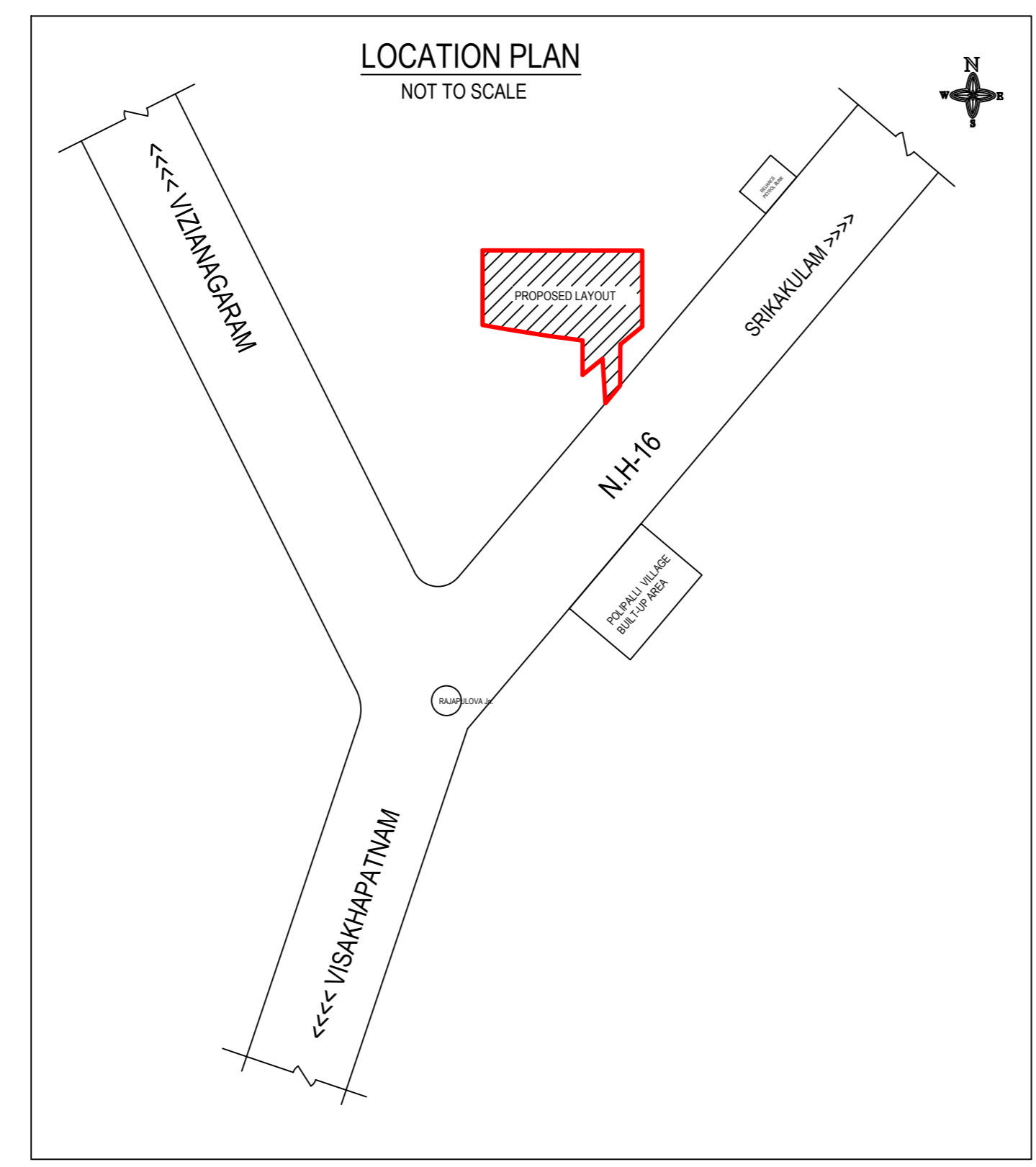

COLOR INDEX	
Plot / Site lines	--- (dashed line)
Existing street / road	--- (solid line)
Proposed work including services	--- (dotted line)
Existing construction proposed to be demolished	--- (cross-hatched)
Existing structure to be retained	--- (diagonal lines)
Work in progress duly sanctioned	--- (horizontal lines)
Open Space	--- (stippled)
Drainage and Sewerage work	--- (wavy lines)
Water Supply work	--- (dotted lines)
Deviations	--- (zigzag lines)
Restriction ground	--- (diagonal lines)