

LAYOUT PLAN



TOPO DETAIL PLAN SHOWING IN SURVEY NO'S: 5/17A, 10/1p,2p,4p,5p,6p,12p,13p, AND 11/ 3p,5,6,7A,8,9p,11p,12, AT JONNADA VILLAGE, DENKADA MANDALAM, VIZIANAGARAM DISTRICT.
 BELONGS TO : SRI LAKSHMI GANAPATHI REALTORS
 REPRESENTED BY : G.SHIVA KUMAR VENTURE NAME : SVN GOLD CREST

LEGEND
 - PROPOSED SITE BOUNDARY
 - RESIDENTIAL USE
 - COMMERCIAL USE
 - WATER BODIES
 - OPEN SPACE & PARKS

SCALE 1 : 2000

SIGNATURE OF THE OWNER

LICENSED SURVEYOR

VISAKHAPATNAM METROPOLITAN REGION DEVELOPMENT AUTHORITY

| Plot No. | Area | | | Permit | | | Rate | | |
|----------|--------|--------|------|--------|------|--------|------|--------|------|
| | Plot | Sub | Part | Area | Rate | Permit | Rate | Permit | Rate |
| 1 | 100.00 | 204.62 | 0.00 | 11.86 | - | 18.00 | - | 11.80 | - |
| 2 | 100.00 | 200.90 | 0.00 | 10.12 | - | 28.00 | - | 10.12 | - |
| 3 | 100.00 | 211.80 | 0.00 | 10.12 | - | 21.00 | - | 10.12 | - |
| 4 | 100.00 | 220.01 | 0.00 | 10.12 | - | 22.00 | - | 10.12 | - |
| 5 | 100.00 | 224.94 | 0.00 | 10.12 | - | 23.40 | - | 10.12 | - |
| 6 | 100.00 | 270.90 | 0.00 | 14.02 | - | 20.17 | - | 14.02 | - |
| 7 | 100.00 | 164.55 | 0.00 | 8.14 | - | 15.24 | - | 8.14 | - |
| 8 | 100.00 | 138.40 | 0.00 | 8.15 | - | 15.24 | - | 8.15 | - |
| 9 | 100.00 | 138.40 | 0.00 | 8.15 | - | 15.24 | - | 8.15 | - |
| 10 | 100.00 | 138.40 | 0.00 | 8.15 | - | 15.24 | - | 8.15 | - |
| 11 | 100.00 | 171.90 | 0.00 | 12.19 | - | 11.00 | - | 8.54 | - |
| 12 | 100.00 | 162.04 | 0.00 | 12.11 | - | 11.00 | - | 13.11 | - |
| 13 | 100.00 | 147.00 | 0.00 | 8.15 | - | 16.16 | - | 8.15 | - |
| 14 | 100.00 | 147.00 | 0.00 | 8.15 | - | 16.16 | - | 8.15 | - |
| 15 | 100.00 | 147.00 | 0.00 | 8.15 | - | 16.16 | - | 8.15 | - |
| 16 | 100.00 | 147.00 | 0.00 | 8.15 | - | 16.16 | - | 8.15 | - |
| 17 | 100.00 | 113.02 | 0.00 | 10.34 | - | 18.33 | - | 10.34 | - |
| 18 | 100.00 | 47.81 | 0.00 | 16.07 | - | 38.30 | - | 16.07 | - |
| 19 | 100.00 | 407.80 | 0.00 | 14.04 | - | 31.00 | - | 14.04 | - |
| 20 | 100.00 | 408.80 | 0.00 | 14.04 | - | 32.14 | - | 14.04 | - |
| 21 | 100.00 | 315.30 | 0.00 | 10.80 | - | 18.53 | - | 10.80 | - |
| 22 | 100.00 | 210.00 | 0.00 | 11.00 | - | 18.53 | - | 11.00 | - |
| 23 | 100.00 | 210.00 | 0.00 | 11.00 | - | 18.53 | - | 11.00 | - |
| 24 | 100.00 | 200.40 | 0.00 | 11.22 | - | 18.20 | - | 11.22 | - |
| 25 | 100.00 | 148.40 | 0.00 | 11.00 | - | 18.53 | - | 11.00 | - |
| 26 | 100.00 | 312.24 | 0.00 | 17.28 | - | 17.96 | - | 17.28 | - |
| 27 | 100.00 | 205.07 | 0.00 | 12.19 | - | 18.40 | - | 12.19 | - |
| 28 | 100.00 | 207.11 | 0.00 | 12.19 | - | 18.53 | - | 12.19 | - |
| 29 | 100.00 | 208.00 | 0.00 | 12.19 | - | 18.36 | - | 12.19 | - |
| 30 | 100.00 | 200.80 | 0.00 | 11.23 | - | 18.22 | - | 11.23 | - |
| 31 | 100.00 | 182.24 | 0.00 | 11.00 | - | 11.00 | - | 11.00 | - |
| 32 | 100.00 | 141.31 | 0.00 | 10.06 | - | 14.00 | - | 10.06 | - |
| 33 | 100.00 | 147.20 | 0.00 | 14.00 | - | 14.00 | - | 14.00 | - |
| 34 | 100.00 | 240.74 | 0.00 | 17.34 | - | 13.10 | - | 17.34 | - |
| 35 | 100.00 | 240.79 | 0.00 | 12.19 | - | 18.40 | - | 12.19 | - |
| 36 | 100.00 | 240.80 | 0.00 | 12.19 | - | 18.10 | - | 12.19 | - |

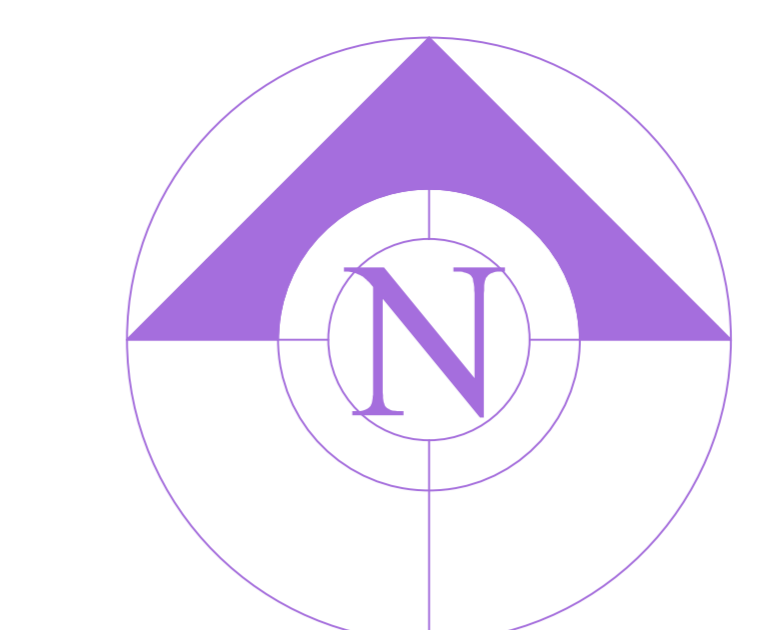

Color Index

| | |
|--|-------------|
| Plot No. | Color |
| Existing street road | Green |
| Proposed road with existing services | Yellow |
| Existing construction proposed to be developed | Red |
| Existing structure to be retained | Blue |
| Water in progress city development | Light Blue |
| Open Space | White |
| Drainage and Sewerage work | Orange |
| Water Supply work | Light Green |
| Demarcation | Black |
| Demarcation physical | Red |

Land Use analysis/area distribution (Table 2)

| Name | Proposed Area in sq. ft. | Percentage (%) |
|---------------------------|--------------------------|----------------|
| Plotter Area | 851.74 | 18.33 |
| Leftover Owners Land Area | 284.27 | 6.25 |
| Plot Area | 4708.10 | 103.42 |
| Plotter Area | 104.27 | 2.30 |
| Leftover Owners Land Area | 121.47 | 2.69 |
| Total Plotter Area | 1056.01 | 23.37 |

Land Area to Mortgage Details

| Name | Plot No. | Plot Area |
|-----------------------|----------|-----------|
| Plot Area to Mortgage | 7 | 100.00 |
| Plot Area to Mortgage | 8 | 100.00 |
| Plot Area to Mortgage | 9 | 100.00 |
| Plot Area to Mortgage | 10 | 100.00 |
| Plot Area to Mortgage | 11 | 100.00 |
| Plot Area to Mortgage | 12 | 100.00 |
| Plot Area to Mortgage | 13 | 100.00 |
| Plot Area to Mortgage | 14 | 100.00 |
| Plot Area to Mortgage | 15 | 100.00 |
| Total | 15 | 1500.00 |

| Survey No & Sub div. | Full/ Part | Doc. Proposed Extent Sq/mts. |
|----------------------|------------|------------------------------|
| 5/17A | Part | 2428.11 |
| 10/1 | Part | 809.37 |
| 10/2 | Part | 849.84 |
| 10/4 | Part | 1011.71 |
| 10/5 | Part | 1497.34 |
| 10/6 | Part | 2994.68 |
| 10/12 | Part | 890.31 |
| 10/13 | Part | 809.37 |
| 11/3 | Part | 971.25 |
| 11/5 | Full | 1092.65 |
| 11/6 | Full | 1052.18 |
| 11/7A | Part | 1173.59 |
| 11/8 | Full | 890.31 |
| 11/9 | Part | 809.37 |
| 11/11 | Part | 930.78 |
| 11/12 | Full | 890.31 |
| | | 19101.17 |

| | | |
|-----------------------|----------------------|---|
| Plot Area to Mortgage | Plot No. 7 (1 Plot) | Total Area : Acers/0.25 Cts. or (101.73 Sqmts.) |
| Plot Area to Mortgage | Plot No. 8 (1 Plot) | Total Area : Acers/0.25 Cts. or (101.73 Sqmts.) |
| Plot Area to Mortgage | Plot No. 9 (1 Plot) | Total Area : Acers/0.25 Cts. or (101.73 Sqmts.) |
| Plot Area to Mortgage | Plot No. 10 (1 Plot) | Total Area : Acers/0.25 Cts. or (101.73 Sqmts.) |
| Plot Area to Mortgage | Plot No. 11 (1 Plot) | Total Area : Acers/0.25 Cts. or (101.73 Sqmts.) |
| Plot Area to Mortgage | Plot No. 12 (1 Plot) | Total Area : Acers/0.25 Cts. or (101.73 Sqmts.) |
| Plot Area to Mortgage | Plot No. 13 (1 Plot) | Total Area : Acers/0.25 Cts. or (101.73 Sqmts.) |
| Plot Area to Mortgage | Plot No. 14 (1 Plot) | Total Area : Acers/0.25 Cts. or (101.73 Sqmts.) |
| Plot Area to Mortgage | Plot No. 15 (1 Plot) | Total Area : Acers/0.25 Cts. or (101.73 Sqmts.) |

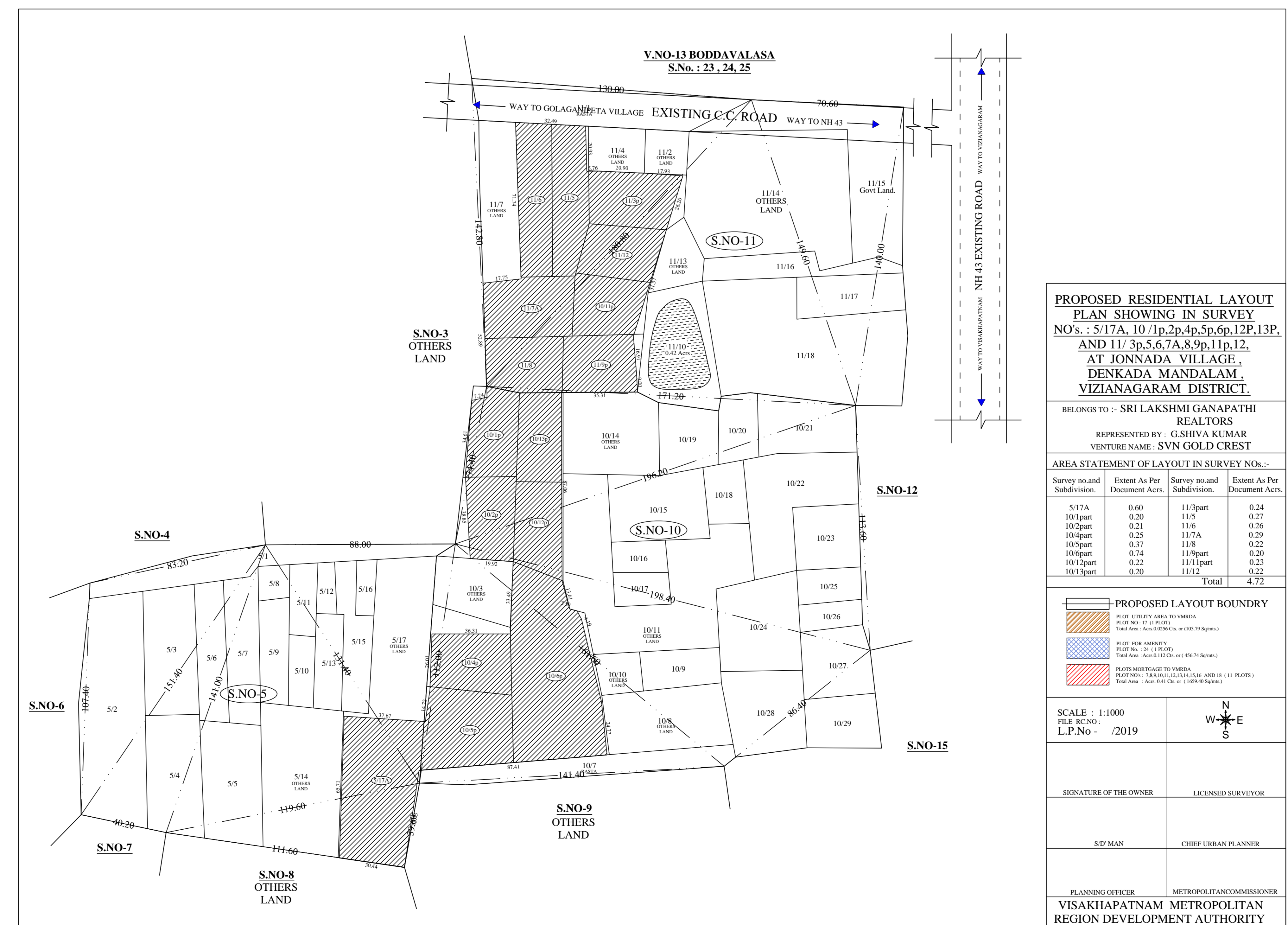

PROPOSED RESIDENTIAL LAYOUT PLAN SHOWING IN SURVEY NO'S: 5/17A, 10/1p,2p,4p,5p,6p,12p,13p, AND 11/ 3p,5,6,7A,8,9p,11p,12, AT JONNADA VILLAGE, DENKADA MANDALAM, VIZIANAGARAM DISTRICT.
 BELONGS TO : SRI LAKSHMI GANAPATHI REALTORS
 REPRESENTED BY : G.SHIVA KUMAR VENTURE NAME : SVN GOLD CREST

LEGEND
 - PROPOSED LAYOUT BOUNDARY
 - RESIDENTIAL USE
 - COMMERCIAL USE
 - WATER BODIES
 - OPEN SPACE & PARKS

SCALE 1 : 1000

SIGNATURE OF THE OWNER

LICENSED SURVEYOR

VISAKHAPATNAM METROPOLITAN REGION DEVELOPMENT AUTHORITY

