

**PLAN SHOWING THE PROPOSED
LAYOUT IN SURVEY NO.34/1P OF
GUDEPUVALASA VILLAGE
BHOGAPURAM MANDAL
VIZIANAGARAM DISTRICT**

SITE BELONGS TO :-

M/s. P.S. RAO HOUSING & RESORTS Pvt. Ltd.
Sri PERLA SRINIVASA RAO (Managing Director)

LAND USE ANALYSIS

Sl.No.	Description :	Extent Ac. Cts.	Percentage
1.	Plotted Area	2.2736	58.92
2.	Road Area	1.1900	30.82
3.	Openspace Are	0.3964	10.26
Total		3.86	100.00

PLOT DETAILS

Sl.No.	SIZE OF THE PLOT	AREA OF PLOT (Sq.Yds.)	NO. OF PLOTS
1.	30'0" X 60'0"	200.00	30
2.	30'0" X 55'0"	183.33	07
3.	30'0" X 50'0"	166.67	15
4.	18'0" X 45'0"	90.00	12

TOTAL PLOTS

64

SCALE 1" - 66'

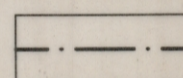

LAYOUT BOUNDARY

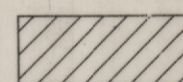

PLOTS MORTGAGED TO VUDA, PLOT NO.S 1 TO 6 & 13 TO 16.
TOTAL PLOTS: 10 NO.S
EXTENT : Acs 0.35 Cts.

FILE R.C. No: 5313/2013/L8

L.P.No. 53/2013

Ch.V.S.K.N. Soma Raju
CH.V.S.K.N. SOMA RAJU
Licenced Civil Engineer, VUDA
Registration No.019/2012-2015
VISA KHAPATNAM
Cell: 9840335115
LICENSED SURVEYOR.

OWNER'S SIGNATURE

PLANNING OFFICER - II

R. Prady
A.D.M
26/8/13

CHIEF URBAN PLANNER

V. Narayana
Jr. PLANNING OFFICER
26/8/13

VICE CHAIRMAN

**VISAKHAPATNAM URBAN
DEVELOPMENT AUTHORITY**

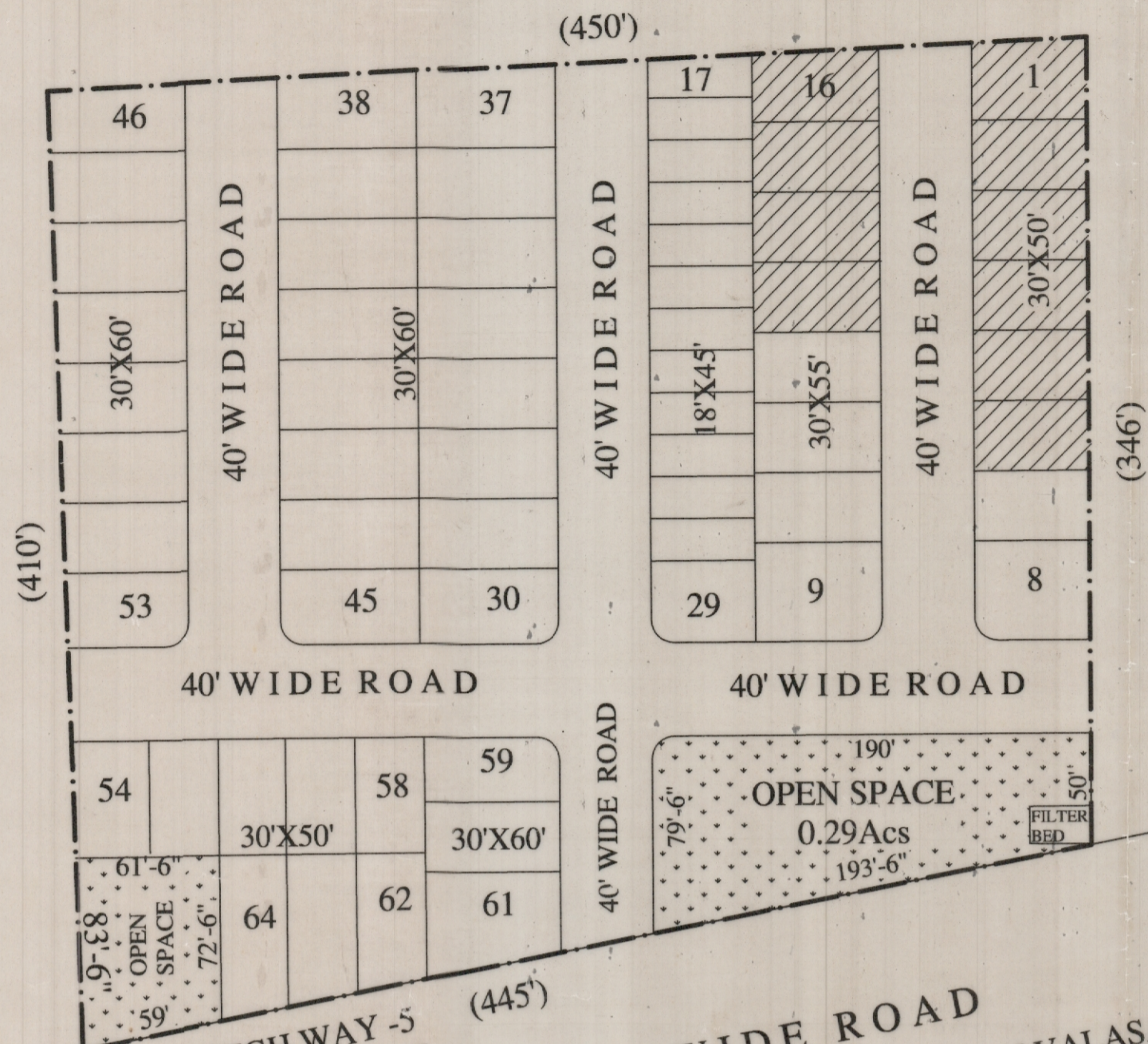

**EXISTING
VUDA
APPROVED
LAYOUT
L.P.No.27/2013**

LAYOUT PLAN

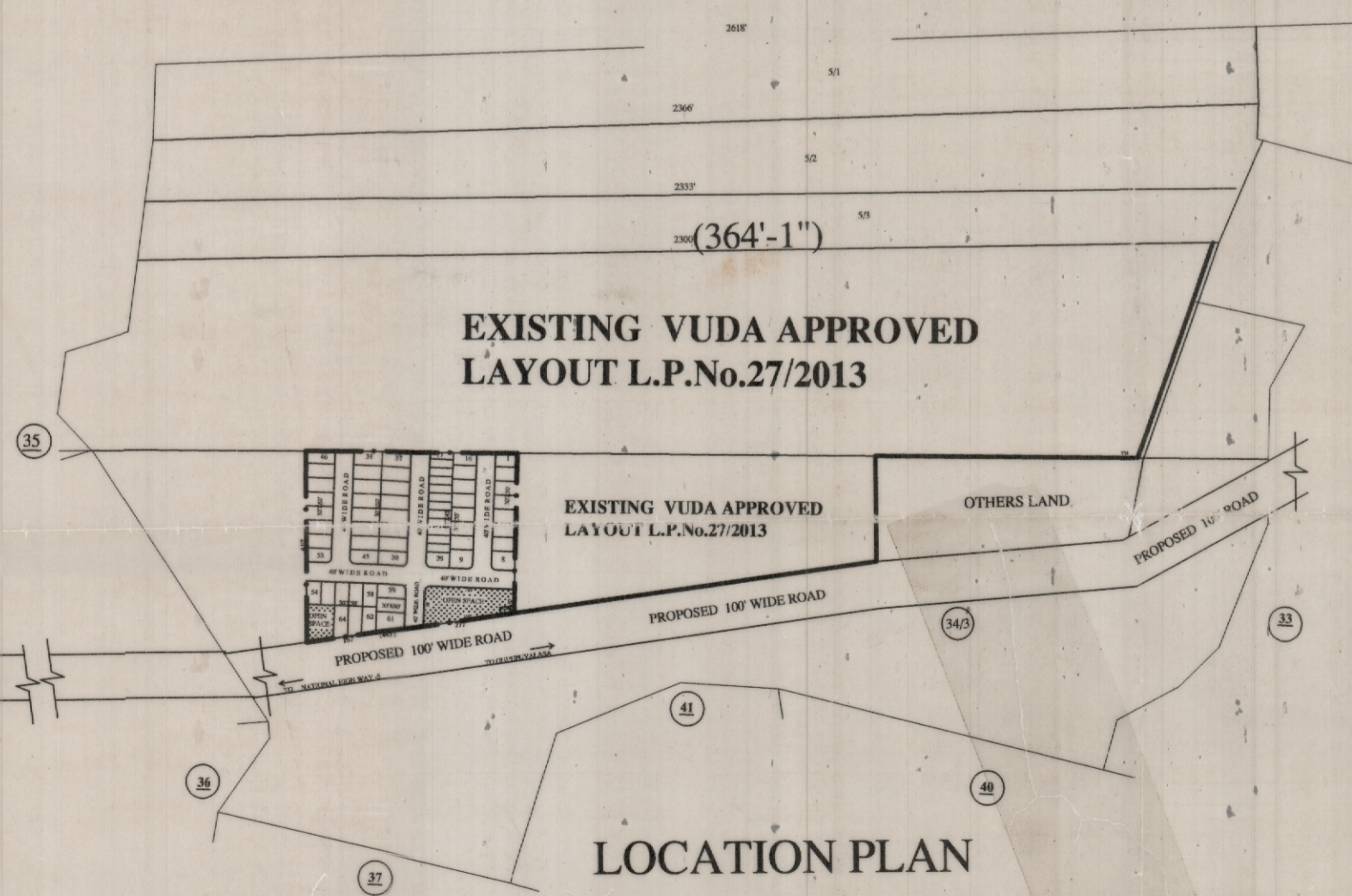

LOCATION PLAN