

PROPOSED LAYOUT IN S.NOS - 108/p,
110/p & 111/p AT MADHURAWADA VILLAGE,
CHINAGADILA MANDAL,
VISAKHAPATNAM DISTRICT.

TOTAL EXTENT : ac 16.77cts

LAND USE ANALYSIS FOR ac16.77 LAYOUT

Sl.No	Description	Extent in Acs-cts	Percentage
1.	PLOTTED AREA	9.51	56.71
	COMMERCIAL AREA	1.13	6.74
2.	ROADS AREA	4.45	26.53
3.	OPEN SPACE	1.68	10.02
	TOTAL	16.77	100.00

Plot Details

Sl.No	SIZE	EXTENT	NOS
1.	75'-0"X120'-0"	1000.00 Sq.ds	9
2.	75'-0" X 100'-0"	833.33 Sq.yds	7
3.	50'-0"X 90'-0"	500.00 Sq.yds	30
4.	45'-0" X 60'-0"	300.00 Sq.yds	27
5.	30'-0" X 50'-0"	167.66 Sq.yds	21
	TOTAL		94

— PROPOSED LAYOUT BOUNDARY

SCALE : 1" = 132'
FILE R.C.NO : 7039/04/L,
L.P.NO : 39/2008
This Revised - 42/08



Ch. Kamala Devi

A.D.M

Junior. planning officer

[Signature]
Asst. planning officer

[Signature]
Planning officer

[Signature]

Estate officer

[Signature]
Secretary

[Signature]
Chief Urban Planner

[Signature]
VICE - CHAIRMAN

VISAKHAPATNAM URBAN
DEVELOPMENT AUTHORITY

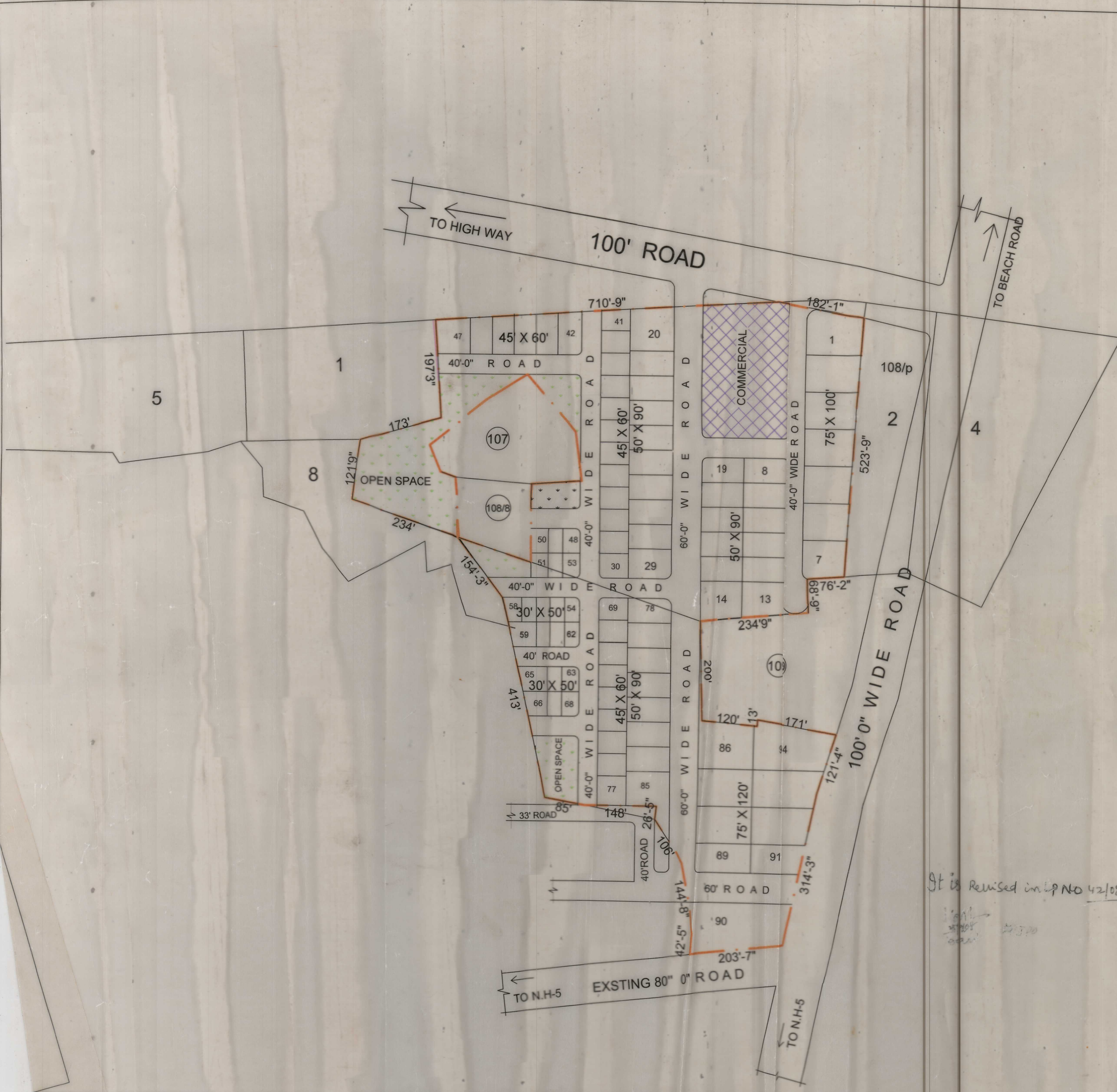

It is Revised in L.P NO 42/08