

| Plot No | Abutting Road | Plot Area | Plot Width | Plot Depth | Fronting |
|---------|---------------------------|-----------|------------|------------|----------|
| 1 | 12M PROPOSED ROAD-1 | 100.00 | 294.51 | 8.00 | 12.76 |
| 2 | 12M PROPOSED ROAD-1 | 100.00 | 243.46 | 8.00 | 12.19 |
| 3 | 12M PROPOSED ROAD-1 | 100.00 | 241.98 | 8.00 | 12.19 |
| 4 | 12M PROPOSED ROAD-1 | 100.00 | 235.85 | 8.00 | 12.19 |
| 5 | 12M PROPOSED ROAD-1 | 100.00 | 369.47 | 8.00 | 21.29 |
| 6 | 12M PROPOSED ROAD-1 | 100.00 | 303.78 | 8.00 | 16.76 |
| 7 | 12M PROPOSED ROAD-1 | 100.00 | 416.96 | 8.00 | 27.55 |
| 8 | 12M PROPOSED ROAD-2 | 100.00 | 237.45 | 8.00 | 11.69 |
| 9 | 12M PROPOSED ROAD-1 | 100.00 | 218.30 | 8.00 | 15.24 |
| 10 | 12M PROPOSED ROAD-2 | 100.00 | 143.55 | 8.00 | 9.95 |
| 11 | 12M WIDE PROPOSED ROAD-3 | 100.00 | 190.52 | 8.00 | 12.96 |
| 12 | 12M WIDE PROPOSED ROAD-3 | 100.00 | 239.90 | 8.00 | 12.19 |
| 13 | 12M WIDE PROPOSED ROAD-3 | 100.00 | 169.93 | 8.00 | 9.14 |
| 14 | 12M WIDE PROPOSED ROAD-3 | 100.00 | 161.34 | 8.00 | 9.14 |
| 15 | 12M WIDE PROPOSED ROAD-3 | 100.00 | 152.75 | 8.00 | 9.14 |
| 16 | 12M WIDE PROPOSED ROAD-3 | 100.00 | 144.16 | 8.00 | 9.14 |
| 17 | 12M WIDE PROPOSED ROAD-3 | 100.00 | 135.57 | 8.00 | 9.14 |
| 22 | 12M WIDE PROPOSED ROAD-10 | 100.00 | 447.95 | 8.00 | 21.61 |
| 23 | 12M WIDE PROPOSED ROAD-10 | 100.00 | 303.54 | 8.00 | 24.90 |
| 24 | 12M WIDE PROPOSED ROAD-10 | 100.00 | 304.99 | 8.00 | 25.02 |
| 25 | 12M WIDE PROPOSED ROAD-10 | 100.00 | 306.44 | 8.00 | 25.13 |
| 26 | 12M WIDE PROPOSED ROAD-10 | 100.00 | 307.88 | 8.00 | 25.25 |
| 27 | 12M WIDE PROPOSED ROAD-10 | 100.00 | 309.33 | 8.00 | 25.37 |
| 28 | 12M WIDE PROPOSED ROAD-10 | 100.00 | 310.78 | 8.00 | 25.49 |
| 29 | 12M WIDE PROPOSED ROAD-10 | 100.00 | 312.22 | 8.00 | 25.61 |
| 30 | 12M WIDE PROPOSED ROAD-10 | 100.00 | 311.08 | 8.00 | 25.73 |
| 31 | 12M WIDE PROPOSED ROAD-10 | 100.00 | 335.11 | 8.00 | 23.13 |
| 32 | 12M WIDE PROPOSED ROAD-10 | 100.00 | 277.45 | 8.00 | 22.76 |
| 33 | 12M WIDE PROPOSED ROAD-10 | 100.00 | 273.16 | 8.00 | 22.41 |
| 34 | 12M WIDE PROPOSED ROAD-10 | 100.00 | 268.88 | 8.00 | 22.05 |
| 35 | 12M WIDE PROPOSED ROAD-10 | 100.00 | 264.60 | 8.00 | 21.70 |
| 36 | 12M WIDE PROPOSED ROAD-10 | 100.00 | 260.32 | 8.00 | 21.35 |
| 37 | 12M WIDE PROPOSED ROAD-10 | 100.00 | 281.20 | 8.00 | 20.98 |
| 38 | 12M WIDE PROPOSED ROAD-10 | 100.00 | 207.57 | 8.00 | 13.62 |
| 39 | 12M WIDE PROPOSED ROAD-10 | 100.00 | 227.61 | 8.00 | 15.24 |
| 40 | 12M ROAD | 100.00 | 227.61 | 8.00 | 15.24 |
| 41 | 12M ROAD | 100.00 | 204.73 | 8.00 | 13.03 |
| 42 | 12M ROAD | 100.00 | 203.58 | 8.00 | 13.82 |
| 43 | 12M ROAD | 100.00 | 204.40 | 8.00 | 13.72 |
| 44 | 12M WIDE PROPOSED ROAD-10 | 100.00 | 246.19 | 8.00 | 13.72 |
| 45 | 12M WIDE PROPOSED ROAD-6 | 100.00 | 225.71 | 8.00 | 11.79 |
| 46 | 12M WIDE PROPOSED ROAD-6 | 100.00 | 184.36 | 8.00 | 12.57 |
| 47 | 12M WIDE PROPOSED ROAD-6 | 100.00 | 190.84 | 8.00 | 15.65 |
| 48 | 12M WIDE PROPOSED ROAD-6 | 100.00 | 196.24 | 8.00 | 16.10 |
| 49 | 12M WIDE PROPOSED ROAD-6 | 100.00 | 201.64 | 8.00 | 16.54 |
| 50 | 12M WIDE PROPOSED ROAD-6 | 100.00 | 186.09 | 8.00 | 16.96 |
| 51 | 12M WIDE PROPOSED ROAD-6 | 100.00 | 190.46 | 8.00 | 17.36 |
| 52 | 12M WIDE PROPOSED ROAD-6 | 100.00 | 194.83 | 8.00 | 17.76 |
| 53 | 12M WIDE PROPOSED ROAD-6 | 100.00 | 199.20 | 8.00 | 18.15 |
| 54 | 12M WIDE PROPOSED ROAD-6 | 100.00 | 203.58 | 8.00 | 18.55 |
| 55 | 12M WIDE PROPOSED ROAD-6 | 100.00 | 307.80 | 8.00 | 16.15 |
| 56 | 12M WIDE PROPOSED ROAD-6 | 100.00 | 105.65 | 8.00 | 5.78 |
| 57 | 12M WIDE PROPOSED ROAD-6 | 100.00 | 269.13 | 8.00 | 15.63 |
| 58 | 12M WIDE PROPOSED ROAD-6 | 100.00 | 167.23 | 8.00 | 18.29 |
| 59 | 12M WIDE PROPOSED ROAD-6 | 100.00 | 167.23 | 8.00 | 18.29 |
| 60 | 12M WIDE PROPOSED ROAD-6 | 100.00 | 167.23 | 8.00 | 18.29 |
| 61 | 12M WIDE PROPOSED ROAD-6 | 100.00 | 167.23 | 8.00 | 18.29 |
| 62 | 12M WIDE PROPOSED ROAD-6 | 100.00 | 167.23 | 8.00 | 18.29 |
| 63 | 12M WIDE PROPOSED ROAD-6 | 100.00 | 167.23 | 8.00 | 18.29 |
| 64 | 12M WIDE PROPOSED ROAD-6 | 100.00 | 222.97 | 8.00 | 12.19 |
| 65 | 12M WIDE PROPOSED ROAD-8 | 100.00 | 286.22 | 8.00 | 15.24 |
| 66 | 12M WIDE PROPOSED ROAD-8 | 100.00 | 246.09 | 8.00 | 13.40 |
| 67 | 12M WIDE PROPOSED ROAD-8 | 100.00 | 185.82 | 8.00 | 12.19 |
| 68 | 12M WIDE PROPOSED ROAD-5 | 100.00 | 139.36 | 8.00 | 9.14 |
| 69 | 12M WIDE PROPOSED ROAD-5 | 100.00 | 139.36 | 8.00 | 9.14 |
| 70 | 12M WIDE PROPOSED ROAD-5 | 100.00 | 139.36 | 8.00 | 9.14 |
| 71 | 12M WIDE PROPOSED ROAD-5 | 100.00 | 139.36 | 8.00 | 9.14 |
| 72 | 12M WIDE PROPOSED ROAD-5 | 100.00 | 139.36 | 8.00 | 9.14 |
| 73 | 12M WIDE PROPOSED ROAD-5 | 100.00 | 139.36 | 8.00 | 9.14 |
| 74 | 12M WIDE PROPOSED ROAD-5 | 100.00 | 198.79 | 8.00 | 12.28 |
| 75 | 12M WIDE PROPOSED ROAD-5 | 100.00 | 139.35 | 8.00 | 9.14 |
| 76 | 12M WIDE PROPOSED ROAD-5 | 100.00 | 139.35 | 8.00 | 9.14 |
| 77 | 12M WIDE PROPOSED ROAD-5 | 100.00 | 139.35 | 8.00 | 9.14 |
| 78 | 12M WIDE PROPOSED ROAD-5 | 100.00 | 139.35 | 8.00 | 9.14 |
| 79 | 12M WIDE PROPOSED ROAD-5 | 100.00 | 139.35 | 8.00 | 9.14 |
| 80 | 12M WIDE PROPOSED ROAD-5 | 100.00 | 139.35 | 8.00 | 9.14 |
| 81 | 12M WIDE PROPOSED ROAD-5 | 100.00 | 185.81 | 8.00 | 12.19 |
| 82 | 12M WIDE PROPOSED ROAD-5 | 100.00 | 139.35 | 8.00 | 9.14 |
| 83 | 12M WIDE PROPOSED ROAD-5 | 100.00 | 191.15 | 8.00 | 12.19 |
| 84 | 12M WIDE PROPOSED ROAD-5 | 100.00 | 181.15 | 8.00 | 12.19 |
| 85 | 12M WIDE PROPOSED ROAD-4 | 100.00 | 139.35 | 8.00 | 9.14 |
| 86 | 12M WIDE PROPOSED ROAD-4 | 100.00 | 139.35 | 8.00 | 9.14 |
| 87 | 12M WIDE PROPOSED ROAD-4 | 100.00 | 185.81 | 8.00 | 12.19 |
| 88 | 12M WIDE PROPOSED ROAD-4 | 100.00 | 139.35 | 8.00 | 9.14 |
| 89 | 12M WIDE PROPOSED ROAD-4 | 100.00 | 139.35 | 8.00 | 9.14 |
| 90 | 12M WIDE PROPOSED ROAD-4 | 100.00 | 139.35 | 8.00 | 9.14 |
| 91 | 12M WIDE PROPOSED ROAD-4 | 100.00 | 139.35 | 8.00 | 9.14 |
| 92 | 12M WIDE PROPOSED ROAD-4 | 100.00 | 139.35 | 8.00 | 9.14 |
| 93 | 12M WIDE PROPOSED ROAD-5 | 100.00 | 278.71 | 8.00 | 30.48 |
| 94 | 12M WIDE PROPOSED ROAD-5 | 100.00 | 278.71 | 8.00 | 30.48 |
| 95 | 12M WIDE PROPOSED ROAD-5 | 100.00 | 442.71 | 8.00 | 30.48 |

Land Area to Mortgage Details

| Name | Ind Plot Name | Ind Plot Area |
|----------------|---------------|---------------|
| MORTGAGE PLOTS | | |
| | 75 | 139.35 |
| | 76 | 139.35 |
| | 81 | 139.35 |
| | 82 | 139.35 |
| | 83 | 278.71 |
| | 84 | 278.71 |
| | 85 | 442.71 |
| MORTGAGE PLOTS | | |
| | 6 | 303.78 |
| | 7 | 416.96 |
| | 8 | 237.45 |
| | 9 | 218.30 |
| Total | | |
| | | 3103.52 |

Land Use Analysis/Classification (Table 20)

| Area covered under | Proposed Area in sq. mt. | Proposed Area in sq. yd. | Percentage(%) |
|--------------------|--------------------------|--------------------------|---------------|
| Ploated Area | 1936.08 | 2347.60 | 56.59 |
| Road Area | 1059.07 | 1289.54 | 30.43 |
| Amenity-19 | 110.38 | 253.78 | 0.43 |
| Amenity-15 | 175.04 | 299.34 | 0.50 |
| Amenity-21 | 197.84 | 238.62 | 0.57 |
| Amenity-30 | 191.92 | 229.54 | 0.55 |
| Public Open Space | 3891.61 | 4299.65 | 15.27 |
| Utility Area | 198.08 | 238.88 | 0.57 |
| Total net layout | 3489.01 | 4147.95 | 100.00 |

Mortgage Area Details

| Name | Mortgage Area |
|-----------------------|---------------|
| Land Area to Mortgage | 3103.52 |

General Conditions

| | |
|---|---|
| 1 | LTP is responsible for any misrepresentation in above details. |
| 2 | Spiky shall be maintained as per G.O.MS NO.119 MA & UD dt 27.03.2017 in all the road corners. |

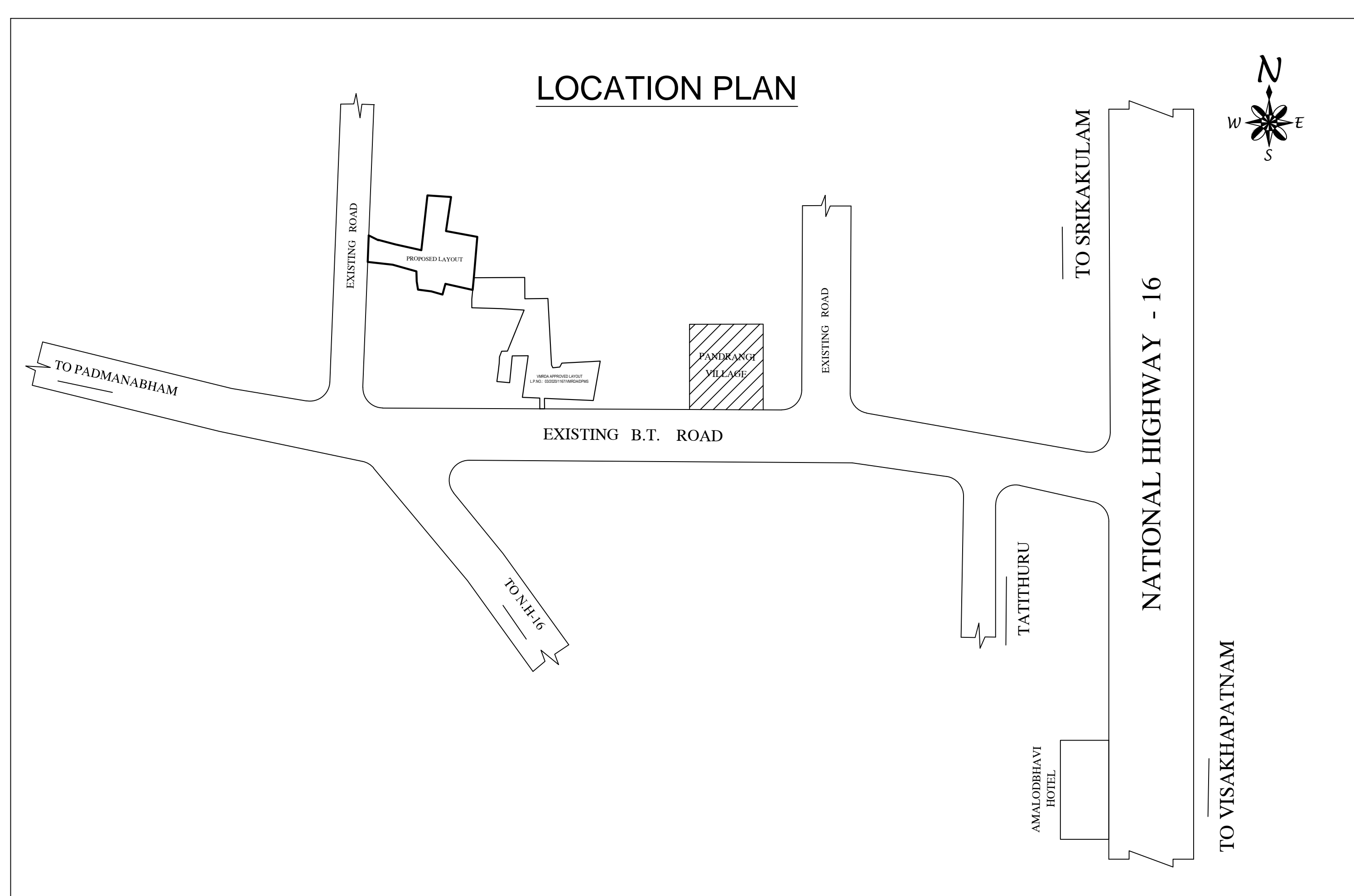
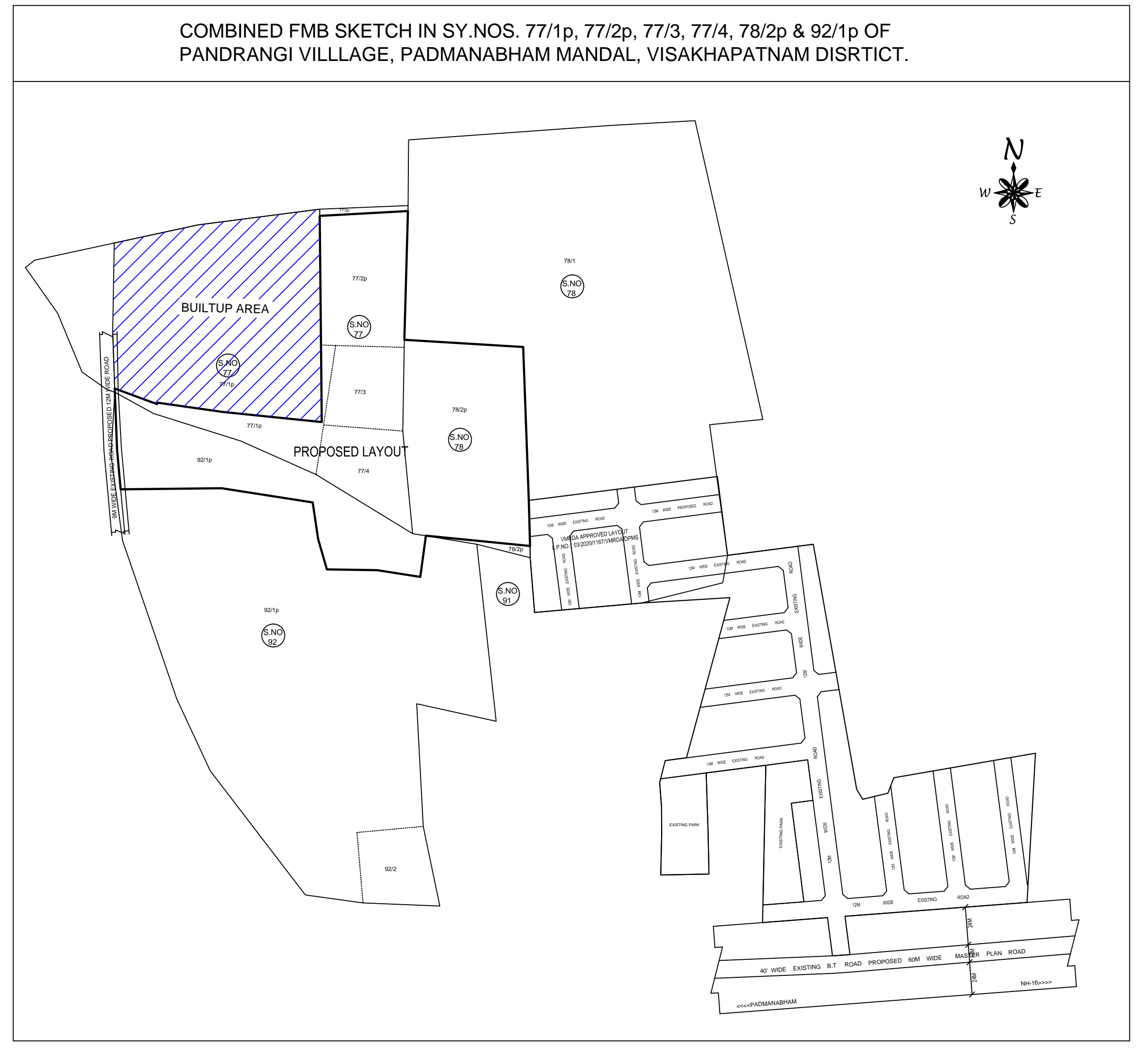
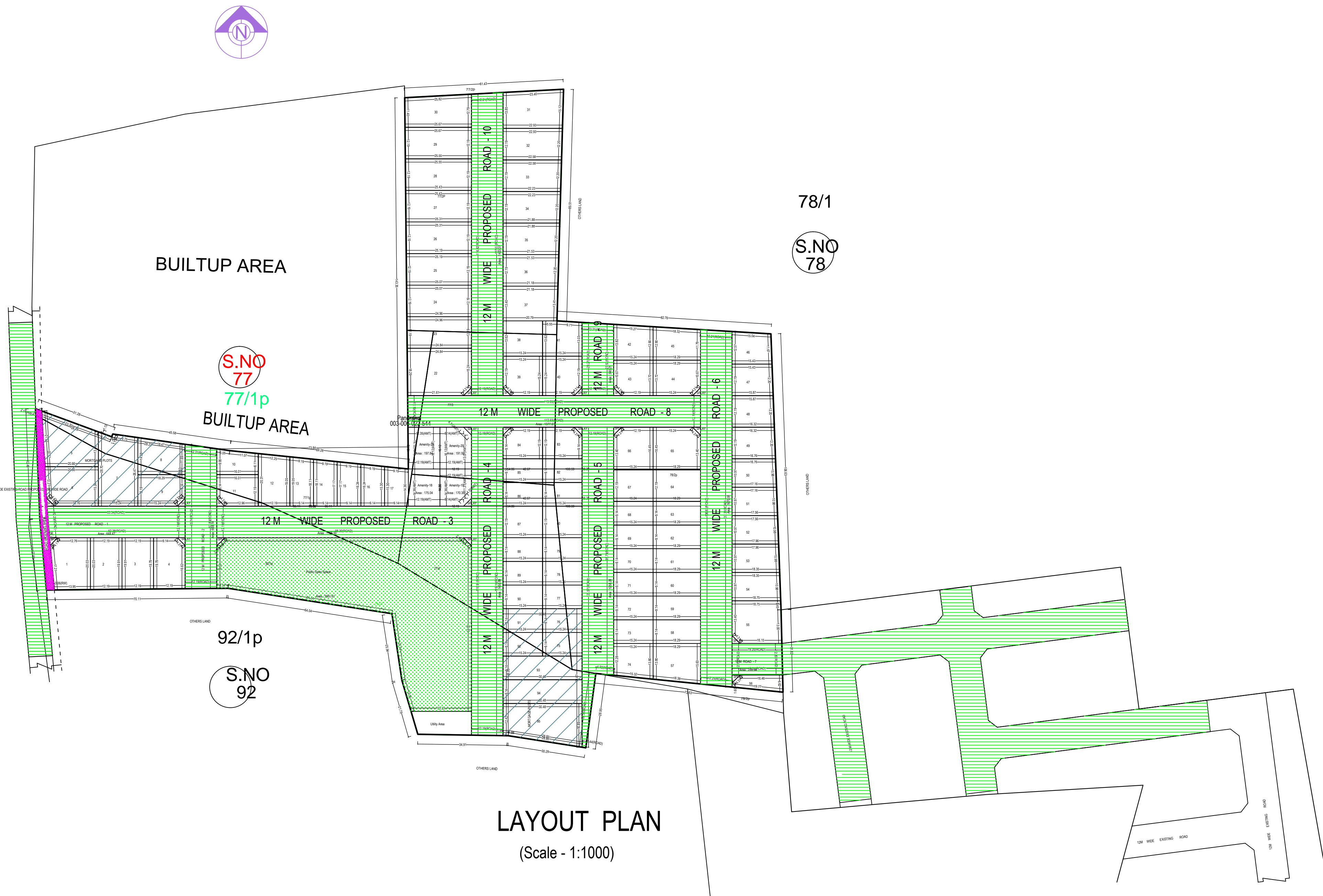

COLOR INDEX

| | |
|---|-----|
| Plot / Site lines | --- |
| Existing street / road | --- |
| Proposed work including services | --- |
| Existing construction proposed to be demolished | --- |
| Existing structure to be retained | --- |
| Work in progress duly sanctioned | --- |
| Open Space | --- |
| Drainage and Sewerage work | --- |
| Water Supply work | --- |
| Deviations | --- |
| Retained ground | --- |