

PROPOSED E.W.S LAYOUT IN
 S. NO. 332/2 OF VADA CHEEPURA
 PALLI (EAST) PARANADA MANDAL
 VISAKHAPATNAM DIST

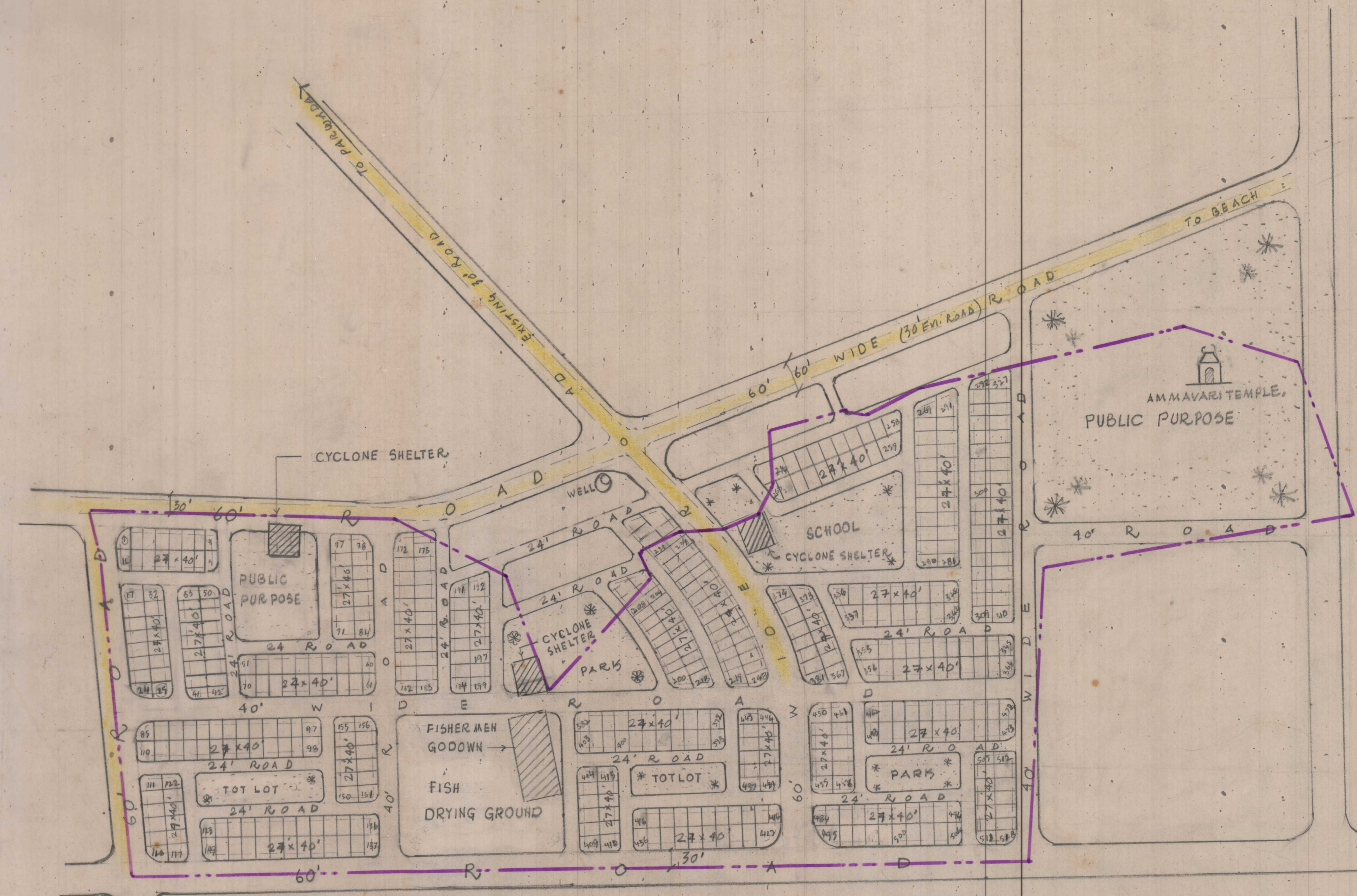

LANDUSE ANALYSIS

PLOTTED AREA, AC.	12.84	40.13%
ROADS AREA, AC.	8.75	27.34%
OPEN AREA, AC.	10.41	32.53%
TOTAL	32.00	100.00%

LAYOUT BOUNDARY
 TOTAL NO OF PLOTS 518 NOS
 SIZE OF THE PLOT : 27' x 40'

NOTE :- BUILDING LINE 10'

SCALE: 1" = 132'

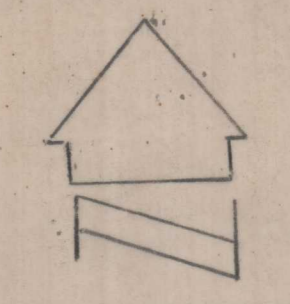

FILE R. NO. 30
 L.P. NO. 27/90

G. Sundar Rao
 Splgr. SURVEYOR

V. L. S. Reddy
 7/3/90
 Jr. PLANNING OFFICER

(Signature)
 CHIEF PLANNING OFFICER

A. Balan Rao
 17/3/90
 ASSISTANT PLANNING OFFICER

(Signature)
 VICE CHAIRMAN

VISAKHAPATNAM URBAN
 DEVELOPMENT AUTHORITY