

PLP NO:1167/0043/LP/VMRDA/2023	SHEET NO: 1	DATE: 03-07-2023
Project Title - Plan showing in Sy no 73P Of Aynada village, Padmanabham Mandal, Visakhapatnam District. Land belongs to Medapati Ramesh Reddy		
AREA STATEMENT	VERSION NO: 1.101.122	VERSION DATE: 16/06/2023
PROJECT DETAIL		
Region: VISAKHAPATNAM REGION	Plot Use: Residential	
Authority: VISAKHAPATNAM METROPOLITAN REGION DEVELOPMENT AUTHORITY	Land Use Zone: Residential use Zone	
PLP No: 1167/0043/LP/VMRDA/2023	Main Abutting Road Width: 12	
Application Type: General/Proposal	If Plot is abutting to Highway: No	
Project Type: Open Layout	Plot No: NA	
Nature of Development: New	Survey No: 73C, 73P2, 73P-B, 73P1, 73P	
Sub-location: NA	North: -	
Village Name: Aynada	South: -	
Mandal: PAD	East: -	
Ward: Aynada	West: -	
AREA DETAILS:		
AREA OF PLOT (Minimum)	(A)	13093.23
NET AREA OF PLOT	(A-Deductions)	13093.23
Deduction for Balance Plot Area		
Amenity Area		372.94
Total		372.94
BALANCE AREA OF PLOT	(A-Deductions)	12720.29
LTP NAME AND SIGNATURE	STRUCTURAL ENG NAME AND SIGNATURE	BUILDER NAME AND SIGNATURE
Y. Jhansi Rani		MEDAPATI RAMESH REDDY
06/2019/22		REG1167/DEV/0043/2023

Land use analysis/Area distribution (Table 2c)			
Area covered under	Proposed Area in sq. mt.	Proposed Area in sq. yd.	Percentage(%)
Plotted Area	7504.96	8975.86	57.32
Road Area	3840.24	4502.89	29.33
Amenity PLOT NO.38	372.94	446.03	2.83
Public Open Space	1309.50	1566.15	10.00
Utility Area	65.60	78.48	0.50
Total net layout	13093.24	15669.38	100.00

Land Area to Mortgage Details		
Name	Ind Plot Name	Ind Plot Area
Land Area to Mortgage	31	260.03
	32	187.81
	33	190.84
	34	163.78
	35	196.69
	36	181.36
	37	148.91
Total	-	1380.42

Mortgage Area Details		
Name	Rept	Mortgage Area
Land Area to Mortgage	1123.74	1380.42

General Conditions	
No.	General Conditions
1	LTP is responsible for any misrepresentation in above spaces.
2	Survey shall be maintained as per GO MS No.275, MA & UD dt. 18-07-2017 in all the road corners.

Individual Plot Area									
Plot No.	Abutting Road	Plot Area		Plot Width		Plot Depth		Frontage	
		Rept	Prop	Rept	Prop	Rept	Prop	Rept	Prop
1	12 MTRS INTERNALROAD-1	100.00	230.92	8.00	10.48	-	18.29	-	10.48
2	12 MTRS INTERNALROAD-1	100.00	167.19	8.00	9.14	-	18.29	-	9.14
3	12 MTRS INTERNALROAD-1	100.00	167.19	8.00	9.14	-	18.29	-	9.14
4	12 MTRS INTERNALROAD-1	100.00	278.81	8.00	15.24	-	18.29	-	15.24
5	12 MTRS INTERNALROAD-2	100.00	278.81	8.00	15.25	-	18.29	-	15.25
6	12 MTRS INTERNALROAD-2	100.00	167.19	8.00	9.14	-	18.29	-	9.14
7	12 MTRS INTERNALROAD-2	100.00	167.19	8.00	9.14	-	18.29	-	9.14
8	12 MTRS INTERNALROAD-2	100.00	329.29	8.00	20.72	-	18.29	-	20.72
9	12 MTRS INTERNALROAD-2	100.00	326.76	8.00	15.04	-	18.29	-	15.04
10	12 MTRS INTERNALROAD-2	100.00	167.19	8.00	9.14	-	18.29	-	9.14
11	12 MTRS INTERNALROAD-2	100.00	167.19	8.00	9.14	-	18.29	-	9.14
12	12 MTRS INTERNALROAD-2	100.00	167.19	8.00	9.14	-	18.29	-	9.14
13	12 MTRS INTERNALROAD-2	100.00	278.89	8.00	15.25	-	18.29	-	15.25
14	12 MTRS INTERNALROAD-3	100.00	278.82	8.00	15.24	-	18.29	-	15.24
15	12 MTRS INTERNALROAD-3	100.00	167.19	8.00	9.14	-	18.29	-	9.14
16	12 MTRS INTERNALROAD-3	100.00	167.19	8.00	9.14	-	18.29	-	9.14
17	12 MTRS INTERNALROAD-3	100.00	167.19	8.00	9.14	-	18.29	-	9.14
18	12 MTRS INTERNALROAD-3	100.00	167.19	8.00	9.14	-	18.29	-	9.14
19	12 MTRS INTERNALROAD-3	100.00	241.27	8.00	15.54	-	18.29	-	15.54
20	12 MTRS INTERNALROAD-3	100.00	281.85	8.00	15.20	-	0.00	-	15.20
21	12 MTRS INTERNALROAD-3	100.00	153.26	8.00	9.14	-	0.00	-	9.14
22	12 MTRS INTERNALROAD-3	100.00	153.26	8.00	9.14	-	0.00	-	9.14
23	12 MTRS INTERNALROAD-3	100.00	153.26	8.00	9.14	-	16.76	-	9.14
24	12 MTRS INTERNALROAD-3	100.00	251.05	8.00	13.76	-	15.24	-	12.24
25	12 MTRS INTERNALROAD-4	100.00	251.05	8.00	13.76	-	15.24	-	12.24
26	12 MTRS INTERNALROAD-4	100.00	153.26	8.00	9.14	-	16.76	-	9.14
27	12 MTRS INTERNALROAD-4	100.00	153.26	8.00	9.14	-	16.76	-	9.14
28	12 MTRS INTERNALROAD-4	100.00	153.26	8.00	9.14	-	16.76	-	9.14
29	12 MTRS INTERNALROAD-4	100.00	153.26	8.00	9.14	-	16.76	-	9.14
30	12 MTRS INTERNALROAD-4	100.00	185.06	8.00	12.22	-	16.76	-	12.22
31	12 MTRS INTERNALROAD-4	100.00	280.03	8.00	13.21	-	20.14	-	13.21
32	12 MTRS INTERNALROAD-4	100.00	187.81	8.00	9.14	-	20.54	-	9.14
33	12 MTRS INTERNALROAD-4	100.00	190.84	8.00	9.14	-	20.87	-	9.14
34	12 MTRS INTERNALROAD-4	100.00	193.78	8.00	9.14	-	21.19	-	9.14
35	12 MTRS INTERNALROAD-4	100.00	196.69	8.00	9.14	-	21.51	-	9.14
36	12 MTRS INTERNALROAD-4	100.00	181.36	8.00	12.24	-	12.19	-	12.24
37	12 MTRS INTERNALROAD-5	100.00	148.91	8.00	10.20	-	15.24	-	10.20

OWNERSHIP STATEMENT			
Land In Sy. No.	Extent As Per Adangal	Doc. Extent	Proposed Extent
73-C	2.5275	1.14	1.052
73P2	10.15	1.315	1.315
73P-B	2.23	0.73	0.73
73P1	0.73	0.09	0.09
73P	0.048	0.048	0.048
TOTAL	15.686	3.323	3.235

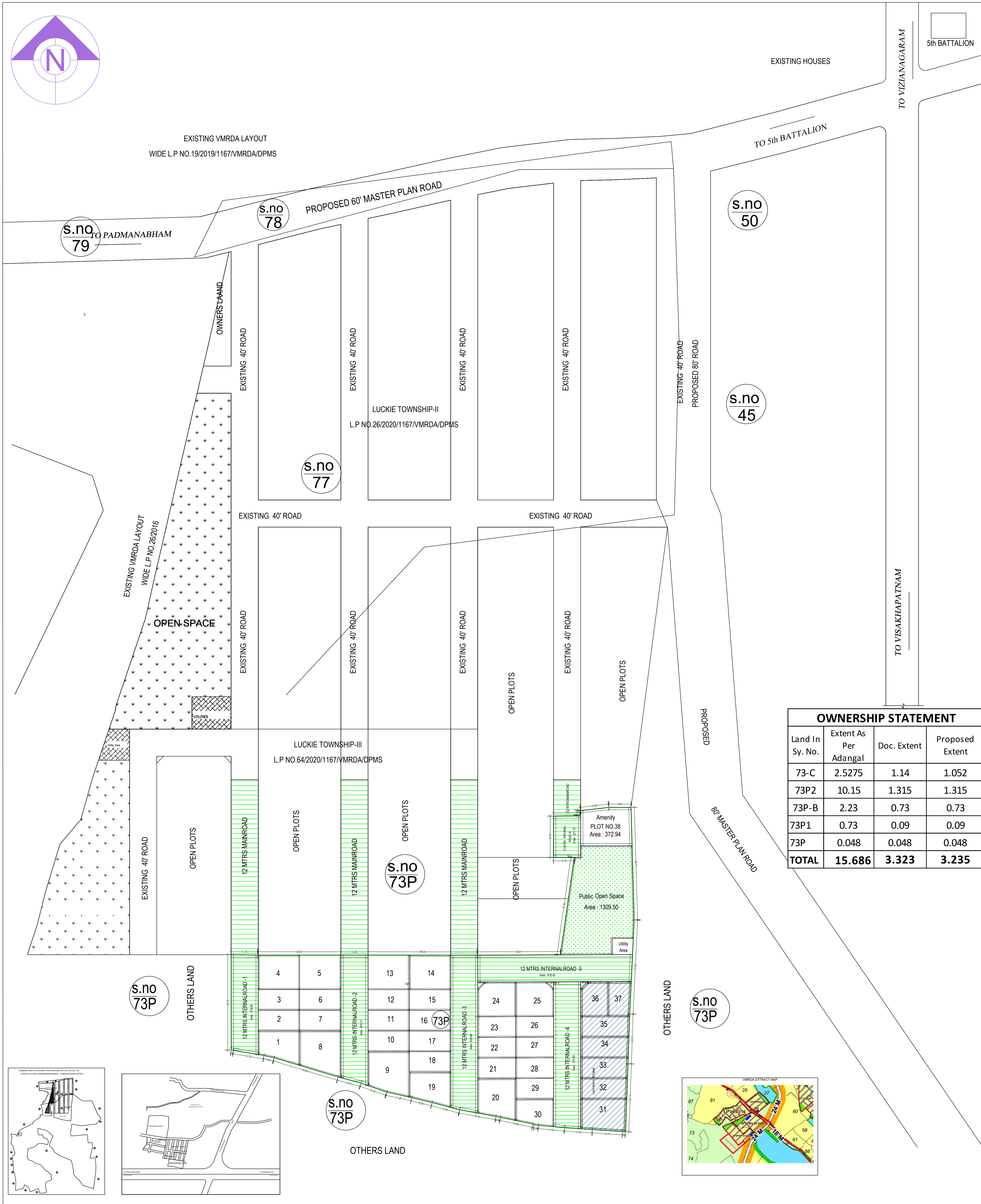

SITE PLAN
(Scale - 1:800)

COLOR INDEX	
	Plot / Site lines
	Existing street / road
	Proposed work including services
	Existing construction proposed to be demolished
	Existing structure to be retained
	Work in progress duly sanctioned
	Open Space
	Drainage and Sewerage work
	Water Supply work
	Deviations
	Recreation ground