

Plot No.	Plot Area	Plot Width	Plot Depth	Frontage
1	100.00	203.90	8.00	16.40
2	100.00	158.09	8.00	17.29
3	100.00	160.16	8.00	17.55
4	100.00	156.19	8.00	17.08
5	100.00	151.92	8.00	16.61
6	100.00	147.65	8.00	16.15
7	100.00	143.38	8.00	15.68
8	100.00	139.11	8.00	15.21
9	100.00	134.84	8.00	14.75
10	100.00	130.57	8.00	14.28
11	100.00	126.30	8.00	13.81
12	100.00	106.84	8.00	13.36
13	100.00	157.14	8.00	15.24
14	100.00	139.35	8.00	15.24
15	100.00	139.35	8.00	15.24
16	100.00	139.35	8.00	15.24
17	100.00	139.35	8.00	15.24
18	100.00	139.35	8.00	15.24
19	100.00	139.35	8.00	15.24
20	100.00	139.35	8.00	15.24
21	100.00	139.35	8.00	15.24
22	100.00	139.35	8.00	15.24
23	100.00	139.35	8.00	15.24
24	100.00	139.35	8.00	15.24
25	100.00	139.35	8.00	15.24
26	100.00	139.35	8.00	15.24
27	100.00	139.35	8.00	15.24
28	100.00	139.35	8.00	15.24
29	100.00	139.35	8.00	15.24
30	100.00	139.35	8.00	15.24
31	100.00	139.35	8.00	15.24
32	100.00	139.35	8.00	15.24
33	100.00	139.35	8.00	15.24
34	100.00	139.35	8.00	15.24
35	100.00	139.35	8.00	15.24
36	100.00	178.24	8.00	12.39
37	100.00	139.35	8.00	15.24
38	100.00	139.35	8.00	15.24
39	100.00	139.35	8.00	15.24
40	100.00	139.35	8.00	15.24
41	100.00	139.35	8.00	15.24
42	100.00	139.35	8.00	15.24
43	100.00	139.35	8.00	15.24
44	100.00	209.03	8.00	13.72
45	100.00	209.03	8.00	13.72
46	100.00	139.35	8.00	15.24
47	100.00	139.35	8.00	15.24
48	100.00	139.35	8.00	15.24
49	100.00	139.35	8.00	15.24
50	100.00	139.35	8.00	15.24
51	100.00	267.52	8.00	13.36
52	100.00	149.68	8.00	12.18
53	100.00	162.58	8.00	10.67
54	100.00	152.90	8.00	16.72
55	100.00	127.07	8.00	13.90
56	100.00	128.66	8.00	12.42
57	100.00	185.81	8.00	12.19
58	100.00	157.94	8.00	10.36
59	100.00	139.35	8.00	15.24
60	100.00	139.35	8.00	15.24
61	100.00	139.35	8.00	15.24
62	100.00	150.11	8.00	15.24

Land use analysis/Area distribution (Table 2c)

Area covered under	Proposed Area in sq. mt.	Proposed Area in sq. yd.	Percentage(%)
Plot Area	897.08	1000.70	51.19
Road Area	972.51	6944.06	33.92
Amenity-25	185.81	222.22	1.97
Amenity-24	185.81	222.22	1.97
Green Belt Area	432.27	540.91	2.61
Public Open Space	1803.19	2156.60	10.40
Utility Area	110.83	132.31	0.64
Total	17331.27	20728.03	100.00

Land Area to Mortgage Details

Name	Ind Plot Name	Ind Plot Area
MORTGAGE PLOTS		
13		157.14
14		139.35
15		139.35
16		139.35
17		139.35
18		139.35
19		139.35
20		139.35
21		139.35
22		139.35
23		139.35
Total		1550.69

Mortgage Area Details

Name	Road	Mortgage Area	Plot
Land Area to Mortgage	1330.68		1550.69

General Conditions

- LTP is responsible for any misrepresentation in above aspects.
- Stipay shall be maintained as per GOMES No-275, MA & UD dt. 18-07-2017 in all the road corners.

AREA STATEMENT

Sy. No.	"Proposed Extent Sq.Mts."
46/1	930.81
46/2P	16400.47
<b>TOTAL</b>	<b>17331.28</b>

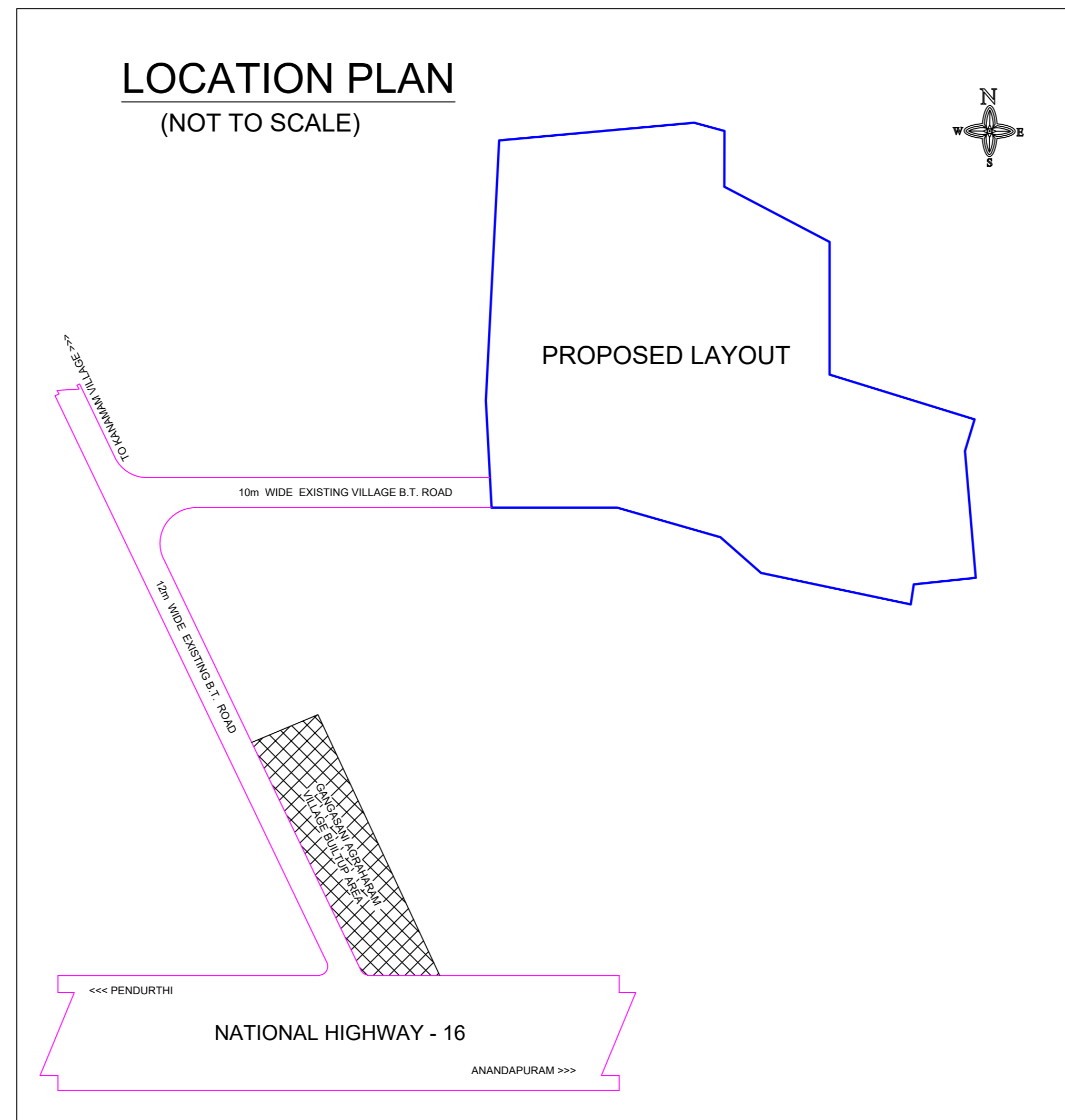
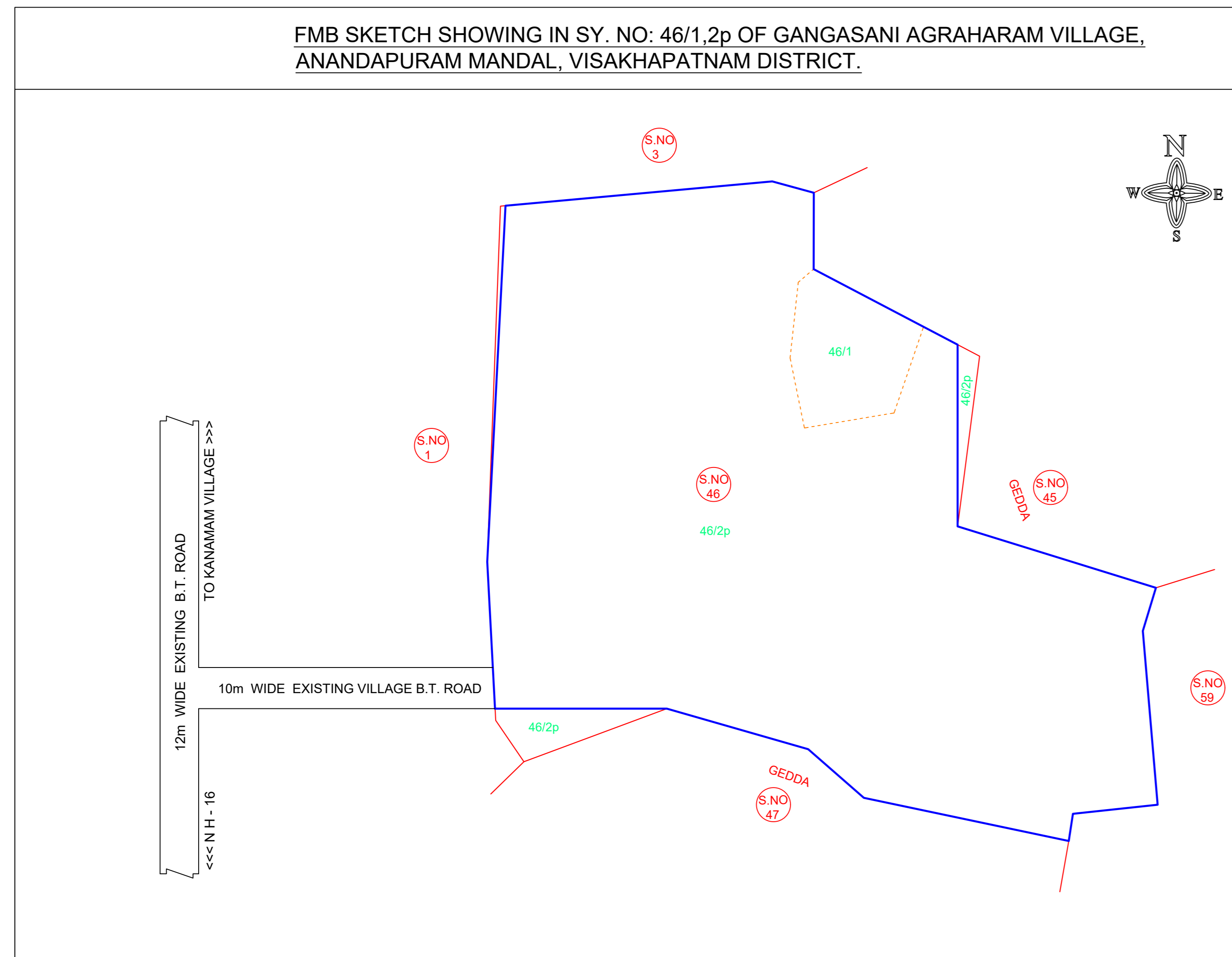

COLOR INDEX

- Plot / Site lines
- Existing street / road
- Proposed work including services
- Existing construction proposed to be demolished
- Existing structure to be retained
- Work in progress duty sanctioned
- Open Space
- Drainage and Sewerage work
- Water Supply work
- Deviations
- Retention ground