

Region	VISAKHAPATNAM REGION	Plot Use	Residential
Authority	VISAKHAPATNAM METROPOLITAN REGION DEVELOPMENT AUTHORITY	Land Use Zone	NA
TOP No.	1670/0015/LP/VMRDA/2021	Main Abutting Road Width	12
Application Type	General/Proposal	If Plot is abutting to Highway	No
Project Type	Open Layout	Plot No.	NA
Nature of Development	New	Survey No.	231/16 to 231/43
SubLocation NA	North -		
Village Name	Akkivaram	East -	
Mandir	GEN	West -	
AREA DETAILS			
AREA OF PLOT (Minimum)	(A)		1494.05
Deduction for Net/For Area			202.22
Let/Over/Owner/Land Area			1478.83
NET AREA OF PLOT	(A-Deductions)		1276.61
Deduction for Balance Plot Area			312.00
Amenity Area			202.22
Let/Over/Owner/Land Area			514.22
BALANCE AREA OF PLOT	(A-Deductions)		1442.83

LTP NAME AND SIGNATURE	STRUCTURAL ENGINE NAME AND SIGNATURE	BUILDER NAME AND SIGNATURE
V. Jagan Prasad		M/s. Swathi Promoters Pvt. Ltd
06/02/19/21		

Land use analysis/Area distribution (Table 2c)

Area covered under	Proposed Area in sq. mt.	Proposed Area in sq. yd.	Percentage(%)
Plotted Area	8590.88	10274.61	57.50
Let/Over/Owner's Land Area	202.22	241.85	1.35
Road Area	4345.27	5202.23	28.44
Amenity	312.00	373.15	2.09
Public Open Space	1507.68	1803.17	10.09
Utility Area	78.90	94.36	0.53
Total net layout	14941.05	17869.35	100.00

GramPanchayat Wise Land use analysis/Area distribution (Table 2e)

Area covered under	Proposed Area in sq. mt.	Proposed Area in sq. yd.	Percentage(%)
Plotted Area	8070.04	9651.69	56.23
Let/Over/Owner's Land Area	202.22	241.85	1.41
Road Area	4181.25	5000.73	29.13
Amenities	312.00	373.15	2.17
Public Open Space	1507.68	1803.17	10.09
Utility Area	78.90	94.36	0.55
Total net layout	14322.09	17164.96	100.00

Village Wise Land use analysis/Area distribution (Table 2d)

Area covered under	Proposed Area in sq. mt.	Proposed Area in sq. yd.	Percentage(%)
Plotted Area	530.85	622.93	88.44
Road Area	88.11	81.46	11.56
Total net layout	588.96	704.39	100.00

Land Area to Mortgage Details

Name	Ind Plot Name	Ind Plot Area
Land Area to Mortgage	40	349.66
	41	285.18
	42	294.23
	43	309.45
Total		1238.52

GramPanchayat wise Land Area to Mortgage Details

Name	Land Area to Mortgage Area
Akkivaram	1293.16
Total	1293.16

Village wise Land Area to Mortgage Details

Name	Land Area to Mortgage Area
Akkivaram	1293.16
Total	1293.16

Mortgage Area Details

Name	Mortgage Area
Land Area to Mortgage	1238.53
	1293.16

General Conditions

- LTP is responsible for any misrepresentation in above aspects.
- Spill shall be maintained as per G.O.M.S No.275, MA & LD dt. 18-07-2017 in all the road corners.

Plot No.	Abutting Road	Plot Area	Plot Width	Plot Depth	Frontage	Mortgage Area	Survey No.	Village	Area Falling in Village	Gram Panchayat	Area Falling in Gram Panchayat		
1	12 MTRS MAIN ROAD	100.00	139.36	8.00	24.39	-	9.14	-	33.00	Akkivaram	106.63	Akkivaram	105.63
2	12 MTRS MAIN ROAD	100.00	139.36	8.00	9.14	-	15.24	-	9.14	Bhogapuram	33.73	Bhogapuram	33.73
3	12 MTRS INTERNALROAD-3	100.00	235.15	8.00	15.43	-	15.24	-	15.24	Akkivaram	152.93	Akkivaram	152.93
4	12 MTRS MAIN ROAD	100.00	139.36	8.00	15.24	-	9.14	-	15.24	Akkivaram	94.99	Akkivaram	94.99
5	12 MTRS MAIN ROAD	100.00	139.36	8.00	9.14	-	15.24	-	9.14	Akkivaram	98.24	Akkivaram	98.24
6	12 MTRS MAIN ROAD	100.00	139.36	8.00	9.14	-	15.24	-	9.14	Akkivaram	101.98	Akkivaram	101.98
7	12 MTRS MAIN ROAD	100.00	139.36	8.00	9.14	-	15.24	-	9.14	Akkivaram	106.46	Akkivaram	106.46
8	12 MTRS MAIN ROAD	100.00	139.36	8.00	9.14	-	15.24	-	9.14	Akkivaram	110.14	Akkivaram	110.14
9	12 MTRS MAIN ROAD	100.00	139.36	8.00	9.14	-	15.24	-	9.14	Akkivaram	111.42	Akkivaram	111.42
10	12 MTRS MAIN ROAD	100.00	139.36	8.00	9.14	-	15.24	-	9.14	Akkivaram	102.61	Akkivaram	102.61
11	12 MTRS MAIN ROAD	100.00	218.85	8.00	14.15	-	15.24	-	14.15	Akkivaram	117.39	Akkivaram	117.39
12	12 MTRS INTERNALROAD-2	100.00	264.45	8.00	13.79	-	19.37	-	13.79	Akkivaram	264.45	Akkivaram	264.45
13	12 MTRS INTERNALROAD-2	100.00	210.13	8.00	13.66	-	15.24	-	13.66	Akkivaram	210.13	Akkivaram	210.13
14	12 MTRS INTERNALROAD-2	100.00	139.36	8.00	9.14	-	15.24	-	9.14	Akkivaram	139.36	Akkivaram	139.36
15	12 MTRS INTERNALROAD-2	100.00	139.36	8.00	9.14	-	15.24	-	9.14	Akkivaram	139.36	Akkivaram	139.36
16	12 MTRS INTERNALROAD-2	100.00	139.36	8.00	9.14	-	15.24	-	9.14	Akkivaram	139.36	Akkivaram	139.36
17	12 MTRS INTERNALROAD-2	100.00	139.36	8.00	9.14	-	15.24	-	9.14	Akkivaram	139.36	Akkivaram	139.36
18	12 MTRS INTERNALROAD-2	100.00	139.36	8.00	9.14	-	15.24	-	9.14	Akkivaram	139.36	Akkivaram	139.36
19	12 MTRS INTERNALROAD-2	100.00	139.36	8.00	9.14	-	15.24	-	9.14	Akkivaram	139.36	Akkivaram	139.36
20	12 MTRS INTERNALROAD-2	100.00	134.71	8.00	12.19	-	9.14	-	6.09	Akkivaram	134.71	Akkivaram	134.71
21	12 MTRS INTERNALROAD-3	100.00	230.50	8.00	12.38	-	15.24	-	12.19	Akkivaram	230.50	Akkivaram	230.50
22	12 MTRS INTERNALROAD-4	100.00	139.36	8.00	9.14	-	15.24	-	9.14	Akkivaram	139.36	Akkivaram	139.36
23	12 MTRS INTERNALROAD-4	100.00	139.36	8.00	15.24	-	9.14	-	9.14	Akkivaram	118.35	Akkivaram	118.35
24	12 MTRS INTERNALROAD-4	100.00	345.57	8.00	14.05	-	23.66	-	14.05	Akkivaram	345.57	Akkivaram	345.57
25	12 MTRS INTERNALROAD-3	100.00	162.47	8.00	15.22	-	9.14	-	6.07	Akkivaram	162.47	Akkivaram	162.47
26	12 MTRS INTERNALROAD-3	100.00	205.88	8.00	20.76	-	18.29	-	20.76	Akkivaram	325.88	Akkivaram	325.88
27	12 MTRS INTERNALROAD-3	100.00	259.69	8.00	14.76	-	18.29	-	14.76	Akkivaram	259.69	Akkivaram	259.69
28	12 MTRS INTERNALROAD-3	100.00	167.19	8.00	9.14	-	18.29	-	9.14	Akkivaram	167.19	Akkivaram	167.19
29	12 MTRS INTERNALROAD-2	100.00	162.54	8.00	15.24	-	9.14	-	15.24	Akkivaram	162.54	Akkivaram	162.54
30	12 MTRS INTERNALROAD-2	100.00	344.87	8.00	12.19	-	28.31	-	12.19	Akkivaram	344.87	Akkivaram	344.87
31	12 MTRS INTERNALROAD-2	100.00	298.29	8.00	12.19	-	24.33	-	12.19	Akkivaram	298.29	Akkivaram	298.29
32	12 MTRS INTERNALROAD-2	100.00	277.33	8.00	12.19	-	22.60	-	12.19	Akkivaram	277.33	Akkivaram	277.33
33	12 MTRS INTERNALROAD-2	100.00	253.75	8.00	12.19	-	20.88	-	12.19	Akkivaram	253.75	Akkivaram	253.75
34	12 MTRS INTERNALROAD-2	100.00	172.11	8.00	9.14	-	18.82	-	9.14	Akkivaram	172.11	Akkivaram	172.11
35	12 MTRS INTERNALROAD-2	100.00	163.33	8.00	9.14	-	17.80	-	9.14	Akkivaram	163.33	Akkivaram	163.33
36	12 MTRS INTERNALROAD-2	100.00	145.63	8.00	9.14	-	15.77	-	9.14	Akkivaram	145.63	Akkivaram	145.63
37	12 MTRS INTERNALROAD-2	100.00	157.84	8.00	9.14	-	17.25	-	9.14	Akkivaram	157.84	Akkivaram	157.84
38	12 MTRS INTERNALROAD-2	100.00	171.92	8.00	16.55	-	9.14	-	16.55	Akkivaram	171.92	Akkivaram	171.92
39	12 MTRS INTERNALROAD-1	100.00	236.03	8.00	15.69	-	18.57	-	15.69	Akkivaram	236.03	Akkivaram	236.03
40	12 MTRS INTERNALROAD-2	100.00	349.66	8.00	16.27	-	17.84	-	14.82	Akkivaram	349.66	Akkivaram	349.66
41	12 MTRS INTERNALROAD-2	100.00	285.18	8.00	12.21	-	23.43	-	285.18	Akkivaram	285.18	Akkivaram	285.18
42	12 MTRS INTERNALROAD-2	100.00	294.23	8.00	12.21	-	24.18	-	12.21	Akkivaram	294.23	Akkivaram	294.23
43	12 MTRS INTERNALROAD-2	100.00	359.45	8.00	14.44	-	24.99	-	14.44	Akkivaram	359.45	Akkivaram	359.45

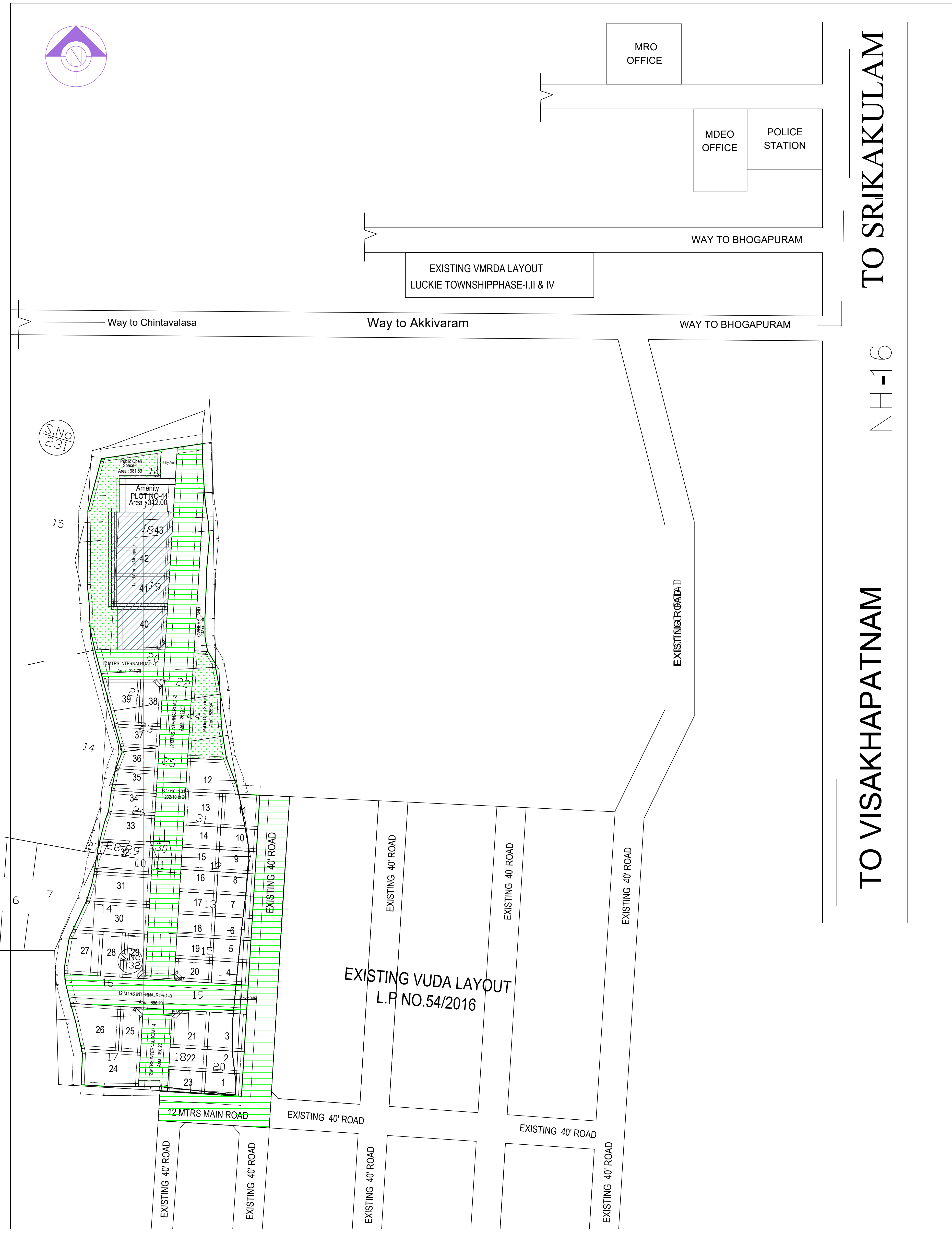

LAYOUT PLAN (Scale - 1:800)

TO SRIRAKKULAM  
NH-16

TO VISAKHAPATNAM

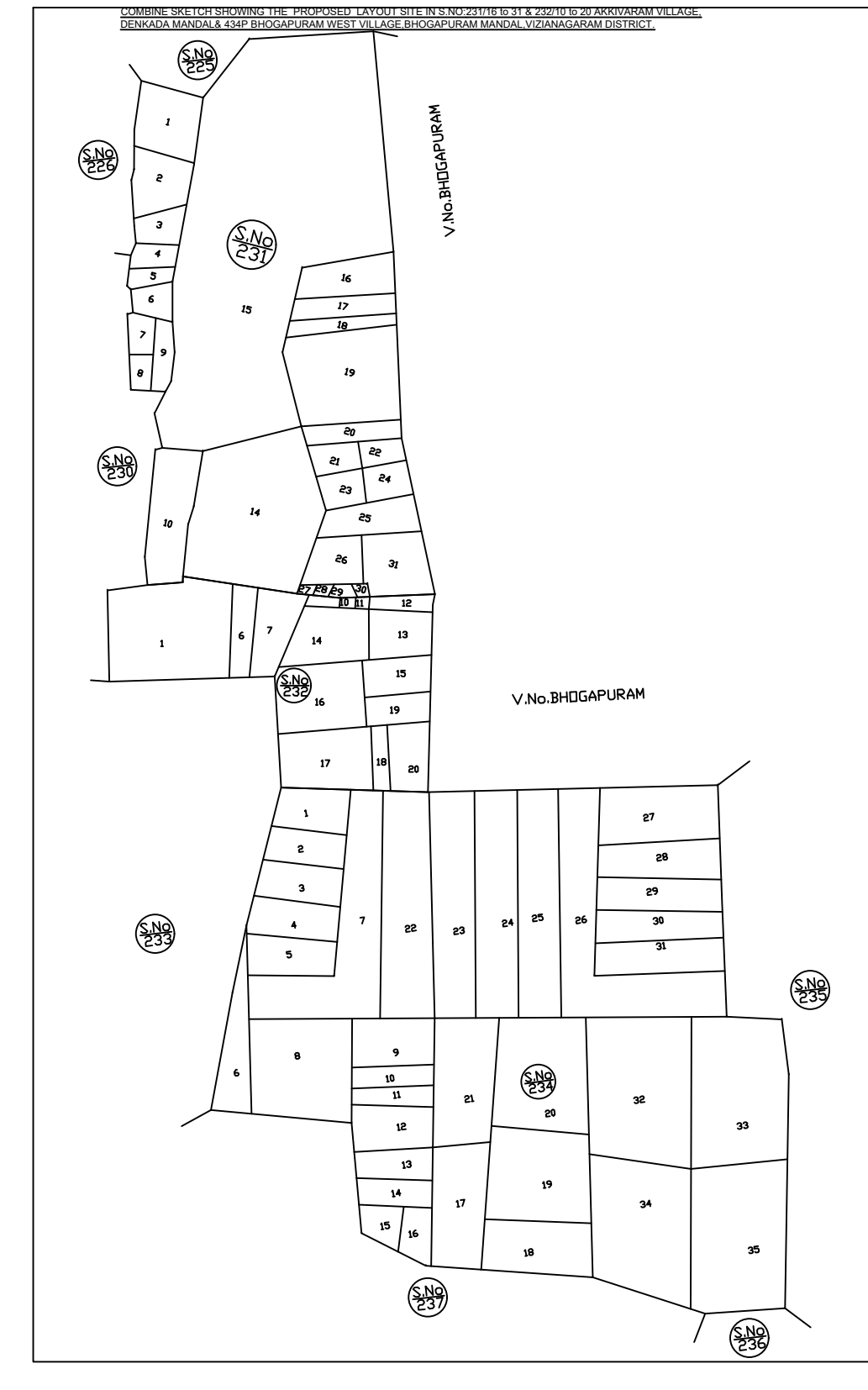
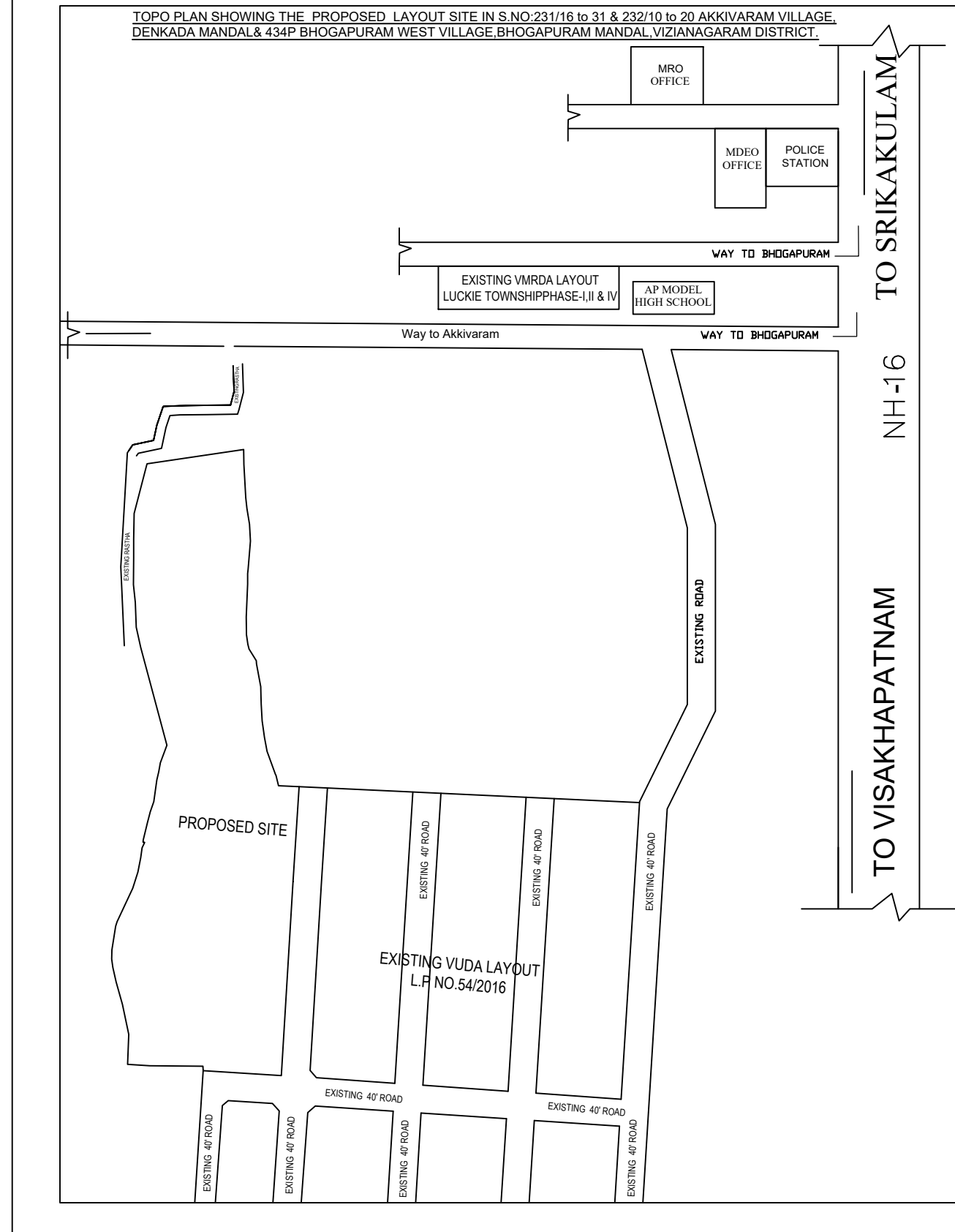
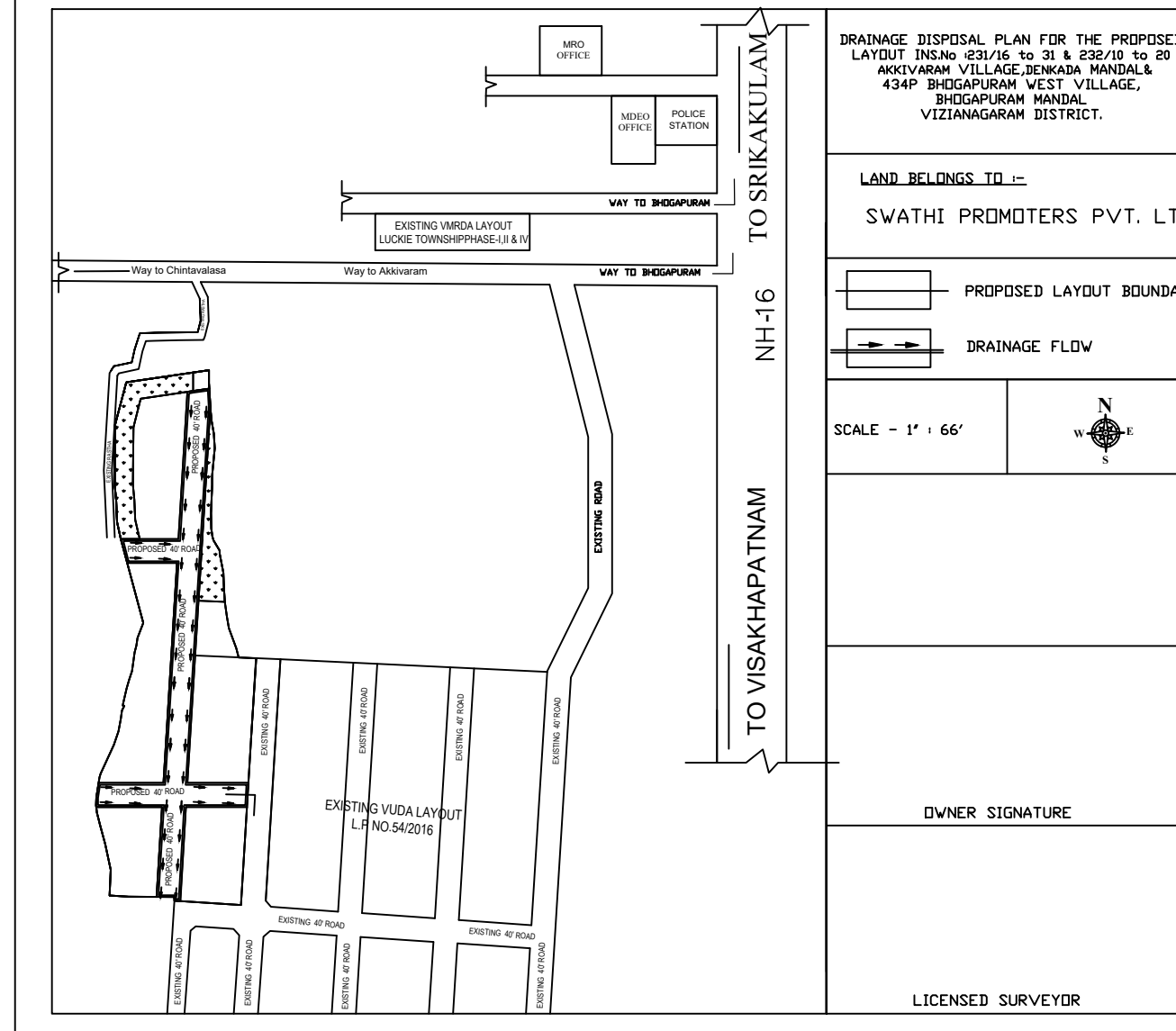

**COLOR INDEX**

- Plot / Site lines
- Existing street / road
- Proposed work including services
- Existing construction proposed to be demolished
- Existing structure to be retained
- Work in progress duly sanctioned
- Open Space
- Drainage and Sewerage work
- Water Supply work
- Deviations
- Restriction ground