

**PROPOSED LAYOUT PLAN FOR RESIDENTIAL PLOTS IN S.No: 32/6p,7p,9p &10p OF KAVULUVADA VILLAGE & IN S.No. 6/5p OF BASAVAPALEM VILLAGE, BHOGAPURAM MANDAL, VIZIANAGARAM DISTRICT.**

LAND BELONGS TO :-  
M/s. Raja Infra Projects Pvt. Ltd. & Others

**LAND USE ANALYSIS**

SL.NO.	DESCRIPTION	EXTENT	PERCENTAGE
1.	PLOTTED AREA	2.78	} 46.07 %
2.	MIXED LAND USE AREA	0.09	
3.	ROADS AREA	2.72	43.66 %
4.	OPEN SPACE	0.64	10.27 %
	<b>TOTAL AREA</b>	<b>6.23</b>	<b>100.00 %</b>

**PLOTS DETAILS**

SL. NO.	PLOT SIZE	PLOT AREA In Sq. Yds.	NO. OF PLOTS
1.	40' x 73'	324.44	04
2.	30' x 73'	243.33	01
3.	36' x 55'	220.00	05
4.	30' x 60'	200.00	13
5.	36' x 45'	180.00	11
6.	30' x 50'	166.66	22
7.	18' x 45'	90.00	22
	<b>TOTAL NO. OF PLOTS</b>		<b>78</b>

LAYOUT BOUNDARY

FILE RC.NO: 5381 / 2017 / L8

L.P.NO: 113/ 2018

SCALE :  
1" = 66'-0"

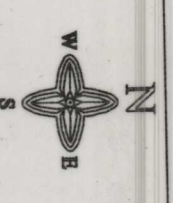

MIXED LAND USE



PLOTS MORTGAGED TO VUDA  
PLOT NOS: 38 TO 50  
EXTENT: AC 0.47 CTS  
NO OF PLOTS: 13

For Raja Infra Projects Pvt Ltd

Managing Director

*K. Srinivas Rao*  
K. Srinivas Rao  
G. Arivani

OWNERS SIGN.

*18Mgatu*  
S/D. MAN  
26/7/18

*Ramesh Babu*  
26/7/18  
Junior Planning Office

H. Lakshmi Narayana  
VUDA, Bangalore - 560076  
Vishakhapatnam Urban Development Auth. - 11/9  
VISA KHAPATNAM  
Ph. 7033144567

LICENSED SURVEYOR

Planning Officer

CHIEF URBAN PLANNING OFFICER

*Bansu*  
VICE CHAIRMAN  
VISA KHAPATNAM URBAN  
DEVELOPMENT AUTHORITY

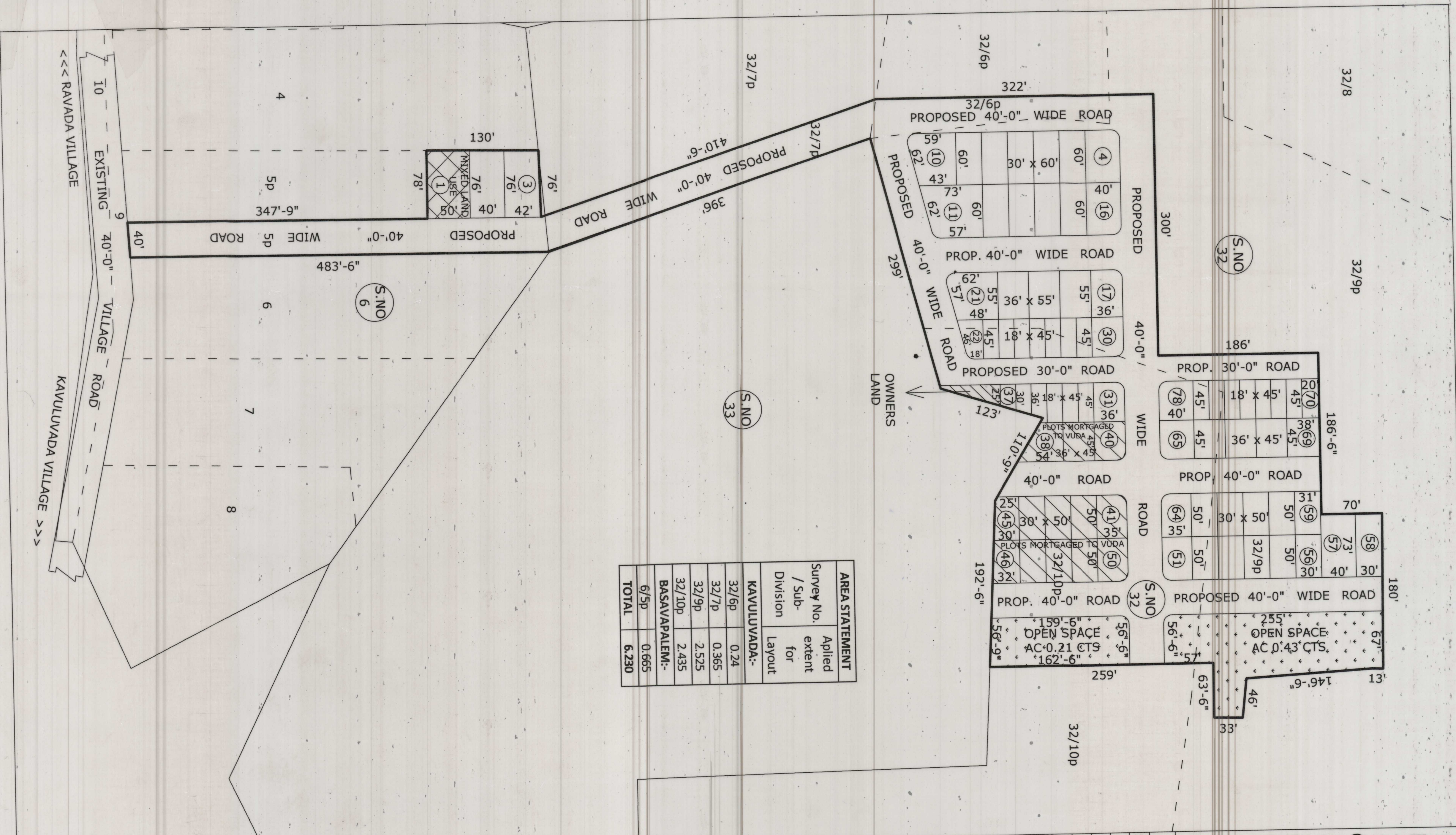

AREA STATEMENT	Survey No. / Sub-Division	Applied extent for Layout
	KAVULUVADA:-	
	32/6p	0.24
	32/7p	0.365
	32/9p	2.525
	32/10p	2.435
	BASAVAPALEM:-	
	6/5p	0.665
	<b>TOTAL</b>	<b>6.230</b>